



**SOLD**

## UNDER CONTRACT BY CLARISSA ALSOP

Be impressed by this lovely family home nestled away in a very quiet cul de sac location. This home offers a unique layout and the ability to cater for multi-generational living all under the one roof. The large 711 sqm block size will impress as will the extra-large, powered workshop.

- Set on a 711 sqm block
- Quiet cul de sac location
- Neat and tidy home with fully fenced front yard
- Roller shutters located to the front of the property
- Country style white kitchen with lots of storage, overhead cupboards and space for double fridge
- Open plan meals and family room with a skylight and ceiling fan
- Modern floating floors throughout
- Bed 4 is located to the rear of the property and is located in its own wing with a full-sized bathroom, a kitchenette / bar area and a large games room. This would be the ideal in law accommodation or perfect for a teenager retreat or potential for Airbnb. The fourth bedroom offers its own air conditioner and sliding door access to the patio area. The large games room area is ideal to use as an additional living area and also has roller shutters to most of the windows.
- This lovely home also offers two patios for entertaining
- Large, powered shed / workshop
- Close to parks, schools, shopping and transport links
- Minutes to beautiful beaches including Palm Beach

This is a great family home with all the essential ingredients including a very quiet location, security shutters, a versatile floorplan and option to cater for multi-generational living. The large, powered shed and spacious block size just add to the winning combination, and all of this is set in a beachside location with all amenities within easy reach.

**4 BED | 2 BATH | 2 CAR**

**PRICE:**  
**\$450,000**

**OPEN FOR INSPECTION:**  
**N/A**



**Clarissa Alsop**  
**0421827669**  
clarissa@atrealty.com.au  
[www.atrealty.com.au](http://www.atrealty.com.au)

# 4 Foley Place ROCKINGHAM



Block Size 711m<sup>2</sup> | 4 Bedrooms | 2 Bathrooms | 2 Car

Clarissa Alsop | 0421 827 669

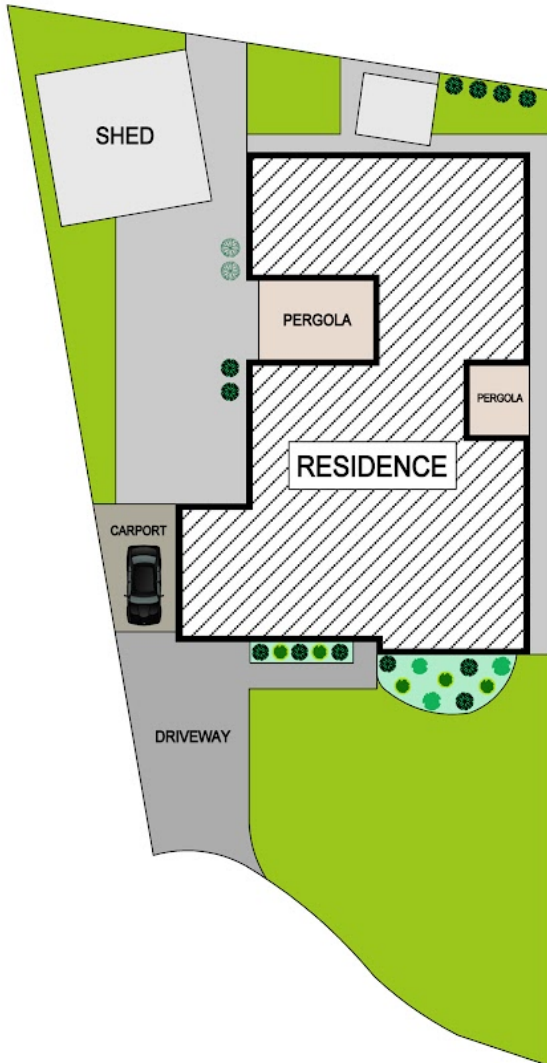

Disclaimer: Please note this floor plan is for marketing purposes and is to be used as a guide only. All dimensions are estimates only and may not be exact measurements.



REAL ESTATE FLOOR PLANS | [houseguru.com.au](http://houseguru.com.au) | © House Guru Real Estate Photography™

Whilst every attempt has been made to ensure the accuracy of the floor plan contained here, measurements of doors, windows, rooms and any other items are approximate and no responsibility is taken for error, omission or mis-statement. This plan is for illustrative purposes only and should only be used as such by any prospective purchaser. The services systems and appliances shown have not been tested and no guarantee as to their operability or efficiency can be given.

**Clarissa Alsop**  
0421827669  
[clarissa@atrealty.com.au](mailto:clarissa@atrealty.com.au)  
[www.atrealty.com.au](http://www.atrealty.com.au)

