



SOLD

INVESTOR CASH'S OUT...

This executive style home in the heart of Ormiston has now been given the opportunity to have new owners. Due to our investor being advised to sell, this now becomes your good fortune. With the current price of building and waiting on materials, you won't have to wait it has it all.

In the catchment for Ormiston college and walking distance to the local shops and train station, and with a park and water's edge at the end of your street, how good is this to call home.

Immaculately presented two storied home, with massive open plan and high ceilings design, your will be in the envy of your friends.

Fantastic family layout, with four large bedrooms upstairs and huge lounge area to join them all. Along with a large bedroom downstairs for the extra family member to live in you wanted/home office and two way bathroom for ease of access to your guest also, Plus don't forget about the massive media room.

Five bedrooms all with built ins
Two large living areas
Large Media room
Three bathrooms
In ground pool with outdoor built in BBQ and Caesar stone all round
Three car lock up with reverse garage door
603 sqm block

This property is currently tenanted at \$1,000.00 per week and it is a credit to the tenants how they present this beautiful home. This property will be taken to Auction on the 30th October at 11.30am Call Niki to discuss 0404 779 991.

5 BED | 3 BATH | 3 CAR

PRICE:
\$1,330,000

OPEN FOR INSPECTION:
N/A



Niki Stockham
0404779991
nikistockham@atrealty.com.au
www.atrealty.com.au

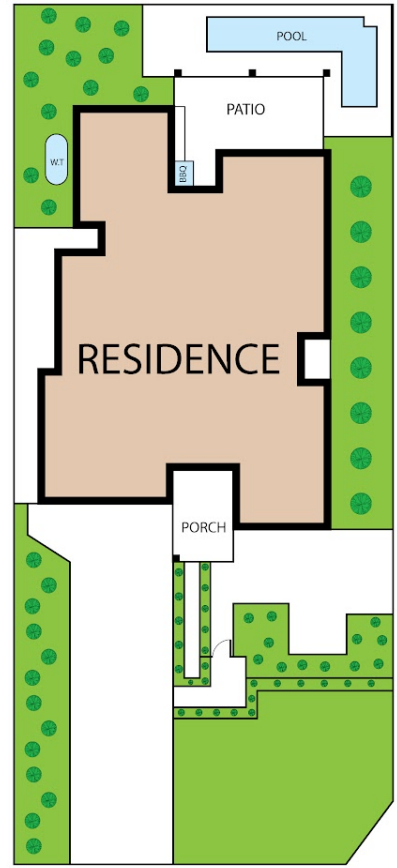

21 Beckwith Street, Ormiston 4160

Whilst every attempt has been made to ensure the accuracy of the floor plan contained here, measurements of doors, windows, rooms and any other items are approximate and no responsibility is taken for any error, omission, or misstatement. This plan is for illustrative purposes only and should be used as such by any prospective purchaser.

@realty

Disclaimer: Please note this floor plan is for marketing purposes and is to be used as a guide only. All dimensions are estimates only and may not be exact measurements.

Niki Stockham
0404779991
nikistockham@atrealty.com.au
www.atrealty.com.au

