

LOT 28 CHIKAMEENA STREET LOGAN RESERVE

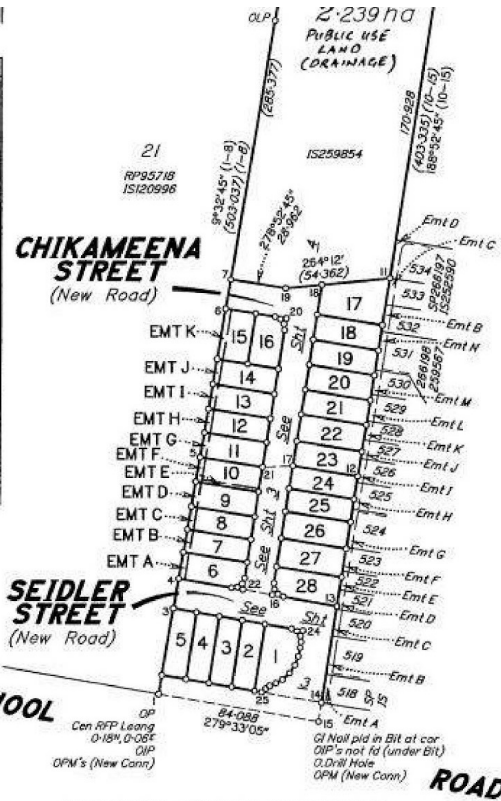

PM90477 to PM90481 | 279°26'07" | 279°26'09" |

REFERENCE MARKS				
STN	TO	ORIGIN	BEARING	DIST
1	OIP	3/15/20996	193°39'05"	0.964
2	Pin		139°44'	1.0
3	Screw in Kerb		54°57'	4.868
4	Screw in Kerb		146°48'30"	4.716
6	Screw in Manhole		50°09'	3.242
6	Screw in Kerb		75°48'15"	8.853
7	Screw in Kerb		133°21'	6.94
8	OIP	9/15/20996	11°17'05"	0.83
9	OIP	25/15/234471	35°25'30"	63.645
11	Pin		17°20'25"	36.128
13	Screw in Conc F/path		231°59'10"	10.347
14	Screw in Conc F/path		183°03'	1.63
14	Screw in Kerb		185°15'	5.676
15	OIP not fd (under Bit)	3/SP244341	180°45'25"	0.799
15	OIP not fd (under Bit)	4/15234471	103°14'05"	11.508
15	Screw in Conc F/path		177°01'25"	22.275
15	O.Drill Hole in Manhole	4/15234471	102°28'25"	26.109
16	Pin		44°40'	0.961
16	Screw in Conc F/path		230°09'	1.148
17	Screw in Kerb		232°23'	3.721
18	Pin		215°05'	1.04
18	Screw in Conc F/path		242°17'10"	11.467
19	Screw in Conc D/way		266°24'20"	11.815
20	Pin		62°23'	1.014
20	Screw in Kerb		48°41'30"	2.729
21	Screw in Channel		98°15'30"	4.158
22	Pin		329°54'	0.877
22	Screw in Conc Ramp		135°02'	1.693
23	Nail in Kerb		55°14'30"	4.914
24	Screw in Kerb		90°18'	1.946
25	Screw in Conc F/path		169°32'	1.2



Reinstatement Report

All original corners fixed by original survey marks and dimensions agree with 15259854.

Peg placed at all new corners unless otherwise stated.

FOR SALE

BUILD YOUR DREAM

Perfectly positioned between Brisbane's CBD and the Gold Coast, Logan Reserve really is in the middle of it all. Logan Reserve is a rural, residential suburb of Logan City, Queensland. An unbeatable location to match your chosen lifestyle, where convenience and affordability are key. Vacant land is rare and selling fast in this highly sought after area so call now to secure your dream home location!!!

- High speed fibre Broadband internet connected to each house site
- Safe walk to Logan Reserve Primary School, award winning Canterbury College and a choice of 6 public and primary schools only minutes away
- Conveniently located 10 minutes to Logan Hospital, Logan TAFE Campus and Griffith University Logan Campus
- Walk to Stoneleigh Park featuring BBQ, picnic tables, hike & bike trail and sports facilities
- A range of shopping centres only minutes away Waterford Plaza, Holmview Central, Hyperdome Shopping Centre & Grand Plaza Shopping Centre
- Close drive to M1 Pacific Highway, Mt Lindesay Highway & Logan Motorway

0 BED | 0 BATH | 0 CAR

PRICE:
\$235,000

OPEN FOR INSPECTION:
N/A



Roz Abrahams
0413070707
roz@atrealty.com.au
www.atrealty.com.au