



**SOLD**

## IMPRESSIVE LIFESTYLE DESIGN

Shining with the practicalities of modern style and streamlined sophistication, this spacious townhouse spans effortlessly from the indoors to the outside for enjoyable entertaining, a mere hop, skip and a jump from Sandown Station.

Impressive from the instant you step inside, the large living, dining and kitchen indulges the family with space and showcases the sleek elements of richly hued floorboards and high ceilings.

Ready to cater for the family, the kitchen itself is detailed with stainless steel appliances including a dishwasher, while sliding doors deliver an easy connection out to the covered, north-facing alfresco courtyard.

Promoting convenient, the ground floor includes a powder room and laundry, whereas the three robed bedrooms rest peacefully upstairs and feature new plush carpet, a master bedroom with walk-in-robe, built-in-robe and ensuite, plus a family bathroom with toilet.

Relishing no body corporate fees and superbly enhanced by ducted heating, evaporative cooling, split system air conditioning, alarm, garden shed, café blinds to alfresco zone, single garage with internal access plus a 2nd car space in the driveway.

Wonderfully situated, near Heatherhill Primary, Keysborough Secondary, Sandown Park Train Station, Noble Park Sports and Aquatic Centre, reserves, playgrounds, bike paths, shopping centres, Springvale community hub, South Eastern Private Hospital plus convenient access to Monash and EastLink Freeways.

Photo ID required at all open for inspections.

**3 BED | 2 BATH | 1 CAR**

**PRICE:**  
**\$690,000**

**OPEN FOR INSPECTION:**  
**N/A**



**Marko Ghattas**  
**0403170130**  
marko@atrealty.com.au  
[www.lucianorealty.com.au](http://www.lucianorealty.com.au)

# 2/21 Lawn Road NOBLE PARK

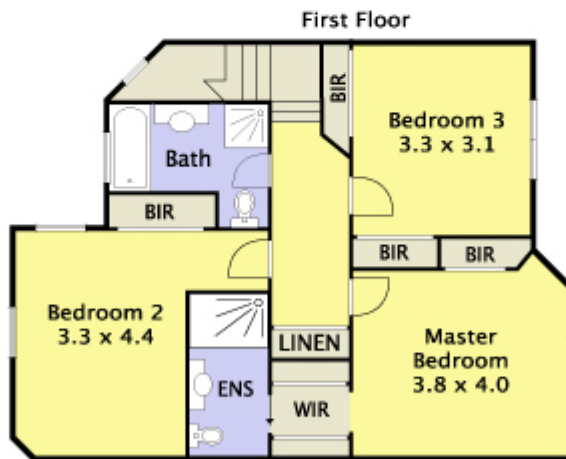
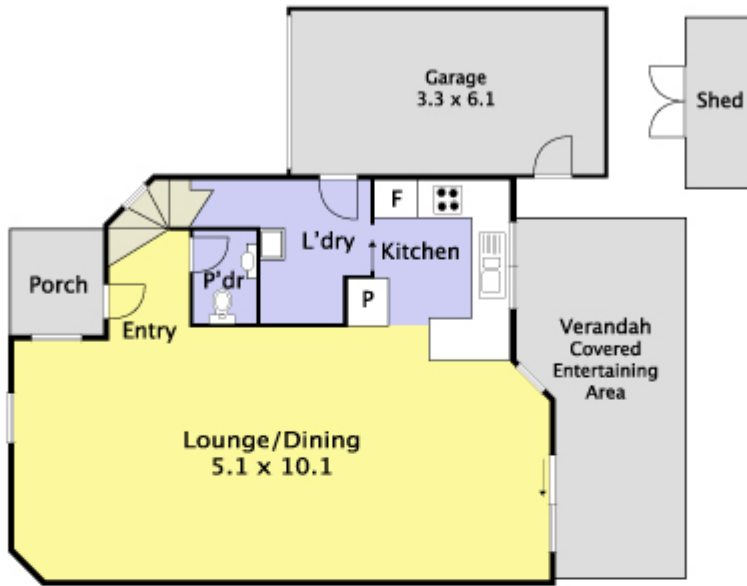

"While every precaution has been taken to verify this information, it does not constitute any representation by the agent or vendor".

Disclaimer: Please note this floor plan is for marketing purposes and is to be used as a guide only. All dimensions are estimates only and may not be exact measurements.