



FOR SALE

READY TO MOVE IN – GREAT FAMILY LIVING.

You could be in by Christmas! This beautiful established home offers buyers a wonderful opportunity to purchase a quality property. Boasting a generous and open floor plan with formal entry, open plan living area, spacious bedrooms, quality bathrooms and an abundance of natural light, you are sure to be impressed with this spacious family home which also has ducted heating and cooling.

The master bedroom features a walk-in robe with an ensuite bathroom. The additional bedrooms have built-in wardrobes. All have new carpet. The central bathroom has dual vanity sinks, a bath and a separate shower. A large open-plan kitchen with an island bench includes stainless steel appliances, a dishwasher, and generous storage spaces. Flowing into a well-proportioned family room and meals area. Double sliding doors provide access through to the undercover alfresco area, a separate deck area and low maintenance garden.

Feel secure knowing that the double remote garage has direct home access plus a rear door into the backyard. Small water tank for the gardens, and Security alarm system.

A 6.6 kw Solar panel system with a premium Fronius inverter will have your energy bills down to a minimum.

Enjoy the convenience of this location which is within a short distance to shops, cafes, leading brand shops, medical center schools and kinder.

This may be your perfect family home. Act now as it is ready for immediate occupancy. Astute investors should also inspect.

Contact Wayne to arrange a private inspection.

- 3 Bedroom
- Master with ensuite and walk-in robe
- Double car garage – Direct home access
- 6.6kw Solar panel system
- Great location
- 407m2 land

3 BED | 2 BATH | 2 CAR

PRICE:
\$595,000 - \$654,000

OPEN FOR INSPECTION:
N/A



Wayne Hutchinson
0424370940
wayne@waynehutchinson.com.au
waynehutchinson.com.au

57 Eliot Avenue, Doreen

WAYNE HUTCHINSON

@realty

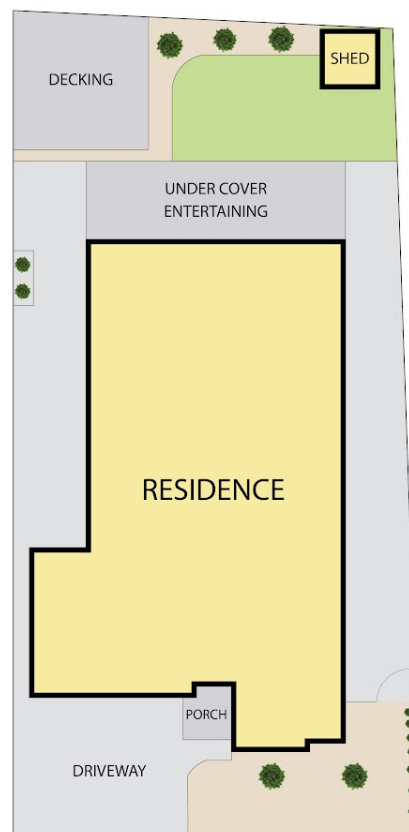

Please note this is a representation and whilst every precaution is taken to ensure we provide you with accurate information regarding this property, we recommend you obtain your own measurements and/or engage the services of a qualified surveyor should you require exact dimensions. We expressly deny any responsibility for any omissions contained herein.

Disclaimer: Please note this floor plan is for marketing purposes and is to be used as a guide only. All dimensions are estimates only and may not be exact measurements.