



SOLD

UNDER CONTRACT BY CLARISSA ALSOP

- Set on a 540 sqm block
- Built by Home Group WA in 2015
- Rendered façade with limestone wall frontage and low maintenance artificial lawn
- 197 sqm of internal living area and 242 sqm of total area
- 1200 wide feature entry door
- Ducted reverse cycle air conditioning
- Separate study
- Theatre room is the ideal place to watch a movie (theatre equipment is by negotiation)
- Activity room is in the kids wing of the home
- 31 Course ceilings to main living areas
- Kitchen with large walk-in pantry / scullery area set behind that is the ideal place to meal prep or store appliances
- Galley kitchen offers a large island bench
- Vinyl plank flooring throughout with skirting boards
- Master bedroom located to the rear of the property with walk-in robe and modern ensuite
- Minor bedrooms are all queen size and offer robes
- Laundry with lots of storage and built-in bench
- Low maintenance paved yard with artificial lawn to front
- Double car garage with internal access
- Double sized alfresco area is the ideal place to entertain
- Freshly painted throughout
- Roller shutters to front windows
- Walk to the gorgeous Quarry Park and amphitheatre
- Shopping and all amenities including freeway access within easy reach
- Minutes to future Lakelands train station due for completion 2023
- Easy care gardens
- Beaches, schools, parks and shopping are all available within minutes

This classy home and is ready for you to move straight in with nothing to do.

4 BED | 2 BATH | 2 CAR

PRICE:
\$479,000

OPEN FOR INSPECTION:
N/A



Clarissa Alsop
0421827669
clarissa@atrealty.com.au
www.atrealty.com.au

179 Pebblebeach Blvd MEADOW SPRINGS @realty

Block Size 540m² | 4 Bedrooms | 2 Bathrooms | 2 Car
Internal 197m² | External 71m² | Total 268m²

Clarissa Alsop | 0421 827 669

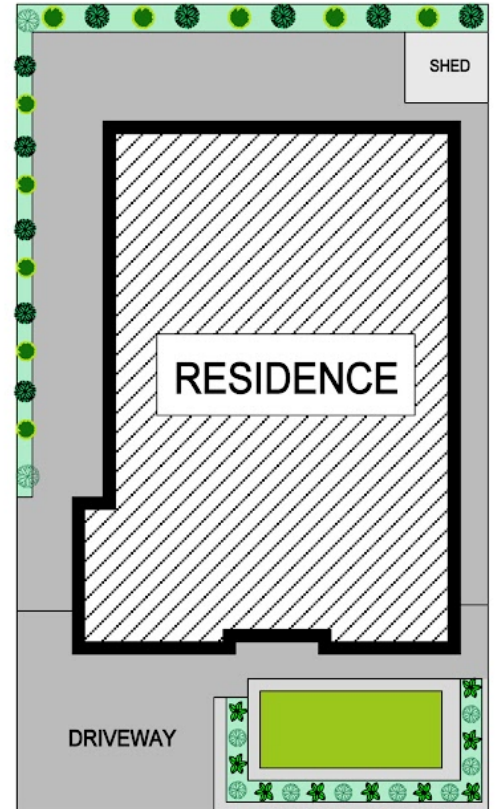

Disclaimer: Please note this floor plan is for marketing purposes and is to be used as a guide only. All dimensions are estimates only and may not be exact measurements.



REAL ESTATE FLOOR PLANS | houseguru.com.au | © House Guru Real Estate Photography™

Whilst every attempt has been made to ensure the accuracy of the floor plan contained here, measurements of doors, windows, rooms and any other items are approximate and no responsibility is taken for error, omission or mis-statement. This plan is for illustrative purposes only and should only be used as such by any prospective purchaser. The services systems and appliances shown have not been tested and no guarantee as to their operability or efficiency can be given.

Clarissa Alsop
0421827669
clarissa@atrealty.com.au
www.atrealty.com.au

