

10/8-10 BESSEMER STREET, SPRINGVALE, VIC, 3171



SOLD

SOLD SOLD SOLD \$578,000 BY VIET HA 0406 246 384

ENTERTAINERS DREAM WITH REAR ROLLER ACCESS!

VIET HA Selling Expert Property Group is pleased to present this lovely Townhouse, which will appeal to both first-time buyers and investors. This is your chance to own an impeccable, turn-key Townhouse in Springvale. Every imaginable inclusion has been considered to guarantee that this home gives an easy and comfortable lifestyle that is appropriate for modern living.

If you are looking at owning in Springvale, there is simply no other place more convenient, central, edgy and luxury Townhouse, timeless design, only four-Year-Old, this is a fantastic opportunity to grow your family or upgrade your standard of living. With a focus on a high standard, natural light and quality features and fittings. Low maintenance living and intelligent with landscaping and plants

The home welcomes you to a perfect open plan design combining the lounge, dining area and a spacious kitchen with stainless steel appliances, ample storage and Caesar stone bench tops, 900mm free standing stove/oven, which feature built, large living room, sizeable kitchen and meals area, central & well-maintained bathroom, tiled throughout, lovely paved outdoor space.

Additional features include dishwasher, another toilet downstairs, single garage with internal access, garden and so much more. This is a great home that offers a huge amount of potential in a fast-growing suburb.

Stroll up the staircase to the first floor which features the master retreat with a walk-in robe and ensuite, you will find all Two generously sized bedrooms which feature built while all being serviced by the main bathroom and separate toilet.

All that opens out to a private courtyard - perfect for an afternoon barbeque - low maintenance living and intelligent with landscaping and plants. With a focus on a high standard, natural light and quality features and fittings. Low maintenance living and intelligent with landscaping and plants. Move in or rent out as is with no improvements necessary, Prime location close to a variety of amenities.

2 BED | 2 BATH | 1 CAR

**PRICE:
\$578,000**

**OPEN FOR INSPECTION:
N/A**



Viet Ha
0406246384
viet@vietha.com.au
vietha.com.au



Springvale

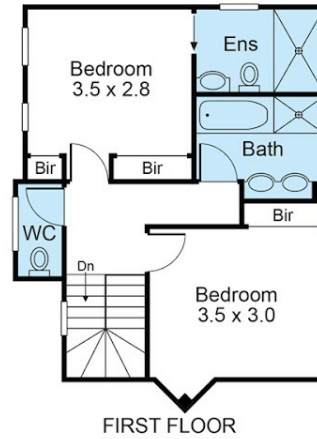
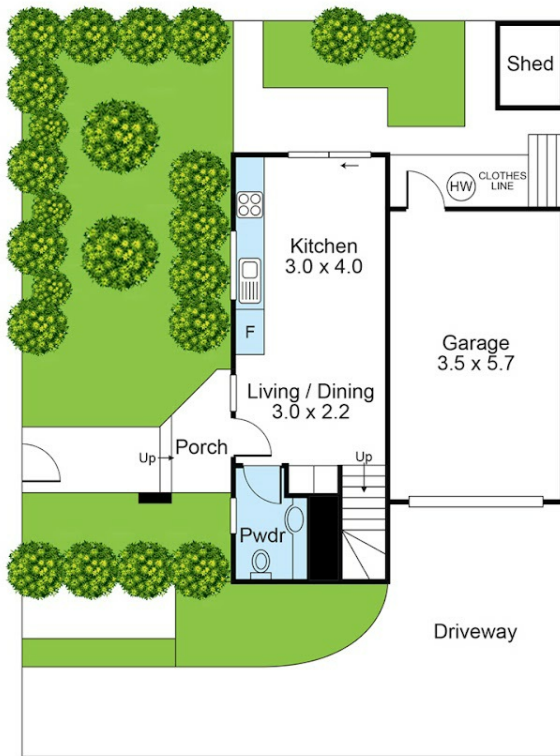

10/ 8-10 Bessemer Street, Springvale

Disclaimer: This floorplan is for illustration purposes only and no warranty is given to its accuracy. Purchasers are advised to carry out their investigations. produced by www.realpixiephotography.com.au

VIET HA
SELLING EXPERT PROPERTY GROUP

@realty

Disclaimer: Please note this floor plan is for marketing purposes and is to be used as a guide only. All dimensions are estimates only and may not be exact measurements.