

**SOLD**

## YOUNG & CHARM SINGLE LEVEL DWELLING

\*\*\*\*Government directions require all open home and onsite auctions.

- All attendees aged 16 and over must be fully vaccinated or classified as an excepted person. If you are fully vaccinated you are welcome to attend one of the advertised open for inspection times, where proof of vaccination is required prior to entry.
- If you are unvaccinated or do not wish to provide your vaccination status, please contact our team to organise a private inspection. \*\*\*\*

Whether you are starting your family or an astute investor, this young and well maintained brick veneer home is located in the Edenbrook Estate. Edenbrook Secondary College and John Primary School are within walking distance, whereas, ALDI Supermarket, Woolworths Supermarket, Big W, Bunnings, Arena Shopping Centre, Cardinia Road Station and Pakenham Train Station are just a short drive away.

Featuring:

- 3 good sized bedrooms with 2 BIRs, master bedroom with walk in robe and full ensuite
- Central bathroom and separate toilet
- Spacious laundry
- Galley style kitchen with gas appliances including dishwasher & oven opens to meals area and living area.
- Ducted heating & wall A/C
- Pergola at rear with a nice backyard
- Double garage with internal access and remote plus roller door which can access to the back

Don't miss out! Contact Bruce Ung & Kul Pathania today!

Please Note: All information contained herein and advertised is gathered from sources we deem to be reliable however, we cannot guarantee its accuracy and the interested person or purchaser should rely on their own research and satisfaction.

**3 BED | 2 BATH | 2 CAR**

**PRICE:**  
**\$587,000**

**OPEN FOR INSPECTION:**  
**N/A**



**Kul Pathania**  
**0406606600**  
kul@atrealty.com.au  
[www.atrealty.com.au](http://www.atrealty.com.au)

# 19 BAVARIA LANE, PAKENHAM

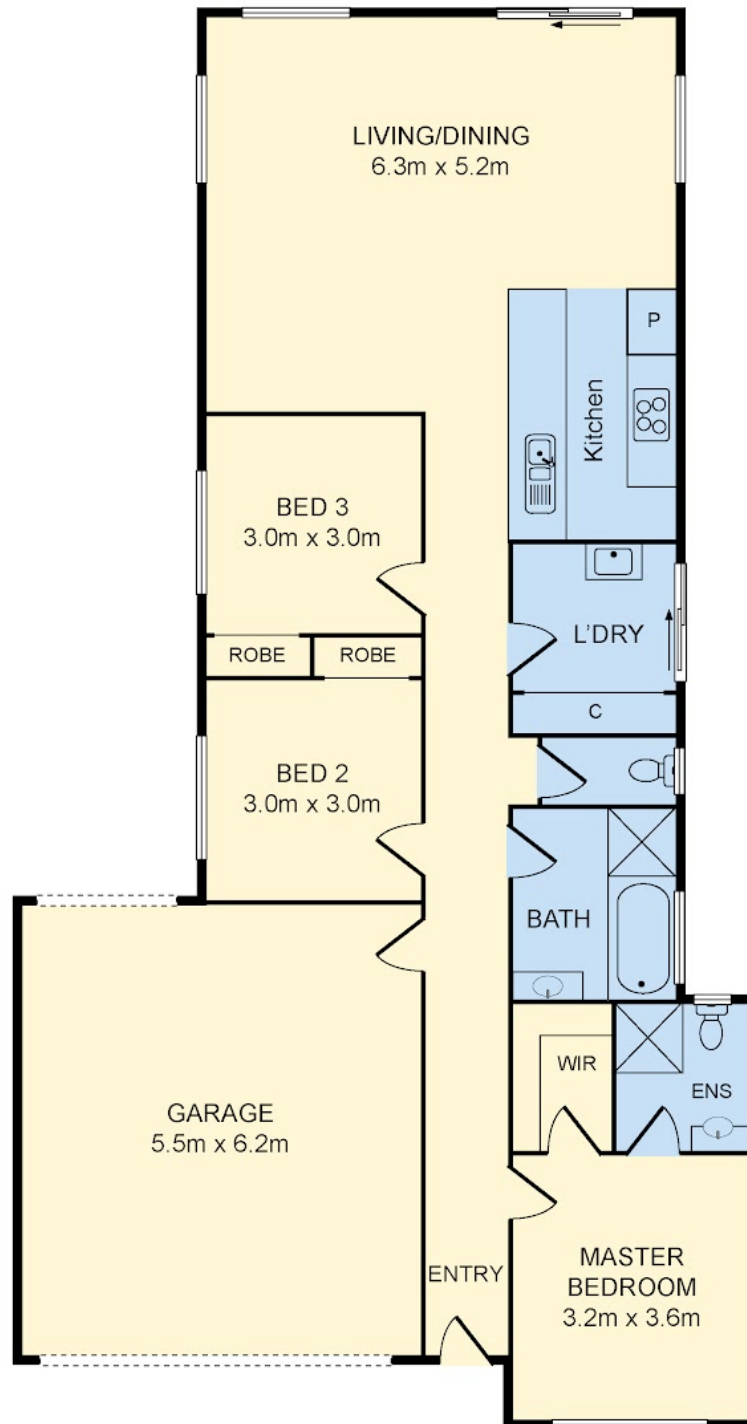

Disclaimer: Please note this floor plan is for marketing purposes and is to be used as a guide only. All dimensions are estimates only and may not be exact measurements.