

SOLD

STUNNING CAPE BEACH HOUSE

Contact the agent ASAP to register and become qualified to avoid disappointment. Open to all buyers, including finance, subject to seller approval.

For Over 50 High Res Images / Floor plans & Virtual Tours, visit the property website at 2abluewatercircle.com

The sun, the sand and the ocean - it's yours for the taking in absolute style and comfort with this stunning three-bedroom Cape home barely 300m from the water's edge and designed for maximum holiday enjoyment! Featuring the ultimate in modern lock-and-leave accommodation with fabulous spaces to entertain inside and out, ducted heating and air-conditioning, two bathrooms and a powder room, this is the perfect family escape only two hours from the city.

Moments from the surf club, the Cape Tavern and general store, revel in the surf beach lifestyle 'Cape' is famous for with nearby Inverloch, Wonthaggi and Wilsons Promontory offering plenty of things to do and see from your new coastal holiday base. Featuring black butt timber floors, the flexible floor plan flows past the king-size master bedroom with stunning ensuite and fitted walk-in robe to a light-filled living area where sliding glass doors form a corner that opens up to a sunny north-facing merbau deck.

The kitchen is a culinary work of art with loads of bench space, granite sink, stainless steel appliances and integrated pantry, plus two more generous bedrooms served by a family bathroom with free-standing bath and separate shower. A long list of other features to make your holiday dreams even more comfortable include bedroom ceiling fans, double-glazed windows, zoned heating, garden landscaping, exposed aggregate driveway, remote double garage with internal access and big enough for a boat or caravan.

3 BED | 2 BATH | 2 CAR

PRICE:
\$992,000

OPEN FOR INSPECTION:
N/A



Leo Edwards
0472523445
leo@atrealty.com.au
www.atrealty.com.au

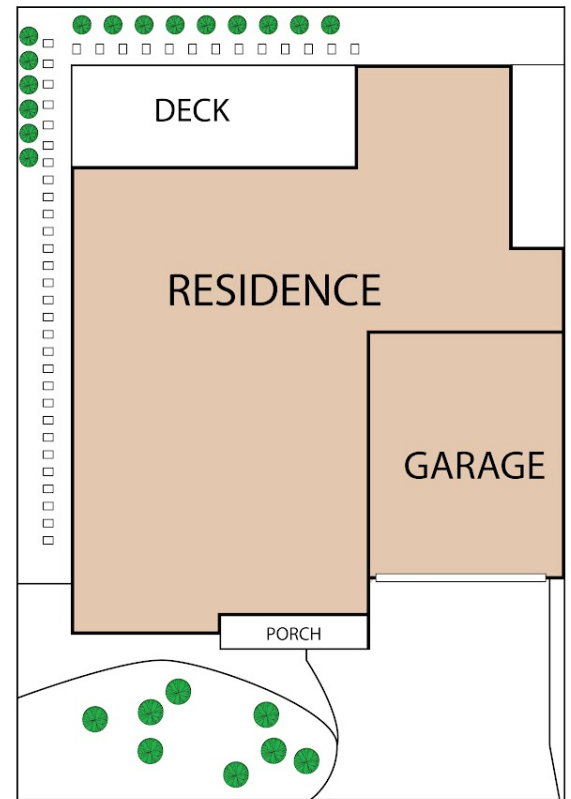

2A Blue Water Circle, Cape Paterson 3995

TOTAL APPROX. FLOOR AREA 187 SQ.M

Whilst every attempt has been made to ensure the accuracy of the floor plan contained here, measurements of doors, windows, rooms and any other items are approximate and no responsibility is taken for any error, omission, or misstatement. This plan is for illustrative purposes only and should be used as such by any prospective purchaser.



Disclaimer: Please note this floor plan is for marketing purposes and is to be used as a guide only. All dimensions are estimates only and may not be exact measurements.

Leo Edwards
0472523445
leo@atrealty.com.au
www.atrealty.com.au

