



## FOR SALE

### MODERN LUXURY IN AN ENVIABLE LOCATION!

Perfectly positioned this beautiful town home is situated within walking distance to the railway station and town centre, sure to attract attention among first home buyers, downsizers and savvy investors.

Ground floor comprise of a bedroom, bathroom and a european style laundry. Also compact backyard with internal access to the remote garage. First floor comprises of open plan living dining and kitchen with a bedroom and a bathroom. Living area opens onto the large balcony giving you indoor outdoor living .

More features are high ceilings, ducted heating, floor boards, split unit, downlights, stone bench tops, kitchen with SS appliances, dishwasher and rainwater tank with booster pump. Potential rental of \$360 per week. Low owners corporation fee is another advantage. Must see property before gone.

Please contact Joseph Hanna on 0423 966 320 for any enquiries.

2 BED | 2 BATH | 1 CAR

**PRICE:**

\$470,000 - \$500,000

**OPEN FOR INSPECTION:**

N/A



**Joseph Hanna**

**0423966320**

joseph@atrealty.com.au

[www.atrealty.com.au](http://www.atrealty.com.au)

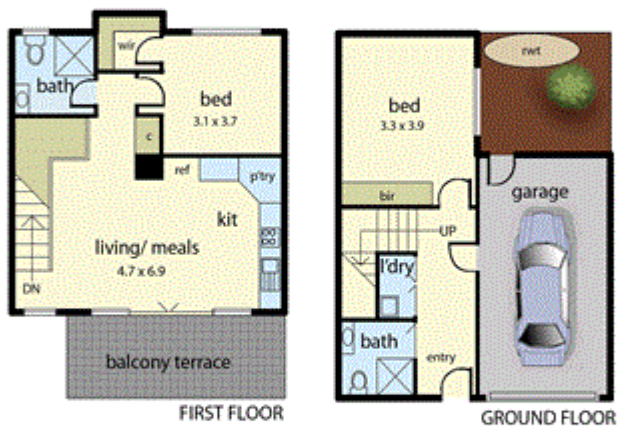

## 6/41 Stuart Street, Noble Park

This floorplan is for illustration purposes only and no warranty is given to its accuracy. Purchasers are advised to carry out their own investigations.  
Produced by DND Floor Plans.

Disclaimer: Please note this floor plan is for marketing purposes and is to be used as a guide only. All dimensions are estimates only and may not be exact measurements.