

# FOR SALE

## PRICE GUIDE \$2,300,000

### Single Level Living in a Whisper Quiet Location

Where residential meets acreage on 696sqm of land, this beautifully presented and well-maintained home is perfect for families or downsizers. Private from the street, nestled behind established hedged gardens this home is ideal for those families who love to entertain. The large undercover deck is ideal for family get togethers, children's birthday parties and play area or just relaxing at home. The level back lawn and gardens are fully fenced a safe haven for the children and the family pet.

- Three spacious bedrooms all with built-in cupboards
- Two beautifully renovated family bathrooms
- Large galley kitchen with plenty of storage, induction cooktop and dishwasher
- The spacious living area opens to the deck through large bi-fold glass doors
- The family room also doubles as a separate home office
- Neutral colour palette throughout, filled with natural light, floor boards, air-con to living areas
- The double garage is oversized and offers storage and workbench
- Within walking distance to the local public school, public transport and the local shopping centre.
- For the active family, close to walking and bike riding trails through the National Park
- A large choice of schools includes the International German School, the Northern Beaches Christian School and the International Japanese School.
- Also a great choice of local pre-schools and day-care centres

Council rates: \$433.80 approx. per quarter

Water rates: \$291.40 approx. per quarter

## 3 BED | 2 BATH | 2 CAR

PRICE:  
\$2,300,000

OPEN FOR INSPECTION:  
N/A



**Karen Turner**

**0424755448**

karen@turnercullenproperty.com.au

turnercullenproperty.com.au

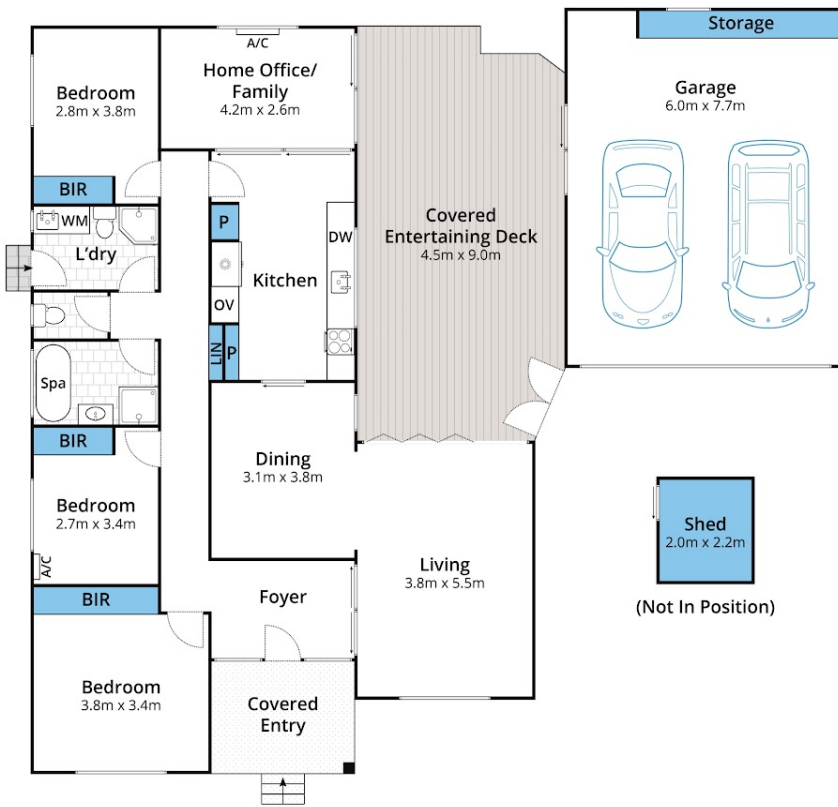

Ground Floor

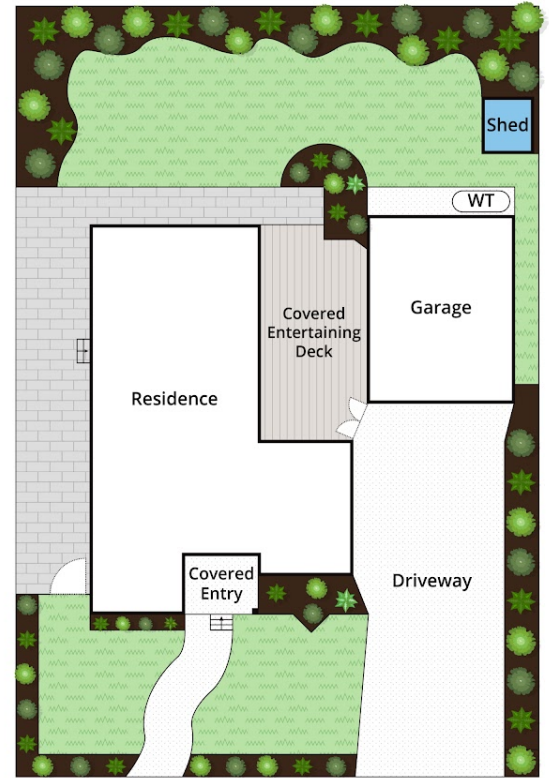

Site Plan

Whilst [bwrmm.com.au](http://bwrmm.com.au) has made every attempt to ensure the accuracy of the floor plan contained here, measurements are approximate and no responsibility is taken for any error, omission, or mis-statement. This plan is for illustrative purposes only.

## 16 Laitoki Road, Terrey Hills

Disclaimer: Please note this floor plan is for marketing purposes and is to be used as a guide only. All dimensions are estimates only and may not be exact measurements.