



SOLD

MODERN & CONVENIENT

Near new cleverly designed Townhouse offers a generosity of space with flexible layout configuration that spare no expense with quality materials and fixtures throughout. Built in 2020, with it's own frontage and no body Corporate fees this lovely home spreads over a two-story floor plan. Downstairs are bright living and dining areas accompanied by an open-plan kitchen fitted with stone benchtops, tiled splashback, stainless-steel appliances and dishwasher. First floor Level of comfort has been maximised for your enjoyment offering three bedrooms, Master with ensuite and walk in robe, Gallery/Study and main bathroom. Further for your convenience there are Laundry and separate powder room, single Garage with additional Car space and fully landscaped courtyard.

All amazing features complete the profile of perfect home for those looking for a relaxed lifestyle coupled with spacious and low maintenance living. There are only four residences on this site and available unit is Highly Recommended to be placed at the top of your Inspection List.

Property Features:

- Study nook
- Master bedroom with a walk-in robe and an ensuite
- Kitchen with Stone Benchtops and tiles Splashbacks
- Stainless steel appliances including Dishwasher
- Gas cooking
- Double glazed windows
- Powder room conveniently located downstairs
- remote roller shutter at the front
- Ducted Heating
- Remote Garage with rear access
- Low maintenance backyard

Conveniently located in family friendly suburb and within close proximity to all Local amenities and M1 Freeway.

3 BED | 2 BATH | 1 CAR

PRICE:
\$605,000

OPEN FOR INSPECTION:
N/A



Marko Rankovic
0427771810
markorankovic@atrealty.com.au
www.atrealty.com.au

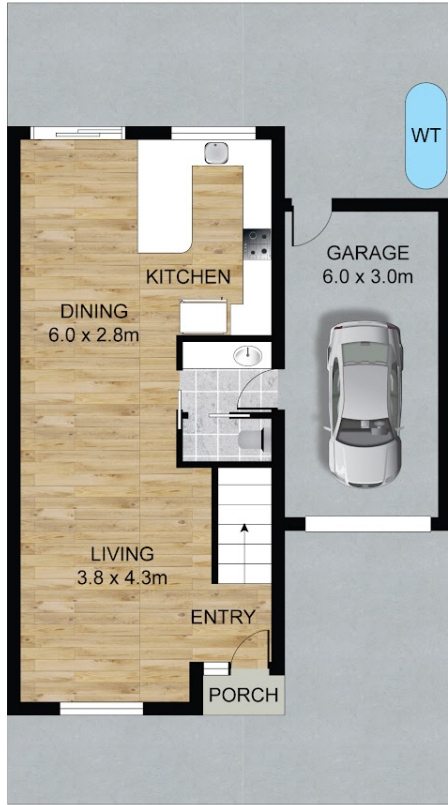

GROUND FLOOR



FIRST FLOOR



Property Address: 1A ROMA COURT, EUMEMMERRING VIC 3177

Disclaimer: Please note this floor plan is for marketing purposes and is to be used as a guide only. All dimensions are estimates only and may not be exact measurements.