



SOLD

EXQUISITE FAMILY ABODE ON 1,000SQM BLOCK

Welcome to 5 Doneley St, Wilton. This exquisite family haven is set in a quiet leafy street and encompasses family functionality with style and opulence. Spread over an expansive floor plan that showcases an array of modern comforts that is accompanied by it's sleek interiors which can be adorned at every turn. It's clever use of space has been maximised to ensure your family's level of comfort is of the highest priority. The home's superb setting is complemented by it's beautiful surroundings and is tailored to those seeking a contemporary lifestyle in one of Bingara Gorge's finest streets.

Features Include:

- Front porch overlooks the established & manicured front yard
- Boasting four generously proportioned bedrooms with built in robes & ceiling fans
- The master suite includes a walk in robe & an ensuite with dual basins & a frameless shower screen
- Expansive formal living room is equipped with an open fireplace that is exquisitely framed with marble
- Media room is equipped fitted out storage
- Open plan family & dining room
- Well appointed kitchen with ample cupboard & bench space
- Stainless steel appliances including a dishwasher
- Falcon Toledo dual oven & gas cooktop
- Stone benchtops
- Walk in pantry
- Breakfast bar overlooking the meals area
- Bright & airy main bathroom equipped with heated towel racks & a bathtub
- Laundry includes built in cupboards & backyard access
- Multiple Internal storage cupboards located throughout
- Ducted air conditioning
- Porcelain tiles to main living areas
- 10Kw Solar panels
- Irrigation system
- Expansive entertaining alfresco with pull down slider shades, perfect for entertaining in all weather conditions

4 BED | 2 BATH | 2 CAR

PRICE:
\$1,352,000

OPEN FOR INSPECTION:
N/A



Bobby Reynolds
0432173566
bobby.reynolds@atrealty.com.au
agencycentralwilton.com.au

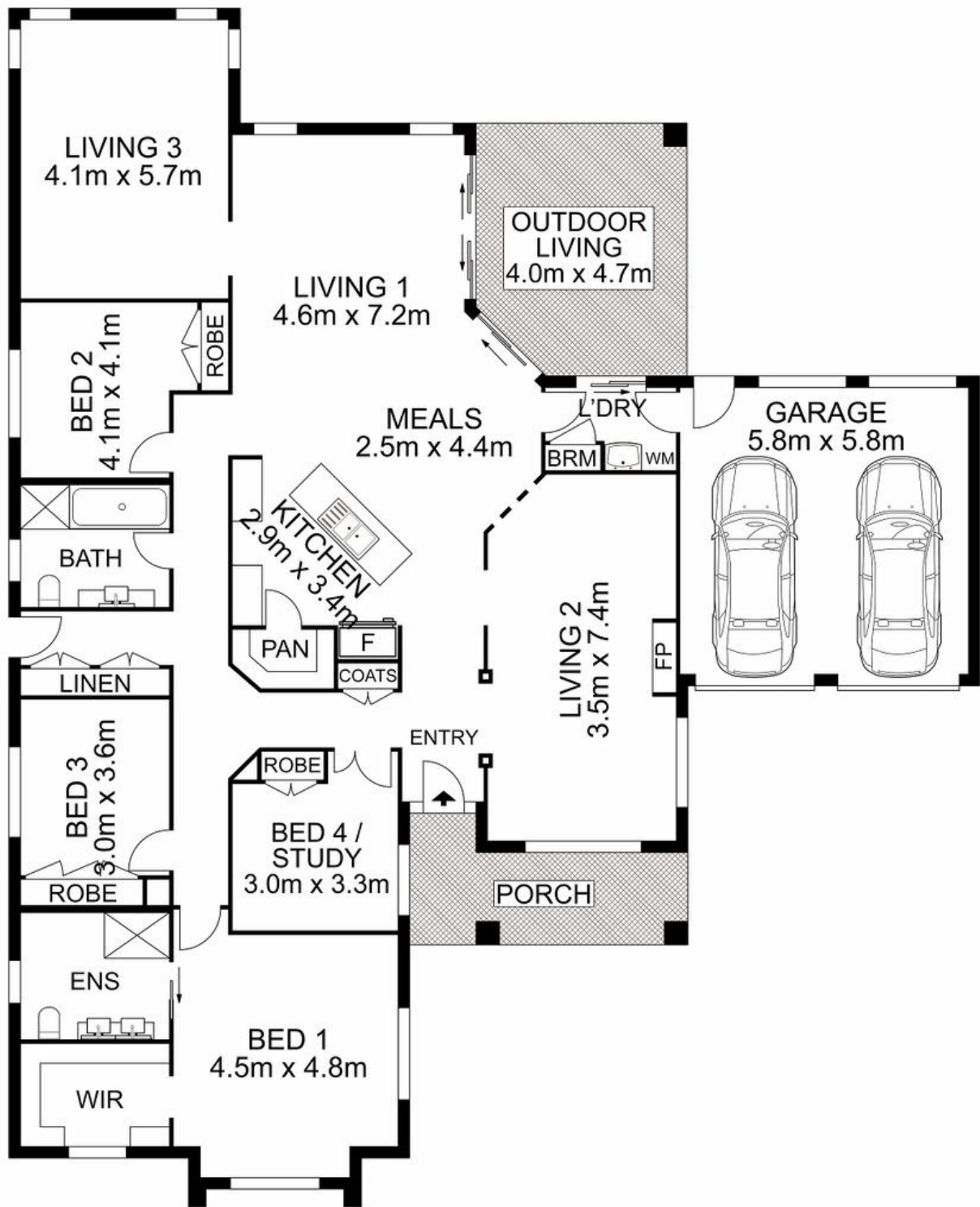

Disclaimer: Please note this floor plan is for marketing purposes and is to be used as a guide only. All dimensions are estimates only and may not be exact measurements.

5 Doneley Street, Wilton

Bobby Reynolds All measurements are approximate • Drawn for marketing purposes only
 0432173566
 bobby.reynolds@atrealty.com.au
agencycentralwilton.com.au

