



**SOLD**

## HOME WITH THAT LITTLE EXTRA

This home would suit several potential buyers. Perfect as the family home or zoned to be the ideal business premises. Currently used as medical clinic the current tenant is moving so the new owner has a couple of options. This character home has a private front yard with front decking / Veranda, an ideal spot to sit and unwind. Entering the home, you have polished floorboards that flow through the home with the main bedroom to the right, with Built in robes and large En-suite. Large Second bedroom to the left, before you enter to a Country Style Kitchen, with solid Jarrah timber, dishwasher, and plenty of bench and Cupboard space. From the kitchen you enter a stunning open family meals area, complemented by Cathedral Ceilings and Glass Atrium, this area has split system Air-Conditioning and Slow Combustion heating. A third bedroom and bathroom join this living area and a stair way leads to a 4th Bedroom or living area with small loft looking over the family room which would make a great office. The bathrooms are nicely appointed and a handy 3rd toilet of the laundry with outside access. Rear yard access to a good size backyard with a Colourbond Double garage plus double Carport, ideal for keeping the vehicles out of the weather. Please note Current Photos are from a few years ago prior to tenant.

RLA 269823

**4 BED | 2 BATH | 4 CAR**

**PRICE:**  
\$369,500

**OPEN FOR INSPECTION:**  
N/A



**Peter Dempsey**  
**0418854393**  
peterdempsey@atrealty.com.au  
[peterdempseyatrealty.com](http://peterdempseyatrealty.com)  
RLA: 269823

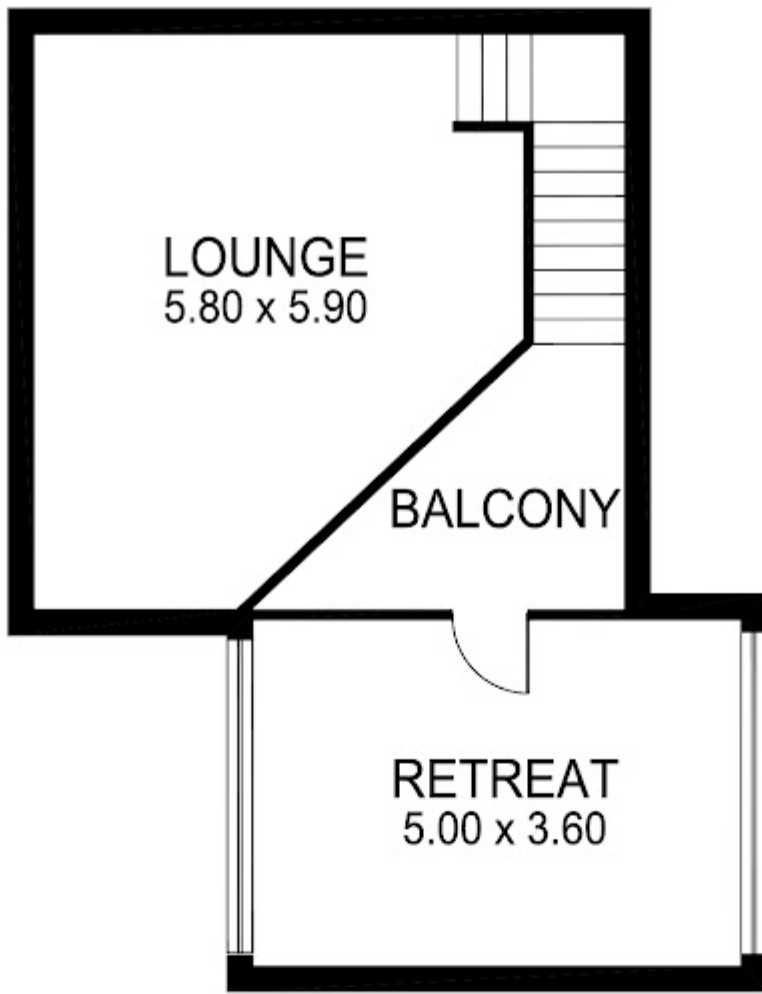

UPPER LEVEL

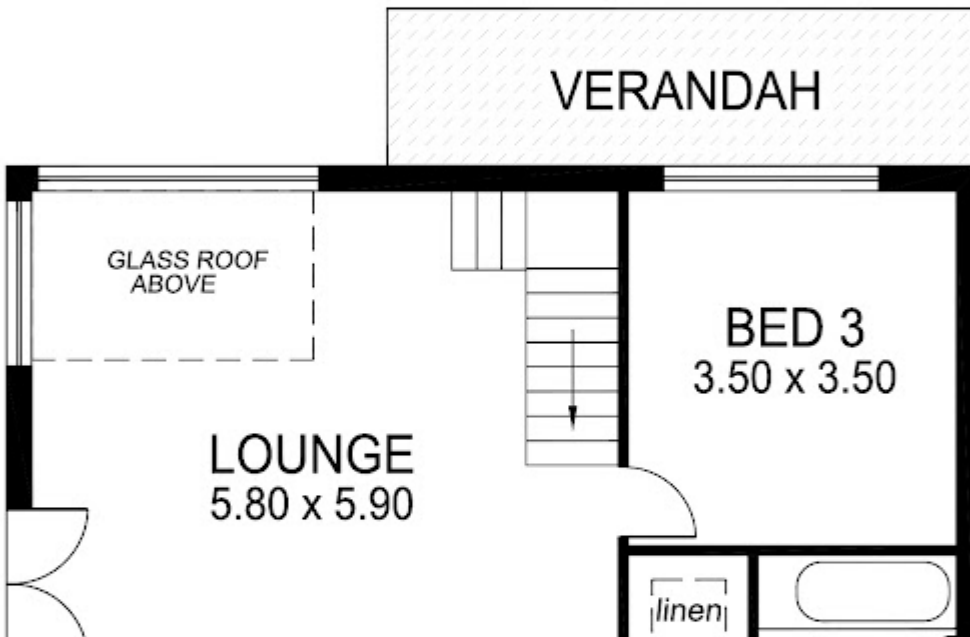

Disclaimer: Please note this floor plan is for marketing purposes and is to be used as a guide only. All dimensions are estimates only and may not be exact measurements.

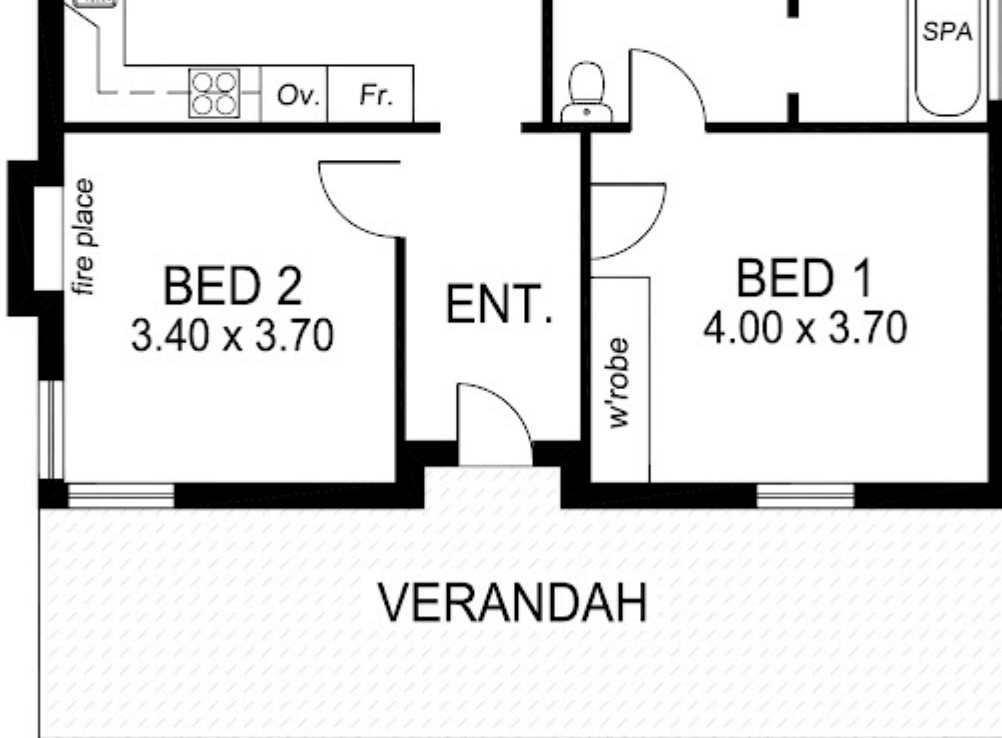

This drawing is for illustration purposes only.  
All measurements are approximate only and information  
intended to be relied upon should be independently verified.