



FOR SALE

RESORT LIVING, WATER VIEW, IN THE HEART OF PARRAMATTA - OFFERS INVITED

Brand new apartment. Perfect for the first home buyer or investor. The Lennox represents a timeless icon offering a truly unique riverside living experience. Footsteps from the upcoming light rail stop, river foreshore park and Parramatta's Eat Street - the Lennox lifestyle means having all your essentials right at your doorstep.

Features:

- Engineered timber floor
- Miele appliances
- Ducted Air Conditioning system
- Audio/Video intercom between lobby and apartment
- Secure access to ground floor lobby and common facilities
- 25m swimming pool and gym
- Common outdoor terrace for entertaining and BBQ
- Conference room
- 24 hr concierge
- Riverview to the east

Location:

- 800m walk to Parramatta Westfield
- 650m walk to Parramatta Station
- Footsteps from future light rail stop and Parramatta's Eat Street
- 650m walk to Parramatta Wharf
- 300m walk to Parramatta Public School
- 500m walk to Arthur Phillip High School
- 400m walk to Our Lady of Mercy College Parramatta
- Close distance to Western Sydney University, Parramatta Campus, also Westmead Hospital, restaurants and cafes.

Internal Area: 50sqm

External Area: 7sqm

Storage: 2sqm

Total Area: 59sqm

1 BED | 1 BATH | 0 CAR

PRICE:

\$599,000

OPEN FOR INSPECTION:

N/A



Ning Widjaja

0416197919

ning@atrealty.com.au

www.atrealty.com.au

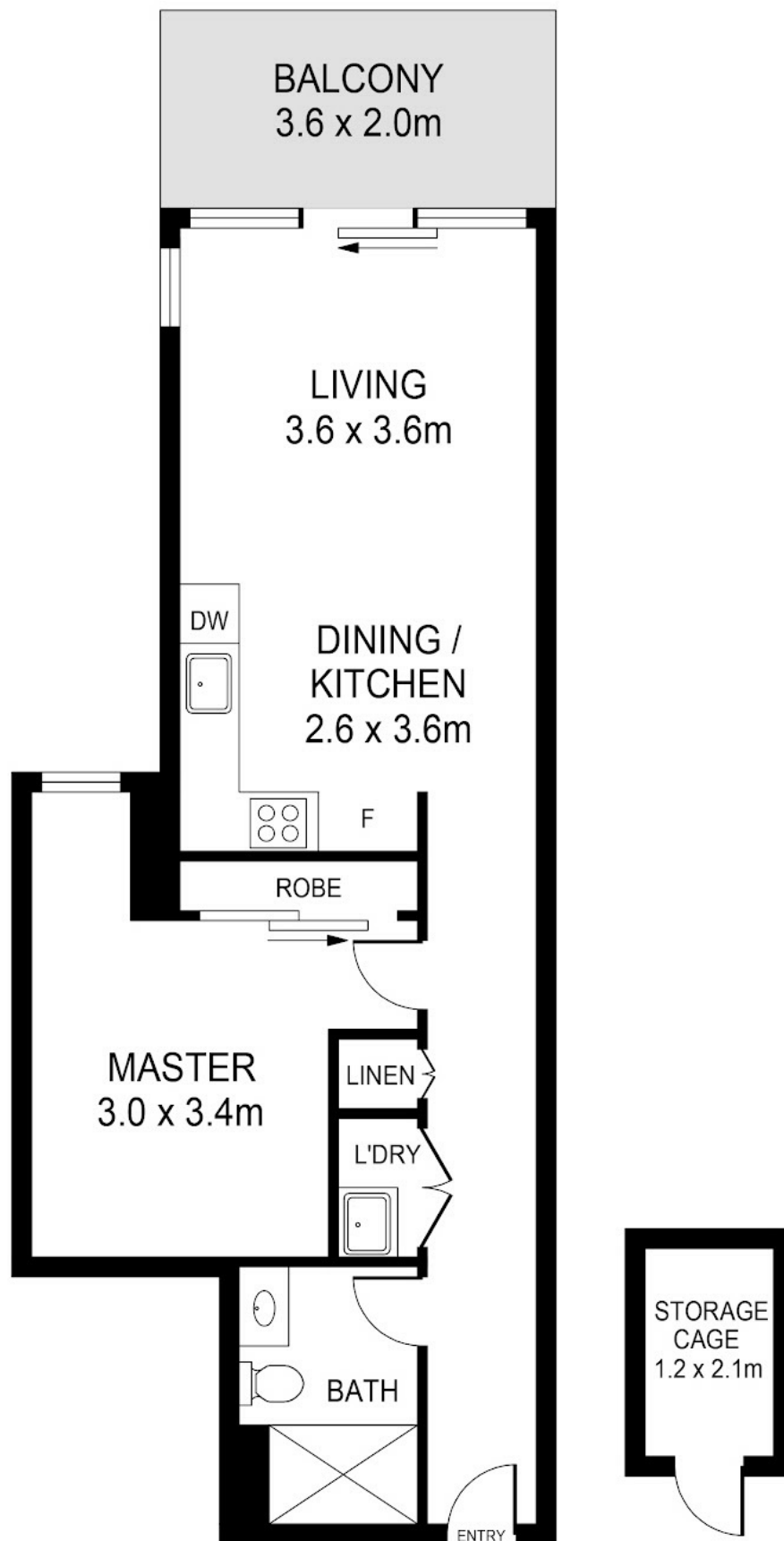

Disclaimer: Please note this floor plan is for marketing purposes and is to be used as a guide only. All dimensions are estimates only and may not be exact measurements.

DISCLAIMER:

PLANS SHOWN ARE FOR MARKETING PURPOSES ONLY, ALL DIMENSIONS ARE APPROXIMATE AND NOT TO SCALE. THEY ARE SUBJECT TO ERRORS AND INACCURACIES AND NO LIABILITY WILL BE INCURRED. INTERESTED PARTIES SHOULD MAKE THEIR OWN INQUIRIES.

Ning Widjaja
0416197919

ning@atrealty.com.au

www.atrealty.com.au

