

SOLD

SOLD BY ROBYN HUNT

Nestled privately amongst the trees and enjoying north facing views to Nightcap National Park this tranquil one and a half acre gem presents a rare opportunity.

Featured in Sustainable House Day in 2019 the impressive 5 bedroom, 3 bathroom home with parents retreat presents a range of versatile living options over 2 levels and has been designed with sustainable principles in mind for eco friendly living.

With an aquaponics system installed on the verandah providing herbs and salads you can easily dine alfresco and pick straight from the garden to your plate. Factor in an impressive permaculture food forest with a large variety of established fruit trees and further veggie/herb gardens close by and food miles don't get any fewer than this!

A snapshot of features on offer include:

- Large wood heater with oven in the main living area - great for baking bread or pizzas
- New 5 burner Glem gas cooktop and a Westinghouse gas oven
- Solar passive design with windows to the north - allowing winter sun to stream in while being shaded from summer sun
- 7.5kW PV solar system connected to the grid
- Permanent spring fed water feature with water lilies and an area for sitting for a quiet retreat
- Seasonal waterway running into a rainforest
- Forest path leading to towering Bangalow Palms, Tree Ferns, Staghorn Ferns and Bird's Nest ferns
- Local wildlife including Grey Wallabies, Swamp Wallabies, Koalas, Echidnas, Blue Crayfish, plus a large variety of birds
- Within walking distance to private schooling of an excellent standard

Offering plenty of flat grass area to kick a ball, relax with a picnic or enjoy a cosy bonfire party in winter there is also ample space for a Tiny Home, caravan, boat, yoga studio or whatever you can dream up for the spare parcel of land that could even accommodate a secondary dwelling (STCA).

Located close to a medical hub, bus services, sporting grounds, clubs and more it's also an easy drive to stunning local beaches, rainforests and the thriving Ballina/Byron Gateway Airport.

5 BED | 3 BATH | 2 CAR

PRICE:
\$1,015,500

OPEN FOR INSPECTION:
N/A



Robyn Hunt
0448448758
robyn@atrealty.com.au
www.atrealty.com.au

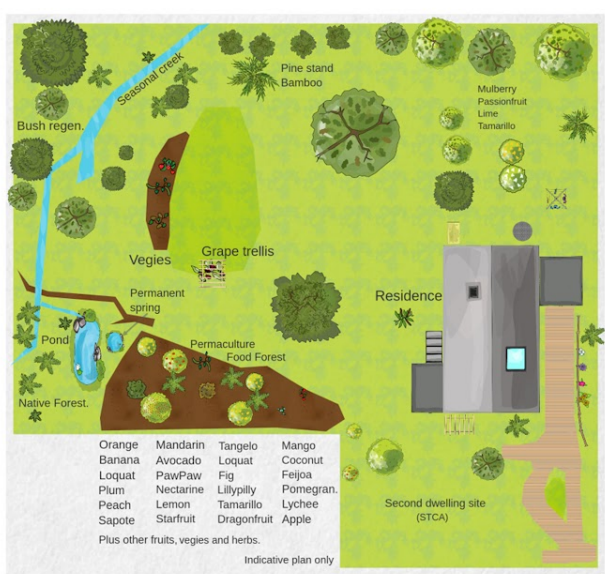
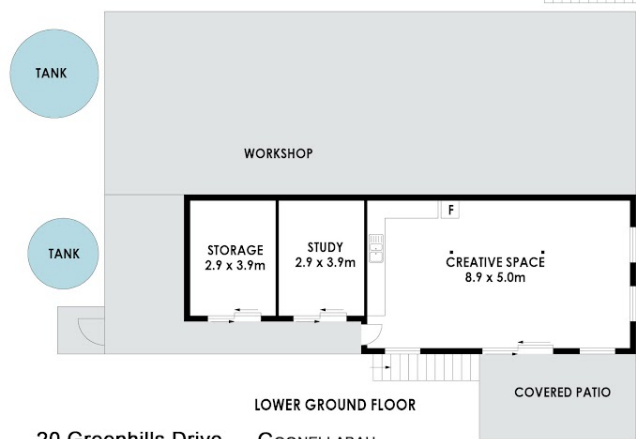
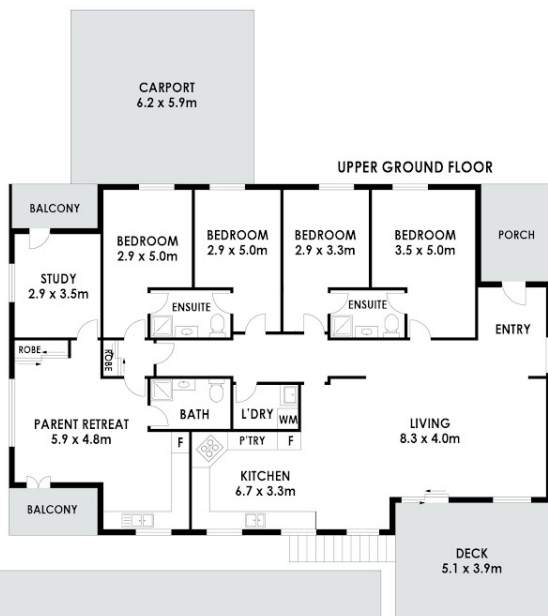

- Orange
 - Banana
 - Loquat
 - Plum
 - Peach
 - Sapote
 - Mandarin
 - Avocado
 - PawPaw
 - Nectarine
 - Lemon
 - Starfruit
 - Tangelo
 - Loquat
 - Fig
 - Lillypilly
 - Lemon
 - Tamarillo
 - Dragonfruit
 - Mango
 - Coconut
 - Feijoa
 - Pomegran.
 - Lychee
 - Apple
- Plus other fruits, vegies and herbs.
Indicative plan only

SITE PLAN
(NOT TO SCALE)

20 Greenhills Drive GOONELLABAH

Floor Plan Disclaimer - Media Drive (MD) floor plans / site plans are intended as an approximate guide only. No representations or warranties of any nature are given or intended and any person using this information other than as a guide should always rely on their own enquiries. Media Drive property marketing services / 0413979054 / Photography, Floor plans, Video, Aerial photography / www.mediadrive.com.au

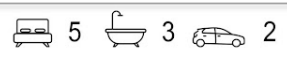

| |
|------------------------------------------|
| APPROXIMATE AREAS @realty |
| INTERNAL FLOOR SPACE - 269m ² |
| EXTERNAL FLOOR SPACE - 53m ² |
| CARPORT - 35m ² |

Disclaimer: Please note this floor plan is for marketing purposes and is to be used as a guide only. All dimensions are estimates only and may not be exact measurements.

Robyn Hunt
0448448758
robyn@atrealty.com.au
www.atrealty.com.au

