



**SOLD**

## WHEN SIZE MATTERS

This property is perfect for retirees or a young family looking to live close to town. This tastefully presented house ticks all the boxes and is move-in ready, recently painted inside and out and features an open plan living area the lounge has access to the front porch the large light filled kitchen has plenty of bench space and storage and a good size breakfast bar, the dining area has access to the rear utility room great for a craft room home office or entertaining and relaxing in with a convenient 2nd toilet

Consisting of 3 spacious bedrooms 2 with built-ins, separate large laundry with good storage space. Updated bathroom with a separate toilet, a fully fenced front and back yard undercover entertaining area 2 remote garages and a carport. Ducted airconditioning and fans throughout led lighting 6.6 Solar system and solar hot water a great workshop area with plenty of storage space and drive through access to the back yard, chook shed and veggie garden set on a 1204m2 block positioned one street back from the river within walking distance to the local shops and cafes with great boating arrangements perfect for the fisherman also a perfect spot for a walk or a picnic or BBQ within a short distance and a pleasant drive to local beaches. A Inspection is sure to impress.

**3 BED | 1 BATH | 3 CAR**

**PRICE:**  
**\$450,000**

**OPEN FOR INSPECTION:**  
**N/A**



**Peta Thompson**  
**0403123115**  
petathompson@atrealty.com.au  
[www.atrealty.com.au](http://www.atrealty.com.au)

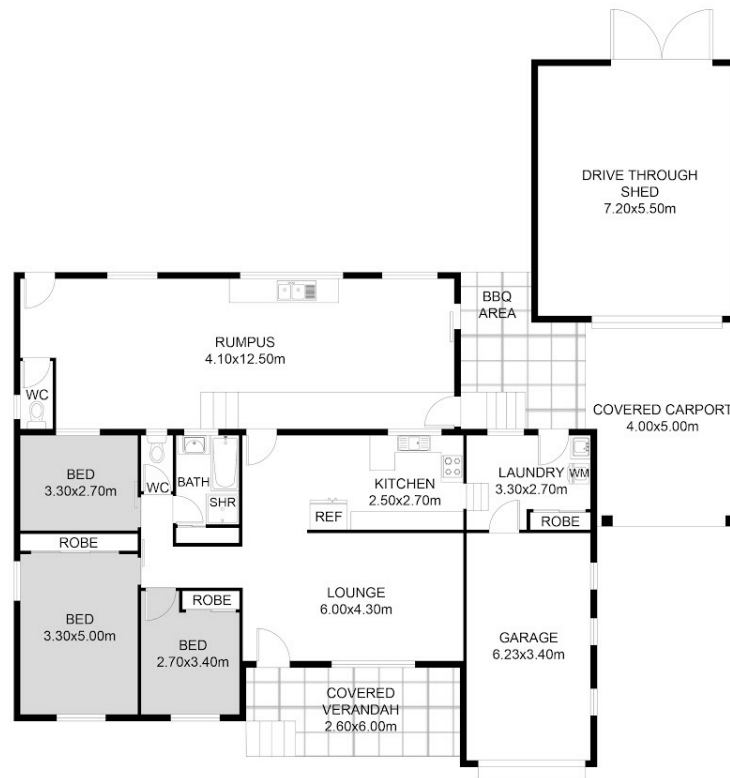

FLOOR PLAN



This floor plan including furniture, fixture measurements and dimensions are approximate and for illustrative purposes only. BoxBrownie.com gives no guarantee, warranty or representation as to the accuracy and layout. All enquiries must be directed to the agent, vendor or party representing this floor plan.

119 Bridge Street, Coraki

Disclaimer: Please note this floor plan is for marketing purposes and is to be used as a guide only. All dimensions are estimates only and may not be exact measurements.