



SOLD

LUXURIOUS LOW-MAINTENANCE LIVING IN PREMIUM POSITION

Perfectly positioned in the heart of Werribee, this welcoming home provides easy access to all of Wyndham's finest amenities.

This modern and low-maintenance floor plan delivers two separate living zones allowing residents to enjoy the fully renovated kitchen in an open plan meals / living space, whilst others can have some privacy in the second living area nearby.

Further comprising three spacious bedrooms (master with full-ensuite and walk-in-robe), a tidy family bathroom, generous study and a full sized laundry, this well-maintained home provides all of the essentials in a brilliant location. Additional features include a double garage, solar panels, security camera system, alarm system, ceiling fans plus, roller shutters, ducted heating and evaporative cooling.

Outside is a large carport / undercover patio ideal for entertaining, as well as an additional storage shed for those extra belongings.

Within walking distance to Bethany Catholic Primary School and Westgrove Primary School, this family friendly position offers a convenient lifestyle in the centre of this fantastic suburb. Also nearby is Pacific Werribee, an array of parklands, Werribee Village Shopping Centre and Werribee Railway Station.

3 BED | 2 BATH | 2 CAR

PRICE:
\$605,000

OPEN FOR INSPECTION:
N/A



Samuel Hogan
0401315234
samuel@atrealty.com.au
www.atrealty.com.au

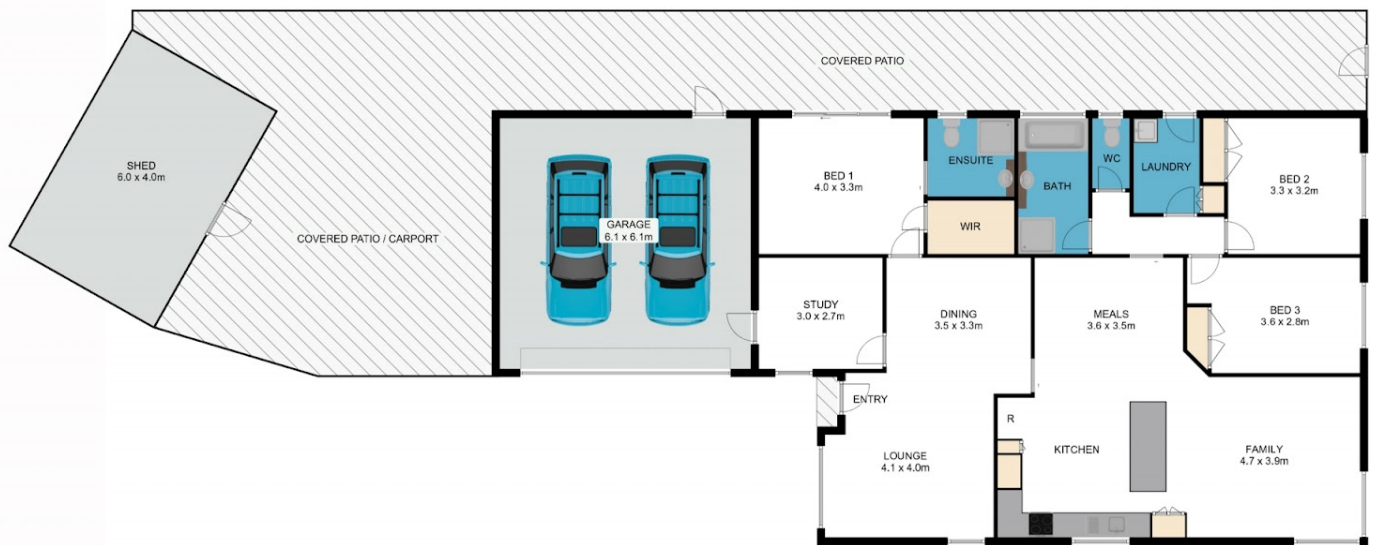

12 Nile Court, Werribee



Whilst every attempt has been made to ensure the accuracy of the floor plan contained here, measurements of doors, windows, rooms and any other items are approximate and no responsibility is taken for any error, omission, or mis-statement. This plan is for illustrative purposes only and should be used as such by any prospective purchaser. The services, systems and appliances shown have not been tested and no guarantee as to their operability or efficiency can be given.



Disclaimer: Please note this floor plan is for marketing purposes and is to be used as a guide only. All dimensions are estimates only and may not be exact measurements.