



SOLD

UNDER CONTRACT

Be quick to secure this stunning cottage style home, that is set in an elevated position with park outlook. Ideal for the first home buyer or downsizer alike, looking for an easy-care home in a great location. This home would also be ideal for the astute investor looking to add to their property portfolio. The side access and oversized garage give this home the edge over the competition along with the feature ceiling in the theatre and the park views.

Some of the many features include:

- Set on a low maintenance 363 sqm block
- Built in 2014 by Affordable Living Homes
- Neutral tones throughout
- High ceilings throughout compliment the home and help contribute to the spacious feeling the home exudes
- Theatre room with feature recessed ceiling is located at the front of the house
- Master bedroom is light and bright and offers lovely park views, ceiling fan, walk in robe and modern ensuite
- Central kitchen offers lots of storage, 900mm gas cooktop, a dishwasher and overlooks the dining and family rooms
- Two separate living areas
- Courtyard area to the front of the property overlooks the park and is paved
- Minor bedrooms with robes
- Modern family bathroom
- Split system air conditioning to formal lounge area and family room

3 BED | 2 BATH | 2 CAR

PRICE:
\$390,000

OPEN FOR INSPECTION:
N/A



Clarissa Alsop
0421827669
clarissa@atrealty.com.au
www.atrealty.com.au

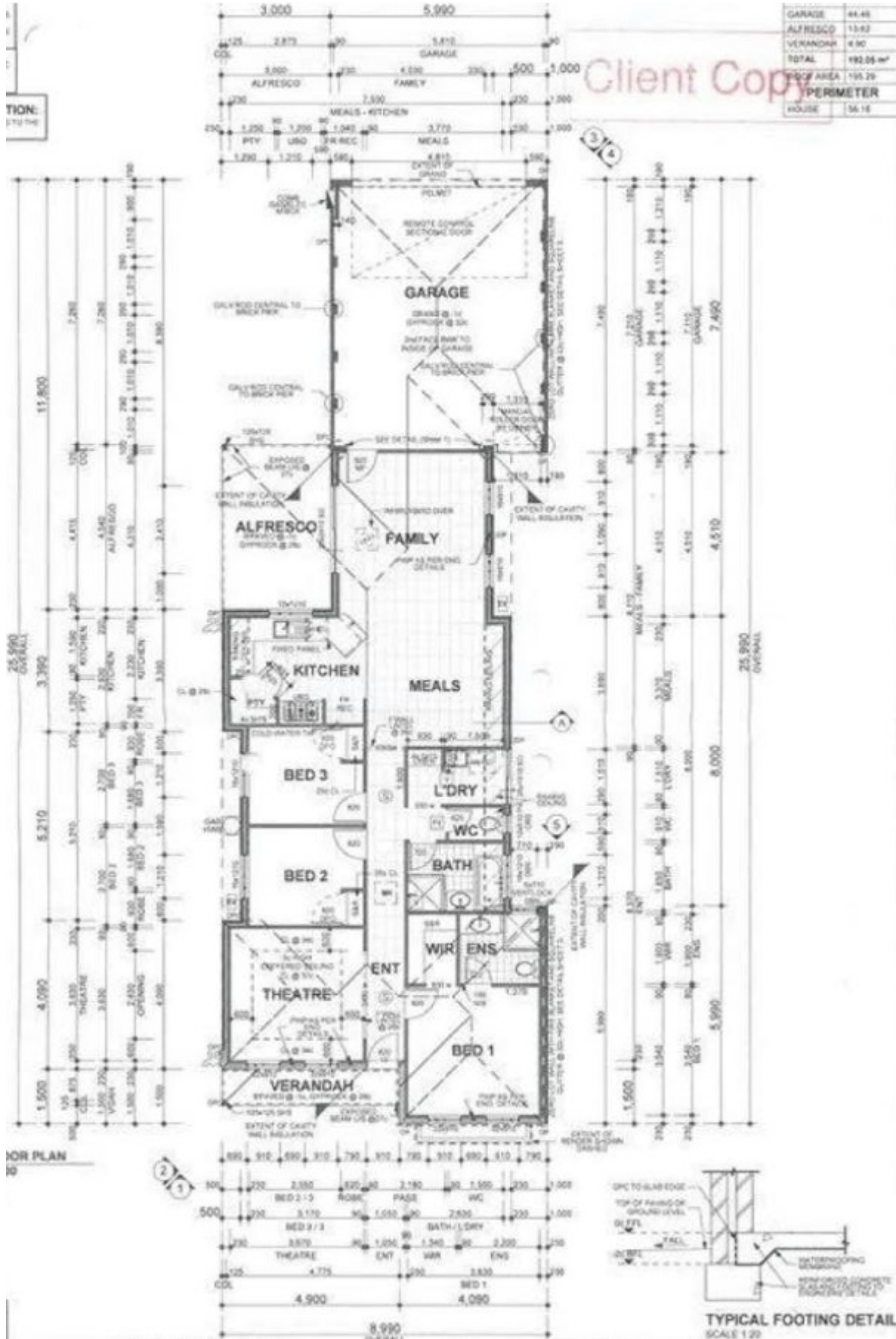

Disclaimer: Please note this floor plan is for marketing purposes and is to be used as a guide only. All dimensions are estimates only and may not be exact measurements.