



SOLD

ROOM FOR ALL THE FAMILY IN CAPE

For more detailed info / 3D Tours / Video visit the property website at 50anchorparade.com

Spacious, and surrounded with nature, 50 Anchor Parade, Cape Paterson is a ready-made retreat. With ocean views from the second floor, and a beautifully established garden, this unique 4 bedroom, 4 bathroom property has a space for everyone, and would make a lovely family home or accommodation business. The large kitchen is fully equipped with oak bench tops and soft close cupboards and drawers all round along with beautiful glass mirrored splash backs. As for appliances, there's a top of the range stove, dishwasher, and refrigerator with freezer. Just off the kitchen sits a lovely dining area and living area which leads through to a second large north facing living room with a stunning feature raised skylight and floor to ceiling windows offering views out to the well established gardens, fire pit and fruit trees.

Down lights accentuate the gallery style walls designed to house art works, and a separate switch will light up the night garden. The thriving fruit trees include a lemon tree, a lime tree and a passion fruit plant on the wall. There is also a small storage shed and a side veggie garden. For those who love to sit outside with a cuppa, the front porch is glassed-in, away from the wind, and includes a herb garden and barbecue area.

The home has a large solar hot water tank, together with a solar panel system on both levels of the house. The upstairs master bedroom offer plenty of space and features sliding doors that open out onto a front deck overlooking the ocean. Surrounding the address is a lovely park both for kids playtime and picnics, and the property is just a 7 minute walk to the boat ramp and famous rock pool swimming area.

4 BED | 4 BATH | 2 CAR

PRICE:
\$920,000

OPEN FOR INSPECTION:
N/A



Leo Edwards
0472523445
leo@atrealty.com.au
www.atrealty.com.au

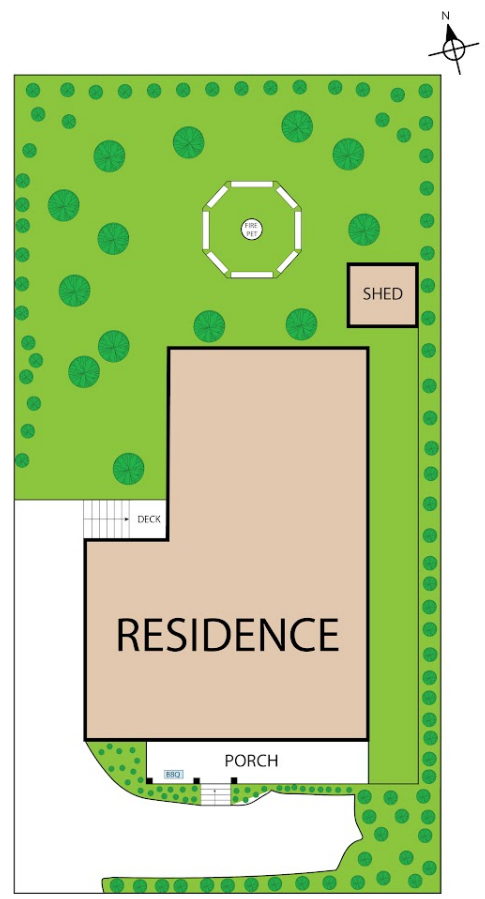
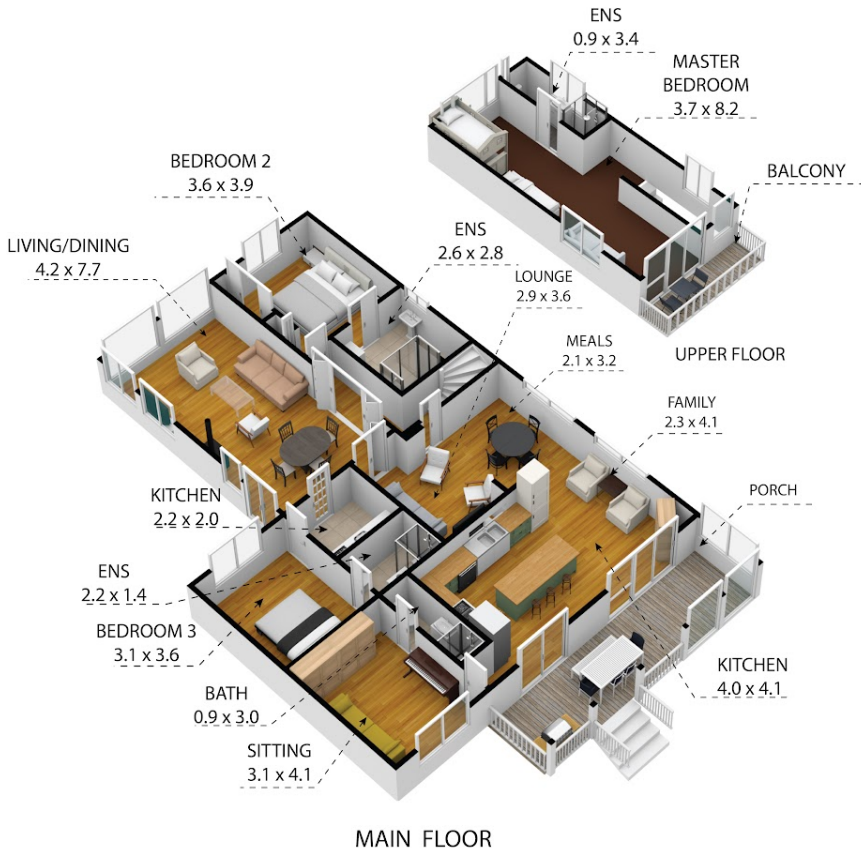

50 Anchor Parade, Cape Paterson 3995

TOTAL APPROX. FLOOR AREA 161 SQ.M

Whilst every attempt has been made to ensure the accuracy of the floor plan contained here, measurements of doors, windows, rooms and any other items are approximate and no responsibility is taken for any error, omission, or misstatement. This plan is for illustrative purposes only and should be used as such by any prospective purchaser.

INVERLOCH
RESIDENTIAL

@realty

Disclaimer: Please note this floor plan is for marketing purposes and is to be used as a guide only. All dimensions are estimates only and may not be exact measurements.

Leo Edwards
 0472523445
 leo@atrealty.com.au
 www.atrealty.com.au

@realty