



**SOLD**

## CONTACT AGENT

From the moment you arrive, you will be drawn to this beautiful home on 1340sqm. Just minutes from the heart of Drouin and quietly nestled away in this sought after Jackson View Estate, the home is perfectly placed on top of the hill to take advantage of spectacular views.

This Property is full of features including:

- 4 bedrooms plus office.

Master with Balcony to enjoy the views, His and Her WIR. Ensuite with double shower, double basins and separate toilet. Main Bathroom upstairs services the three remaining double bedrooms, two with WIR and a BIR in the fourth bedroom.

- 4 Living areas, one upstairs and 3 downstairs

Plenty of living rooms for all the family to enjoy, make them your own:- kids playroom, theatre room and rumpus. Large open family steps seamlessly opens into the undercover entertaining area.

- Large kitchen with plenty of bench space.

The S/S dishwasher, 900mm freestanding oven and cooktop and plenty of storage is perfect for the family every day or entertaining the extended family and friends.

Ducted heating and evaporative cooling to keep you cool in summer and toasty warm in winter.

- In-ground Pool with the perfect cabana in the large back yard

Long hot summer days relaxing outside enjoying the views, swimming in the pool or living life with the family and friends entertaining the days away. Large secure yard for the kids to run, vegetable garden and room for the shed!

- Car Parking

Double garage with internal access and large wide driveway for off street parking.

- Bonus Country club

Fabulous function room, bar & Kitchen, (2 free bookings per year) plus air-conditioned gym and pool. BBQ's to cook up the yummy snag or burger to keep the "h-angers" at bay after doing the morning laps or feed the family!! . Enjoy the park, playgrounds or a gentle stroll around the lake....

Opportunities like this do not come along to often. On first inspection you will fall in love, country living and the lifestyle of many dreams.

4 BED | 2 BATH | 2 CAR

PRICE:

\$1,020,000

OPEN FOR INSPECTION:

N/A



**Mel Ahearn**

**0409183763**

mahearn@atrealty.com.au

[atrealtypropertysalesgippsland.com.au](http://atrealtypropertysalesgippsland.com.au)



FLOOR PLAN

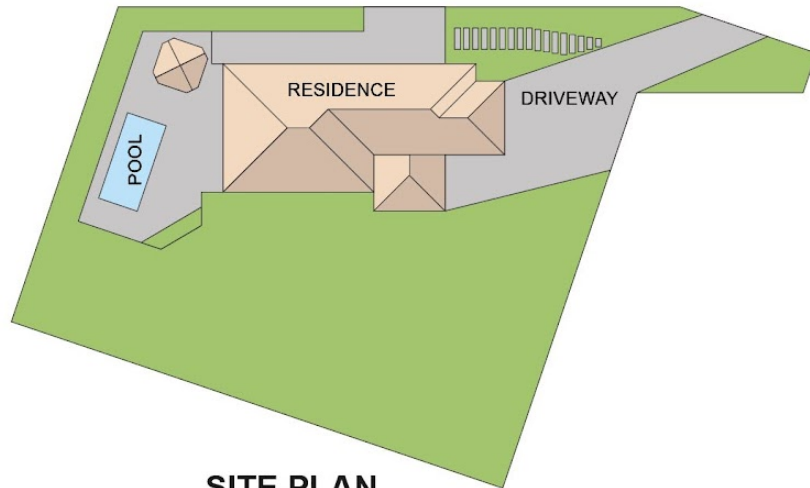

SITE PLAN

## 18 SLOANE SQUARE, DROUIN

Disclaimer: Floorplan is for illustration only, prospective purchasers are advised to make their own enquiries.



Disclaimer: Please note this floor plan is for marketing purposes and is to be used as a guide only. All dimensions are estimates only and may not be exact measurements.