



**SOLD**

## LOWSET VILLA, SECURE GATED COMPLEX PERFECT FOR AN INVESTOR, FIRST HOME BUYER OR RETIREE !!

This popular lowset villa is suitable for individuals, couples or smaller families of any age group and will appeal to owner occupiers or investors.

Enter into this generous open-plan villa / dining area with air conditioner, electric cooktop and oven, dishwasher and tiled living area. Three built in bedrooms all have ceiling fans, master comes complete with an en suite. The main bathroom also comes with a full size bathtub and shower. Good sized backyard great and secure place for kids to play

Secure gated resort style complex with CCTV, four beautiful salt water swimming pools (one heated), two tennis courts, 3 x BBQ picnic areas, all situated inside this beautifully presented secure gated complex.

Offering the convenience of location, only walking distance to the Strathpine train station, local friendly parks and short drive to local state & private schools, shopping centre and golf course.

4 swimming pools, (1 heated for those early morning starts or cooler nights!)

- 2 tennis courts with lights
- 3 undercover BBQ entertaining area
- 6 barbeque picnic shelters with tables
- gated community
- on site manager
- a comprehensive security system

Body Corp \$3,800 approx.  
Rent pw potential - \$380pw

PLEASE NOTE: Photos used for marketing purposes only and are an indicative only. The photography is of a different villa with the complex, same floor plan, and kitchen.

**3 BED | 2 BATH | 1 CAR**

**PRICE:**  
\$360,000

**OPEN FOR INSPECTION:**  
N/A



**Karen Moke**  
**0406521370**

karenmoke@atrealty.com.au  
[www.atrealty.com.au](http://www.atrealty.com.au)

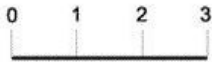
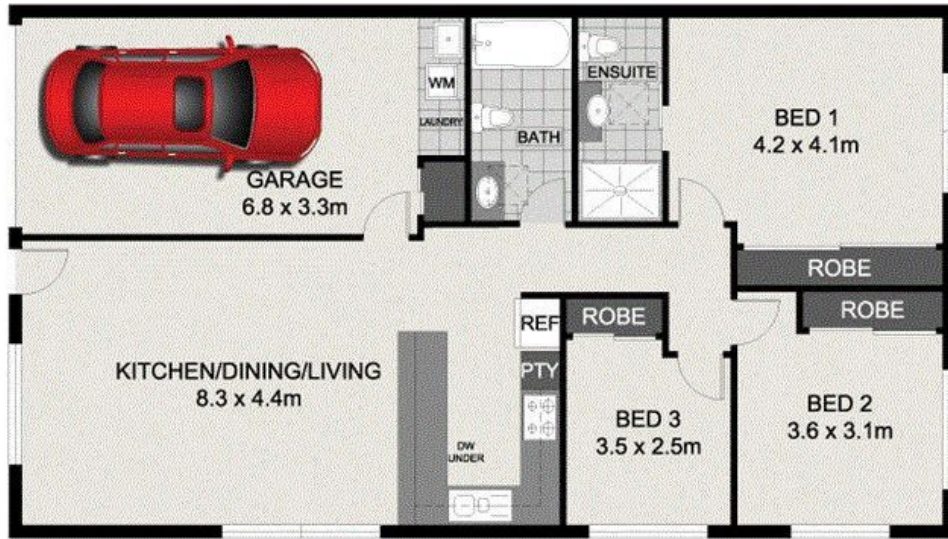

Scale in metres, indicative only. Dimensions are approximate. All information contained herein is gathered from sources we believe to be reliable. However, we cannot guarantee its accuracy and interested persons should rely on their own enquiries.

INT	:	89.65m <sup>2</sup>
GARAGE	:	21.26m <sup>2</sup>
TOTAL	:	110.91m <sup>2</sup>

**2 Nicol Way, Brendale**

Disclaimer: Please note this floor plan is for marketing purposes and is to be used as a guide only. All dimensions are estimates only and may not be exact measurements.