



**SOLD**

## PRIVATE ACREAGE LIVING IN A FAMILY FRIENDLY COMMUNITY

Situated in Pullenvale's prestigious Woodcrest Estate, this beautiful family home is on a stunning elevated corner position with fully useable land offering something for all of the family.

Facing north and surrounded by verandas that take in the summer breezes, big skies and sunsets, the versatile home has a flexible layout that is all on one level, with easy access to the garden, pool and garage.

The large kitchen and living areas open onto a rear veranda that overlooks the pool, seamlessly joining the indoor/outdoor areas giving the perfect space for entertaining. The private back yard includes a large pet-safe fenced area with cubby-house.

This supportive and safe community within walking distance of Pullenvale Marketplace has easy access to highly regarded primary and secondary schools, pony clubs and equine agistment services, bushwalking trails, and various sporting facilities.

Here you can find everything you might want in a tree-change, with the convenience of being only 15km from the Brisbane CBD.

### Features Include:

- 5 spacious bedrooms, including
  - o master bedroom with ensuite and adjacent office
  - o one with its own bathroom, living area and kitchenette making an ideal private area for grandparents, visiting relatives, or older children
- 3 bathrooms
- Large kitchen with gas cooktop and breakfast bar
- Generous walk-in-pantry, providing an abundance of storage
- Home office overlooking the gardens and beyond
- Verandas front and back with horizon views over the treetops
- Salt-water pool with waterfall feature
- Ducted air conditioning, high ceilings, screened doors and windows
- Extra-large double garage with room for a workbench and storage
- Immaculate established low maintenance gardens

**5 BED | 3 BATH | 2 CAR**

**PRICE:**  
\$2,000,000

**OPEN FOR INSPECTION:**  
N/A



**Patti Harriss**  
**0418786696**  
patti@atrealty.com.au  
[www.atrealty.com.au](http://www.atrealty.com.au)

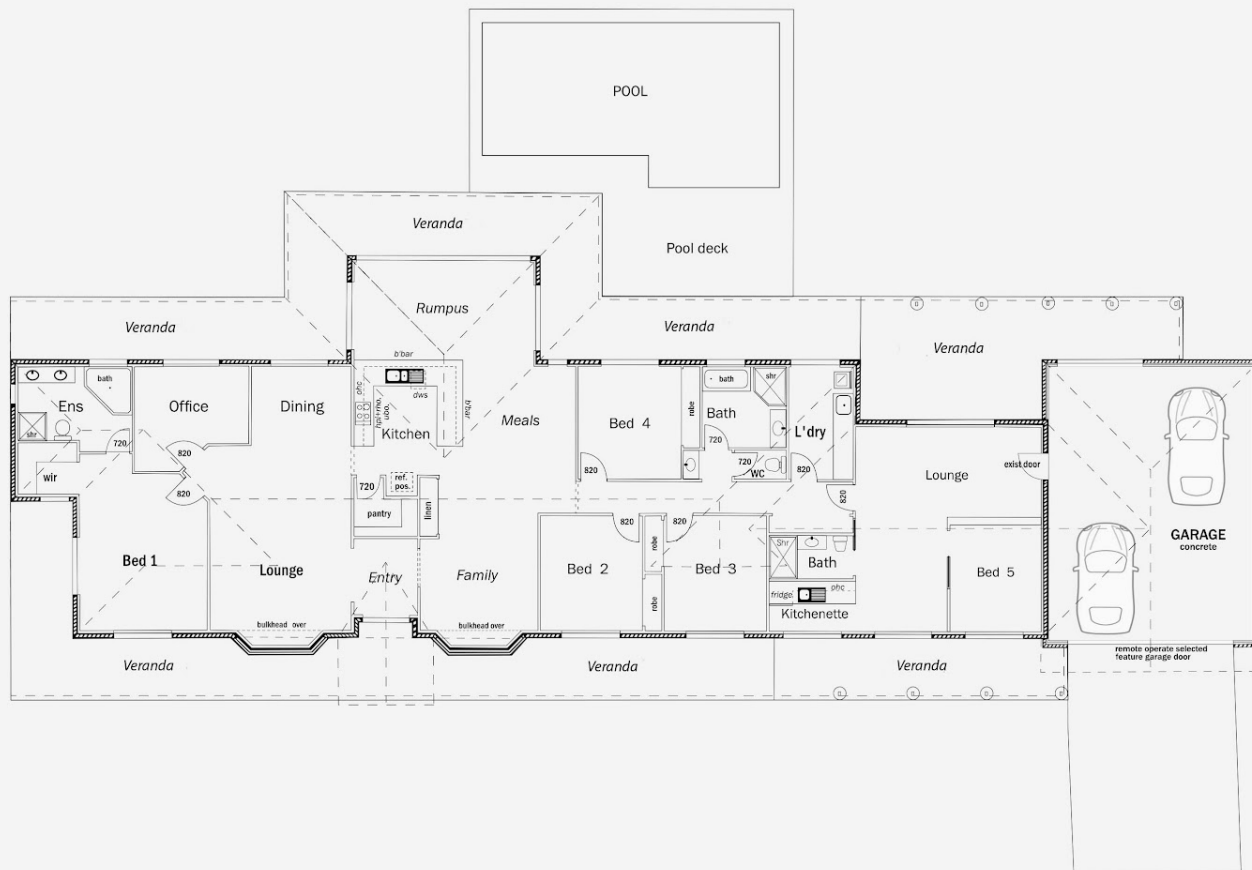

Disclaimer: Please note this floor plan is for marketing purposes and is to be used as a guide only. All dimensions are estimates only and may not be exact measurements.