



SOLD

EVERYTHING A BEACH HOUSE SHOULD BE

For over 50 High Res Photos, Videos & 3D Tours visit the dedicated property website at 94anglers.com

This beautiful light-filled coastal retreat invites a warm coastal welcome for a new family to move in and enjoy straight away.

All the hard work here has been done for you, leaving an extremely liveable and spacious property with amazing outdoor spaces, coupled with many unique features that work together to create a very desirable environment - perfect for enjoying all that Cape Paterson has to offer.

Large open plan living leads out to a glorious north facing deck and landscaped gardens featuring alfresco entertaining areas and both a 'He' and a 'She' shed - one currently used as an office / art studio space, the other for very organised tool storage.

You'll LOVE the large well appointed kitchen complete with deep pantry, the four generous double bedrooms all with built in robes, his and her's vanities in the ensuite bathroom and the high quality finishes everywhere you look. It's the small details here though that really impress, from the custom roped boardwalk that links the front of the property to the rear, perfect for sandy toes and surf boards to the storage solutions for all the beach toys.

We'd advise you to act quickly to secure one of the most complete beach houses we've listed...!

4 BED | 2 BATH | 2 CAR

PRICE:
\$948,000

OPEN FOR INSPECTION:
N/A



Leo Edwards
0472523445
leo@atrealty.com.au
www.atrealty.com.au

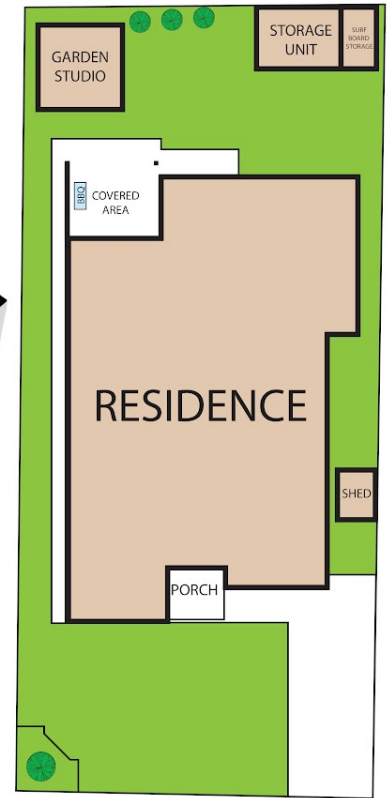

94 Anglers Road, Cape Paterson 3995

TOTAL APPROX. FLOOR AREA 141 SQ.M

Whilst every attempt has been made to ensure the accuracy of the floor plan contained here, measurements of doors, windows, rooms and any other items are approximate and no responsibility is taken for any error, omission, or misstatement. This plan is for illustrative purposes only and should be used as such by any prospective purchasers.

INVERLOCH
REALESTATE

@realty

Disclaimer: Please note this floor plan is for marketing purposes and is to be used as a guide only. All dimensions are estimates only and may not be exact measurements.

Leo Edwards
0472523445
leo@atrealty.com.au
www.atrealty.com.au

@realty