



SOLD

SOLD BY ROBYN HUNT REAL ESTATE

Set on a level block, in a convenient location in East Lismore, this is a property that has room for everyone. Freshly painted inside, and featuring beautiful timber floor boards and high ceilings right through, the home is vacant and ready for a new family to call it their own.

Flooded with natural light, the open floor plan seamlessly connects the living, dining, and kitchen areas. Reverse-cycle air-conditioning in this space ensures a comfortable temperature here all year 'round.

The main bedroom is huge, and features large windows that perfectly capture summer breezes that flow through the home. The remaining 3 bedrooms all enjoy the convenience of built-in wardrobes.

Two generous bathrooms complete the picture upstairs, and ensure the morning rush of a modern family is made that much easier.

Fully fenced, the backyard offers a brilliant area for kids and pets to run around and play. Entertaining here is easy, with the covered outdoor entertainment area including a floating deck that presents the ideal place to host a BBQ or nibbles.

With plenty of room for a market garden, and decent side access, there's even space left over for the caravan, boat AND trailer!

Vinyl cladding ensures maintenance is made easier, and the huge concreted downstairs area (which requires a little work to the floor) provides a great option for the home handyman or tradie to have loads of storage and workspace. Access here is made easy by the remote controlled garage door.

The icing on the cake is the ease of being close to local amenities - with a short walk to the East Lismore Bowling Club, Lismore Golf Club, Southern Cross University, your choice of Primary and High Schools, sporting fields, and much more.

So why wait? Don't miss out on the opportunity to make this property yours. Contact Robyn Hunt today on 0448 448 758 to arrange your inspection.

4 BED | 2 BATH | 5 CAR

PRICE:
\$520,000

OPEN FOR INSPECTION:
N/A



Robyn Hunt
0448448758
robyn@atrealty.com.au
www.atrealty.com.au



GROUND FLOOR



UPPER FLOOR

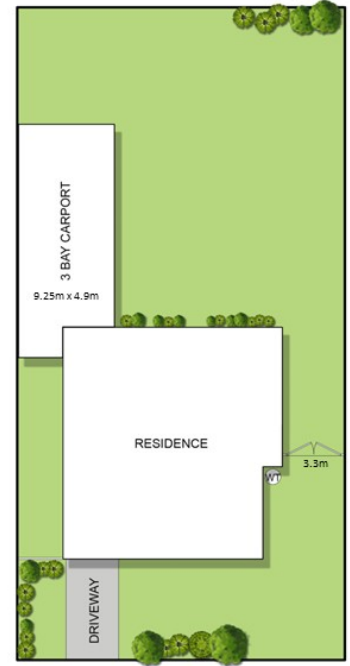

SITE PLAN

This floor plan including furniture, fixture measurements and dimensions are approximate and for illustrative purposes only.
@realty gives no guarantee, warranty or representation as to the accuracy and layout.

18 Walker Street, East Lismore

4 2 5 556m²

Disclaimer: Please note this floor plan is for marketing purposes and is to be used as a guide only. All dimensions are estimates only and may not be exact measurements.