

SOLD

A SPECTACULAR LEVEL OF FAMILY LIVING...

Only 2 years young and ready for its new clan, this home is high on the family comforts and will tick all the boxes!

From the moment, you step in your greeted by a stunning entrance that abuts the large king size bedroom with walk in robe and ensuite. To the other side is a generous garage with abundance of storage and internal access. The three remaining queen sized bedrooms are in a separate wing, all with large built in robes and are serviced by the main bathroom and separate toilet. No overcrowding in this home with a separate large theatre room AND open family living for when extra guests call around.

The well-appointed open plan kitchen will delight chefs of any standard. Functional, stylish and complete with loads of bench space, storage, quality appliances including electric oven and gas cook top, stainless steel dishwasher and butler's pantry making entertaining a breeze.

The family room seamlessly steps out through the bi-fold doors to the alfresco. The outdoor living is complete with built in BBQ and great bench space, landscaped gardens, garden shed, and "the 6x 9m Shed".

With large double gates, providing side access to the shed with a built in workshop/ storage and complete with wood heater for the Mancave and fridge for the refreshments! Plus room for a car. 8 Link Street is approx... 34sq of luxury with additional features include double glazed windows, high ceilings and door heights, ducted heating & cooling, Bosh appliances, plenty of storage, remote doors to garage, and internal access. Side access with double gates to back yard and shed.

This property is sure to impress, so be quick to inspect, as it will not last long!

4 BED | 2 BATH | 3 CAR

PRICE:
\$720,000

OPEN FOR INSPECTION:
N/A



Mel Ahearn
0409183763

mahearn@atrealty.com.au

atrealtypropertysalesgippsland.com.au



FLOOR PLAN

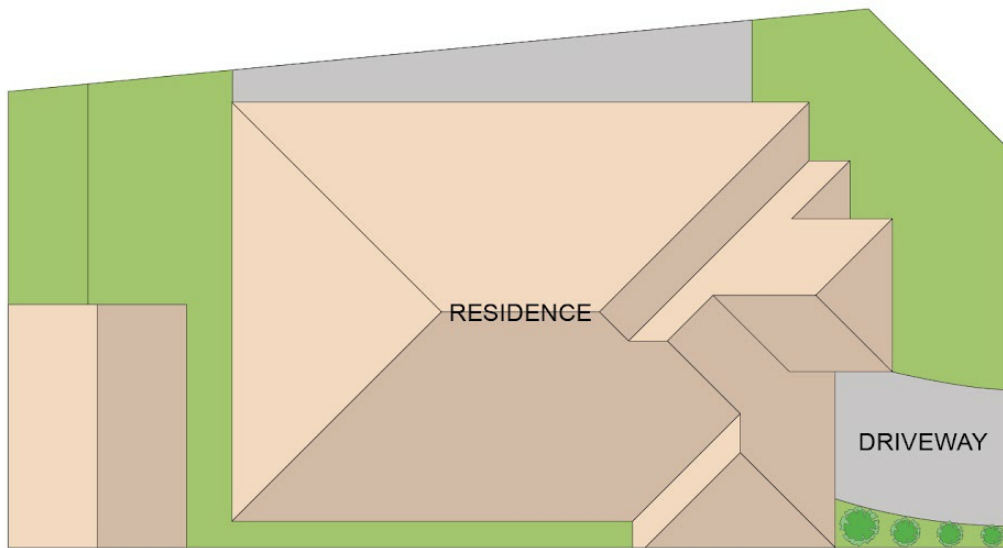

SITE PLAN

8 LINK STREET, NEWBOROUGH

Disclaimer: Floorplan is for illustration only, prospective purchasers are advised to make their own enquiries.



Disclaimer: Please note this floor plan is for marketing purposes and is to be used as a guide only. All dimensions are estimates only and may not be exact measurements.