



**SOLD**

## EVERY GOLFERS DREAM WITH SPECTACULAR, ELEVATED VIEWS ACROSS THE 11TH FAIRWAY

- > Torrens title architect designed bungalow located within the exclusive "Pacific Dunes" residential estate
- > The original estate show-home offering many unique features
- > Pacific Dunes World Class Golf Course - ranked #26 by Golf Australia
- > Prestigious property 4 bedrooms with fans, air conditioning, built ins and ample storage throughout
- > Spacious open plan gourmet Kitchen boasting a 4m white stone bench-top with 2 sun drenched large skylights
- > Three contemporary Living Areas, 2 internal and 1 outdoor located in the central courtyard of the home
- > All three living areas can be completely opened up to enjoy the coastal breeze and bask in the unprecedented open plan space
- > Two spacious luxurious bathrooms including a spa bath ready to indulge in a lazy champagne soak
- > Gargantuan Three metre High ceilings with modern negative detail throughout property
- > Two parking integral double plus golf buggy garage with remote door with additional 2 parking spaces in driveway
- > Two patio living areas front & Rear featuring covered pergolas to absorb the views, whatever the weather
- > Security windows and sliding doors with top quality "Crim safe" security panels.

- > Full access to the Pacific Dunes impressive list of facilities - Residential 25m pool with showers, changing facilities & shallow end for toddlers adjacent to bar and snack facilities
- Secluded forest walkways to walk, cycle and enjoy
- Clubhouse is home to the Award winning "Greenhouse Eatery Restaurant" Bar and golfers Pro shop
- Children's "state of the art" "Angophora" play park
- Double tennis courts
- Maintenance of facilities including pool, tennis courts, play-park, walkways and roadside grass inclusive of a modest fee

4 BED | 2 BATH | 4 CAR

PRICE:  
\$977,500

OPEN FOR INSPECTION:  
N/A



**Tony Hoare**  
**0432144148**  
tonyhoare@atrealty.com.au  
[www.atrealty.com.au](http://www.atrealty.com.au)

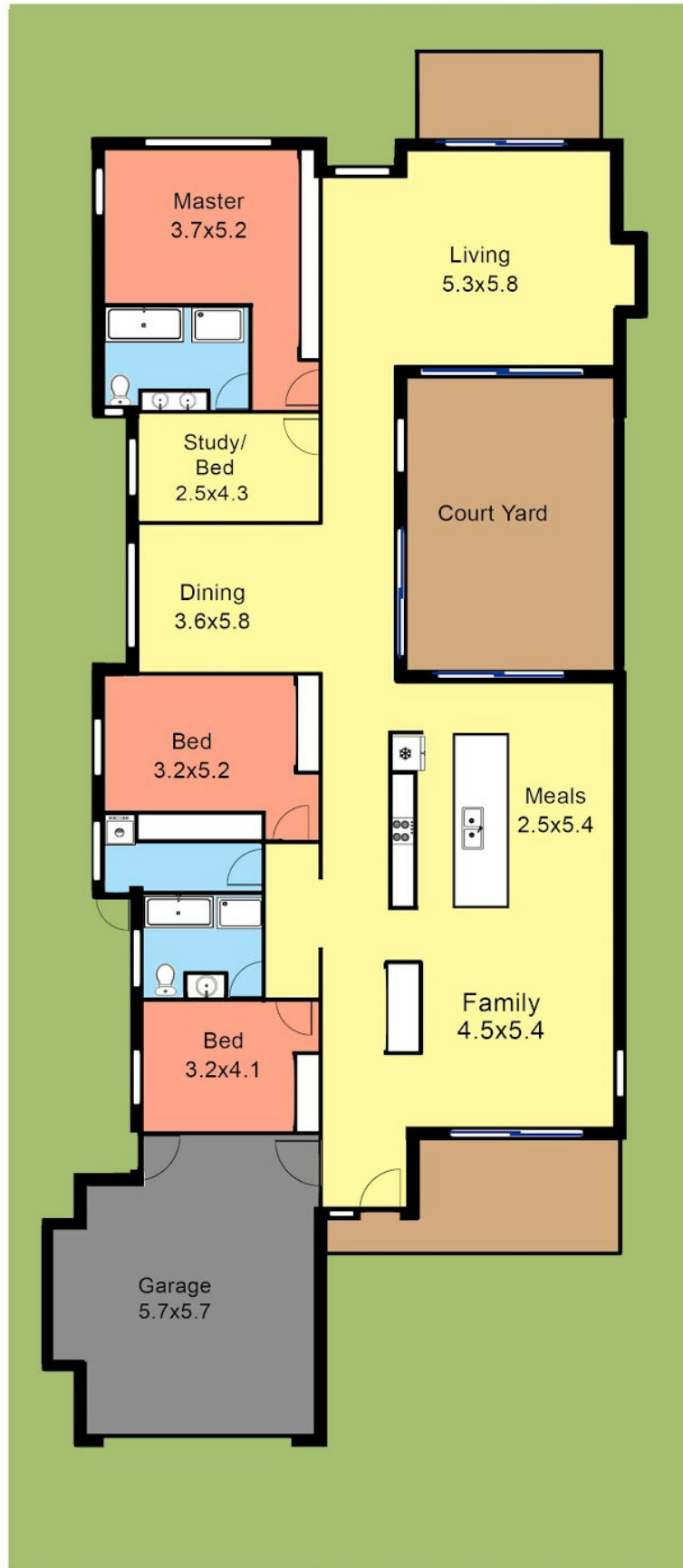

Disclaimer: Please note this floor plan is for marketing purposes and is to be used as a guide only. All dimensions are estimates only and may not be exact measurements.