

**SOLD**

**LOOKING FOR UNIQUE? WELL, THIS IS STYLISHLY UNIQUE WITH A DASH OF UNBELIEVABLE!**

About 9km out of Ravenshoe, the property greets you with an electronic gate, down the Mango tree-lined driveway opening into the privately placed, Architecturally designed steel framed color-bond home. This home packs a "WOW factor"- Down to Earth Realty/@realty proudly presents, Billabong House!

This is a 4 bedroom house with 3 above, and the 4th bedroom/ Granny Flat below, All bedrooms have their own ensuite! All of this then connects to the Studio via a boardwalk pathway.

This property is distinct in character with lots of potential, let your imagination decide, Air BnB? Individual letting, holiday home, or private large family living? This architecturally designed house has an interior designer's touch, offering open plan living, everywhere... Open all the doors on a warm day and let the breeze drift through, it is really cool, light, and bright, but if you want cold, then shut it all up and let the split air-cons do their job.

Is there a "Studio" type in the family? Well, there is a timber walkway that shows off a neat studio room with its own balcony and privacy to jam on your favorite musical instrument. With its own water tank, you could separate this into its own residence by adding a shower and toilet, like the rest of this property, everything is customisable with some inventive thought...

An orchard of Mango trees can provide a surplus income and the rest of the property is mowed around a multitude of different Eucalyptus trees, perfect for your furry friends and children to enjoy.

Get into the virtual tour to confirm what I have just said, there is also an option to "View in VR" (Using Virtual Reality goggles), also check out the Video to get that perspective on the property, there is also a floorplan, so you can really get the picture with all the tools presented for your convenience.

For something a little bit special, don't let this one slip by, give Vikki a call today to organise a viewing, call 0472 910 300...

**4 BED | 4 BATH | 4 CAR**

**PRICE:**  
\$550,000

**OPEN FOR INSPECTION:**  
N/A



**Vikki Burnett**  
**0472910300**  
vikki@atrealty.com.au  
[www.atrealty.com.au](http://www.atrealty.com.au)

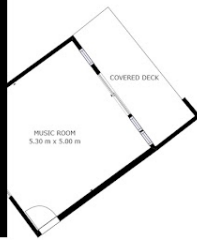

GROSS INTERNAL AREA  
FLOOR 1: 22 m<sup>2</sup>, FLOOR 2: 175 m<sup>2</sup>  
EXCLUDED AREAS: , PATIO: 90 m<sup>2</sup>  
BALCONY: 12 m<sup>2</sup>, DECK: 160 m<sup>2</sup>  
TOTAL: 197 m<sup>2</sup>  
SIZES AND DIMENSIONS ARE APPROXIMATE, ACTUAL MAY VARY.

FLOOR 2



Disclaimer: Please note this floor plan is for marketing purposes and is to be used as a guide only. All dimensions are estimates only and may not be exact measurements.

Vikki Burnett  
0472910300  
vikki@atrealty.com.au  
[www.atrealty.com.au](http://www.atrealty.com.au)

