



**SOLD**

## MIAMI MAGIC

First time on the market in 35 years is this perfectly positioned spacious family home in original yet move in condition. Spread out over two levels, there are family/lounge rooms both upper and lower with the upper having 2 balconies. The first floor has the first and second bedrooms with the main furnished with an ensuite and walk in robe. The ground has bedrooms three and four situated away from the living area. The galley kitchen has generous storage, a pantry, and looks out over the family and dining areas. The double garage has access to the family area and a rear door to the pool and back yard.

Miami is situated centrally on the Gold Coast granting access to all areas of the city in any direction including the beach which is only minutes away just across the Gold Coast Highway. On the highway there are Aldi and Coles and local shopping.

- 4 Bedroom
- 2 Bathroom
- Main bathroom plus ensuite to main bedroom
- Galley kitchen
- Upper and lower family/lounge rooms
- Laundry with direct outside access
- Double garage
- Garden shed
- Water tank
- Inground pool
- Fully fenced side and back yards
- Solar system

Don't miss out on your chance to live this close to the beach, email your interest now to be kept updated on inspection availability.

Inspection by appointment or at open house.

**4 BED | 2 BATH | 2 CAR**

**PRICE:**  
\$1,525,000

**OPEN FOR INSPECTION:**  
N/A



**Tony Brown**  
**0418961500**  
tonybrown@atrealty.com.au  
[www.atrealty.com.au](http://www.atrealty.com.au)



GROUND FLOOR

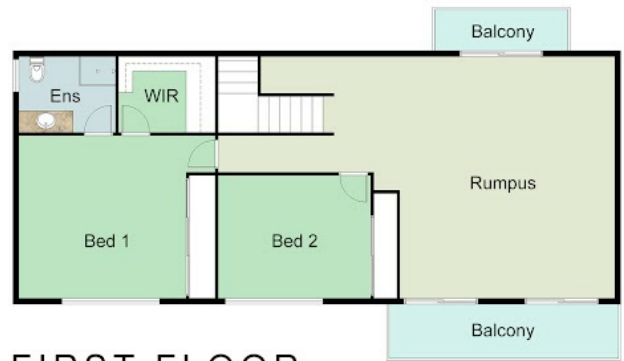

FIRST FLOOR



Disclaimer: Please note this floor plan is for marketing purposes and is to be used as a guide only. All dimensions are estimates only and may not be exact measurements.

This floor plan including furniture, fixture measurements and dimensions are approximate and for illustrative purposes only. BoxBrownie.com gives no guarantee, warranty or representation as to the accuracy and layout. All enquiries must be directed to the agent, vendor or party representing this floor plan.