



SOLD

SOLD! BY J CHENNEY!

SORRY! YOU MISSED OUT!

SOLD BY J CHENNEY!

Multiple offers submitted by Eastern state buyers

Suitable for savvy investors or developer!

Build a huge home? Subdivide for profit? Land bank? Nest egg?

You decide!

Massive 20,200m² land size
(Approx. 42 lots subdivision. Subject to normal council and WAPC approval)

Thank you for viewing another quality listing by John Chenney from @atrealty. It is with my great pleasure to introduce this well located vacant land, titled and ready for application to build or subdivide.
(Subject to normal council/WAPC application approval)

Are you struggling for space? Want a pony in your backyard?

This land is located in the heart of Harrisdale ! Easy access to Nicholson road/Ranford Road/Tokin highway. Suitable for anyone looking for a large backyard or builders/developers for future subdivision development.

The R-zone is currently final adoption of amendment 121 by City of Armadale under "Urban development" at State Level (in WA). Pending and ready for local council application for an approved structure plan!

Features you will love:
-20,000m²+ land (Approx. 42 lots subject to normal WAPC and council approval)

0 BED | 0 BATH | 0 CAR

PRICE:
\$1,550,000

OPEN FOR INSPECTION:
N/A



John Chenney
0421030398
jchenney@atrealty.com.au
www.atrealty.com.au

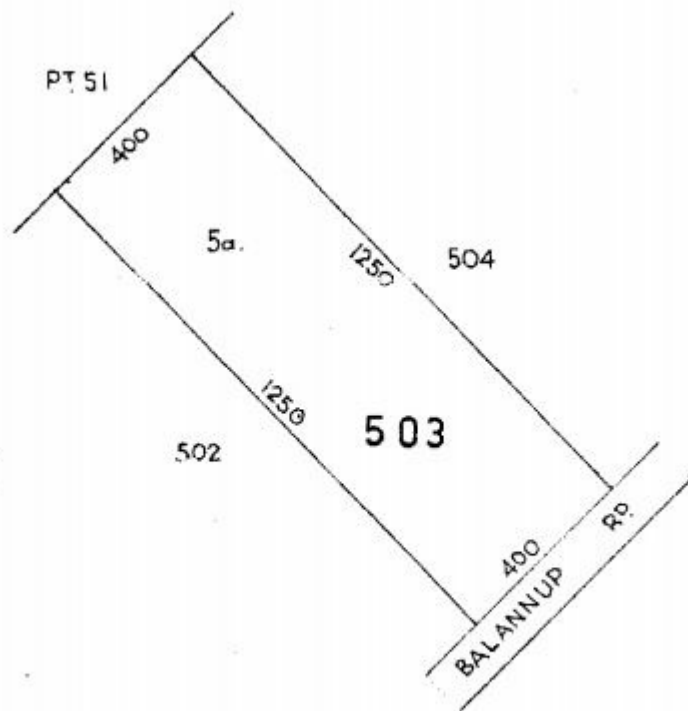

lines to an inch
341A/40 c.l.

Disclaimer: Please note this floor plan is for marketing purposes and is to be used as a guide only. All dimensions are estimates only and may not be exact measurements.