

11 PANORAMA CRESCENT, NORMANVILLE, SA, 5204



SOLD

WHERE THE HILLS MEET THE OCEAN - A SPECTACULAR HOME IN A TRULY BEAUTIFUL LOCATION

Perfectly positioned on the apex of a hill in the highly sought after Normanville Heights, this stunning property has undergone significant upgrades and the results are truly amazing. Featuring five bedrooms, two living areas as well as three outdoor entertainment areas including two decks, this new and improved version with its versatile lifestyle choices will appeal to multiple buyer groups. These improvements include expansive retaining walls facilitating the creation of a gorgeous lawn area to the front of the property, a new caravan pad as well as a private landscaped garden to the rear of the home. Other additions include plush carpets to the lower level bedrooms and hallway, window dressings, security screens for doors and windows, window shutters, external security lighting, internal and external light fittings, zip-track blinds to the upper deck as well as new lighting to the kitchen area. The home has also been painted throughout and the expansive shed has also been lined and would make a great workshop and/or storage area. Come with us as we introduce you to this lovely family home.

Lower level:

- * Open plan living/dining and kitchen area filled with natural light and boasting magnificent views from every window
- * Recently updated kitchen with induction cooktop, integrated Bosch dishwasher, stainless steel range hood and electric oven
- * Walk-in pantry, 2-Pac joinery and a huge breakfast bar are added bonuses
- * Recently built deck creating a natural extension from the dining area, the perfect spot to enjoy those amazing sunsets
- * Four generous bedrooms, all newly carpeted – one that has recently been extended to include a walk-in robe, two with built-in robes and one with a study nook
- * Spacious laundry with lots of bench and storage space and external access
- * Recently renovated family bathroom with gorgeous vanity, free standing bath and shower – separate renovated WC
- * Expansive outdoor under-cover area, perfect for year-round entertaining that flows onto the newly created lawn area
- * Large carport that can easily accommodate up to four vehicles
- * 9x6m powered shed, workshop, or man-cave to the rear of the property and a garden shed

5 BED | 2 BATH | 4 CAR

PRICE:
\$815,000

OPEN FOR INSPECTION:
N/A



Gerry & Kathy McGuinness
0410531305
teammac@atrealty.com.au
www.atrealty.com.au
RLA: 269823

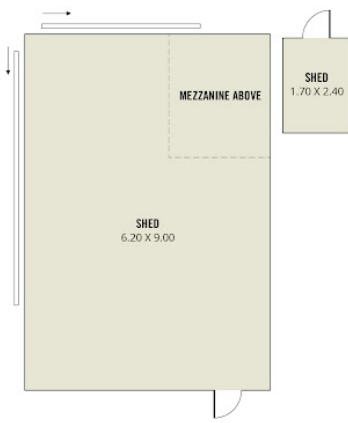

- 553m²**
TOTAL
- 232m²
Living
- 60m²
Shed
- 66m²
Carport
- 3m²
Porch
- 91m²
Outdoor Entertaining
- 101m²
Deck/ Pergola



Scale in metres. This drawing is for illustration purposes only. All measurements are approximate and details intended to be relied upon should be independently verified.

Produced by The Fotobase Group

Disclaimer: Please note this floor plan is for marketing purposes and is to be used as a guide only. All dimensions are estimates only and may not be exact measurements.

Gerry & Kathy McGuinness
0410531305
 teammac@atrealty.com.au
www.atrealty.com.au

