



FOR SALE

FAMILY HOME WITH BIG BACKYARD, LOCATED A HOP SKIP JUMP TO SCHOOL

This family home is super convenient located only steps to cafes, gym, daycare, and 15 minutes walk to Smithfield State High School. A larger than average 563m² block with huge lush grassy private backyard with plenty of space for a pool/shed, no rear neighbours enjoying a picturesque mountain backdrop.

This very well presented four-bedroom, two-bathroom home offers a fantastic media/lounge area, open plan dining, and kitchen with aspects of the backyard and mountains. The main bathroom has separate shower and bath, the ensuite with large shower. Kitchen appliances include a new stainless-steel Bosch 4 burner gas stove, Bosch oven/rangehood and Blanco dishwasher. Other features include split system air-conditioning and fans throughout, built in wardrobes, double remote lock up garage with extra storage and laundry, fibre optic, instantaneous gas hot water system, recycled water, some energy efficient windows, LED kitchen lights and security screens.

Smithfield Village is a well-designed master planned community where you can enjoy a relaxing life surrounded by nature, parks, playgrounds, bike and walking paths, wetlands and BBQ areas.

Rental appraisal \$550-\$570 per week

4 BED | 2 BATH | 2 CAR

PRICE:

Mid - High \$500,000's

OPEN FOR INSPECTION:

N/A



Zoe Wicks
0477114778

zoewicks@atrealty.com.au

www.atrealty.com.au

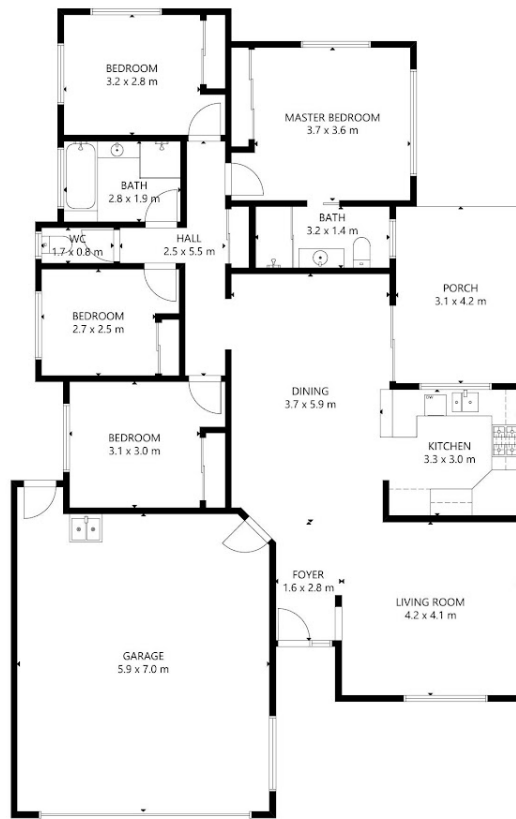

FLOOR 1

GROSS INTERNAL AREA
TOTAL: 122 m²
FLOOR 1: 122 m²
EXCLUDED AREA: PORCH: 13 m², GARAGE: 42 m²
SIZE AND DIMENSIONS ARE APPROXIMATE, ACTUAL MAY VARY.

Zoe Wicks | @realty
Real Estate

Disclaimer: Please note this floor plan is for marketing purposes and is to be used as a guide only. All dimensions are estimates only and may not be exact measurements.