



FOR SALE

LOCATION AND LIFESTYLE

Nestled on a quiet street in Regatta Estate, you will find this spacious and stylish family-friendly home. The sprawling layout has been designed to tick all the boxes with 5 bedrooms and two bathrooms along with multiple living areas and a covered patio where you can entertain guests and enjoy the outside lifestyle.

From the moment you step inside, the expansive floorplan unfolds to reveal an open and light-filled living room with carpet underfoot, a ceiling fan and direct access to the outdoors. Double internal doors allow you to move from the living area through to the open-plan kitchen, dining and family room where split system air-conditioning ensures absolute comfort.

Sweeping benchtops and a good-sized pantry will put a smile on the face of any eager cook complete with stainless steel appliances. Easy clean tile flooring is ready for the hustle and bustle of daily life and there's a ceiling fan over the family room along with a glass sliding door that allows you to move freely out to the covered patio.

You will be the envy of all of your friends with this expansive entertaining area boasting room for a large dining setting and a BBQ. You will love to kick back in the shade and overlook the fenced backyard providing room for the kids to play, space for the family pet and the potential for the green thumb to indulge their passion for gardening.

The master suite comes complete with a walk-in robe and an ensuite with a large spa. The other 4 bedrooms are set in their own section of the home with quick access to the main bathroom with a separate bath, shower and toilet.

There is an abundance of storage throughout, including a linen cupboard, plus a double garage with internal access and storage.

This well-appointed home will not last long so act quickly to secure your inspection.

5 BED | 2 BATH | 2 CAR

PRICE:

\$830,000 - \$850,000

OPEN FOR INSPECTION:

N/A



Peta Thompson

0403123115

petathompson@atrealty.com.au

www.atrealty.com.au

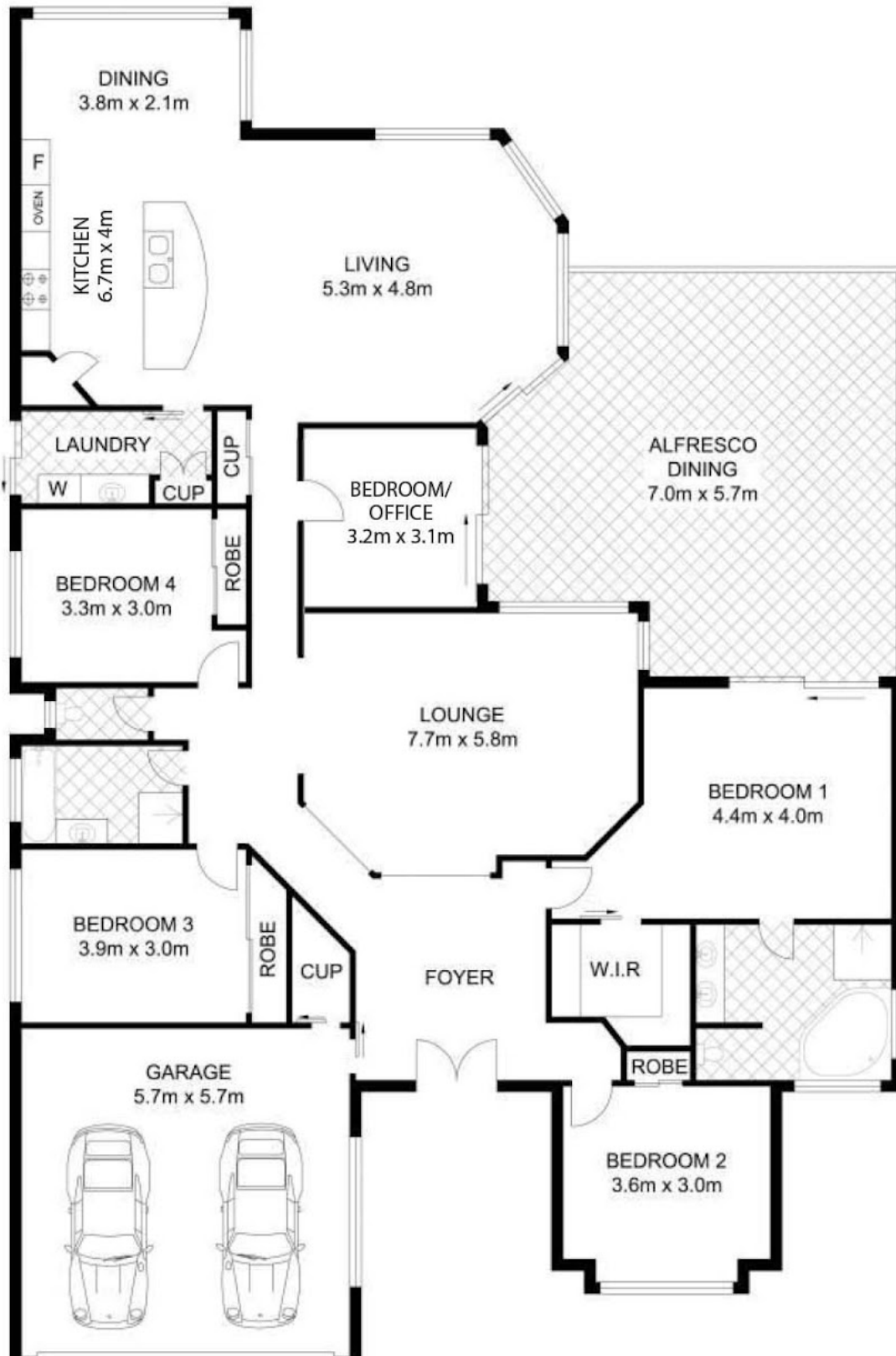

Disclaimer: Please note this floor plan is for marketing purposes and is to be used as a guide only. All dimensions are estimates only and may not be exact measurements.

Peta Thompson 0403 123 115

petathompson@atrealty.com.au

www.atrealty.com.au

Peta Thompson

0403123115

petathompson@atrealty.com.au

www.atrealty.com.au

Disclaimer: Whilst every effort has been made to ensure the accuracy of these particulars, no warranty is given by the vendor or the agent as to their accuracy. Interested parties should not rely on these particulars as representations of fact but must instead satisfy themselves by inspection or otherwise.