



SOLD

JUST SO IMMACULATE IT LOOKS LIKE NEW!!

Immaculately presented throughout, this Ken Johnson Home offers an expansive low-set home resting on a massive 1017 sq metres and makes full use of the level block. The sophisticated design encompasses open plan spaces, seamless indoor / outdoor integration and an intelligent floor plan to create an incredibly family friendly home with all living and bedrooms across a single level. Ducted air-conditioning throughout the home makes living here just so comfortable no matter what it is like on the outside.

Nothing has been done by halves in this amazing Cooloolo Cove property. The kitchen is positioned in the centre of the home with a large centre bench creating the perfect hub to interact with your guests while entertaining. Offering wide open spaces, plenty of bench space and an abundance of cupboards you will feel right at home in this kitchen. This space offers absolute day to day functionality.

The master bedroom is the ultimate parents retreat, generously sized with a large walk in robe and lavish ensuite. Two of the other bedrooms each feature large built in robes and ensure ample accommodation for the growing family and share a very well appointed bathroom.

The glass sliding doors promote air flow and cross ventilation throughout the home while at the same time creating an extra sense of space. These contemporary lines carry through from the true open plan living space to the alfresco entertaining area at the rear adding to the seamless indoor / outdoor transition. Private entertaining will be a breeze with the rear patio being positioned looking across the sparkling inground pool to the flat rear yard that will give the kids and pets plenty of room to play.

Every man loves a shed; well here we have an 8mtr x 8mtr powered colorbond shed with a carport as well.

If this home sounds like the one for you, call Ian or Janelle NOW to arrange for your private inspection of this immaculate property. Here's your chance to own an absolutely impeccable property for way below replacement cost. Be quick. This property is priced below market expectations!

85 Fyshburn Drive, Cooloolo Cove's Features

4 Bedrooms - Main inc Ensuite & 2 with Built-in Robes

4 BED | 2 BATH | 5 CAR

PRICE:
\$727,500

OPEN FOR INSPECTION:
N/A



Ian and Janelle Pye
0437778111
ianpye@atrealty.com.au
www.atrealty.com.au

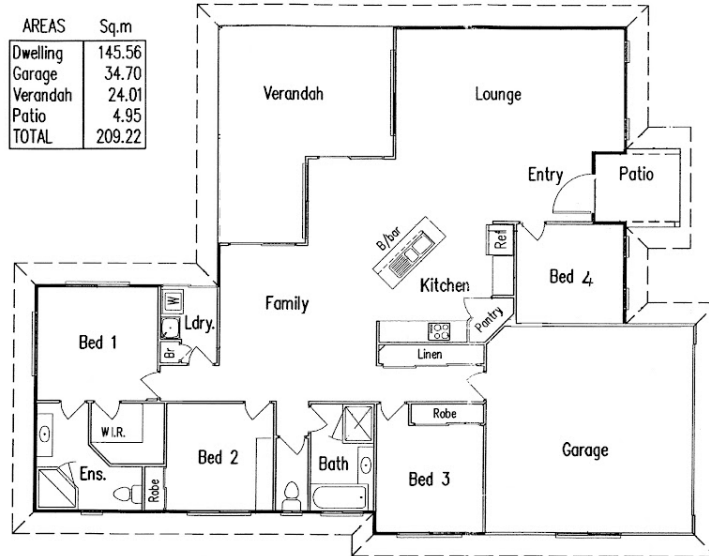

85 Fyshburn Drive, Cooooloola Cove

Disclaimer: Please note this floor plan is for marketing purposes and is to be used as a guide only. All dimensions are estimates only and may not be exact measurements.