

SOLD

QUALITY, LOCATION, PERFECT

This Quality Family home ticks all the Boxes with its great location and perfect presentation. The new owners need only to move in and enjoy.

Located close to St Martins School, Mount Gambier Hospital, and the popular Market place, ideal for the professional and busy family.

The Home was built with quality in mind with Solid inside Walls feature brick outside with High Ceilings, and all set on a large allotment measuring 996 Sq/m at the end of a Quite Cul-de sac.

The Home consists of 4 Bedrooms, all bedrooms with BIR and the main having His and Hers walk through robe to en-suite.

There are ceiling fans in most rooms and Central Ducted gas Heating keeps the home the right temperature all year round.

Formal Lounge at the front of the home is great place to sit and relax or maybe a great place as kids' playroom.

A feature of the home is a large open Kitchen Meals Family Area, just a great space for family to gather. The meals area sits in large bay window with lovely views over the tree line back yard.

Stunning Solid Timber Kitchen with Modern Appliances, breakfast bench and heaps of Cupboard space can handle a large family with ease.

A well-appointed Laundry and second Bathroom completes a functional family Home.

Step out from the family Area and you are greeted to Covered patio area, great for casual living and entertaining. Just off the patio s area you step up to a Bali Inspired Hut, just a fantastic area for the family to unwind and enjoy the beautiful established and Maintained Gardens and Lawns.

A Double Garage UMR with loft and remote doors, at the rear of the Garage is a great Space, currently used as a man cave but could be a 5th Bedroom/Office or Workshop.

Pop up Sprinkles, Garden shed plus single garage workshop, just complete this Classy Family Home.

RLA 269823

4 BED | 2 BATH | 3 CAR

PRICE:
\$503,000

OPEN FOR INSPECTION:
N/A



Peter Dempsey
0418854393
peterdempsey@atrealty.com.au
peterdempseyatrealty.com
RLA: 269823

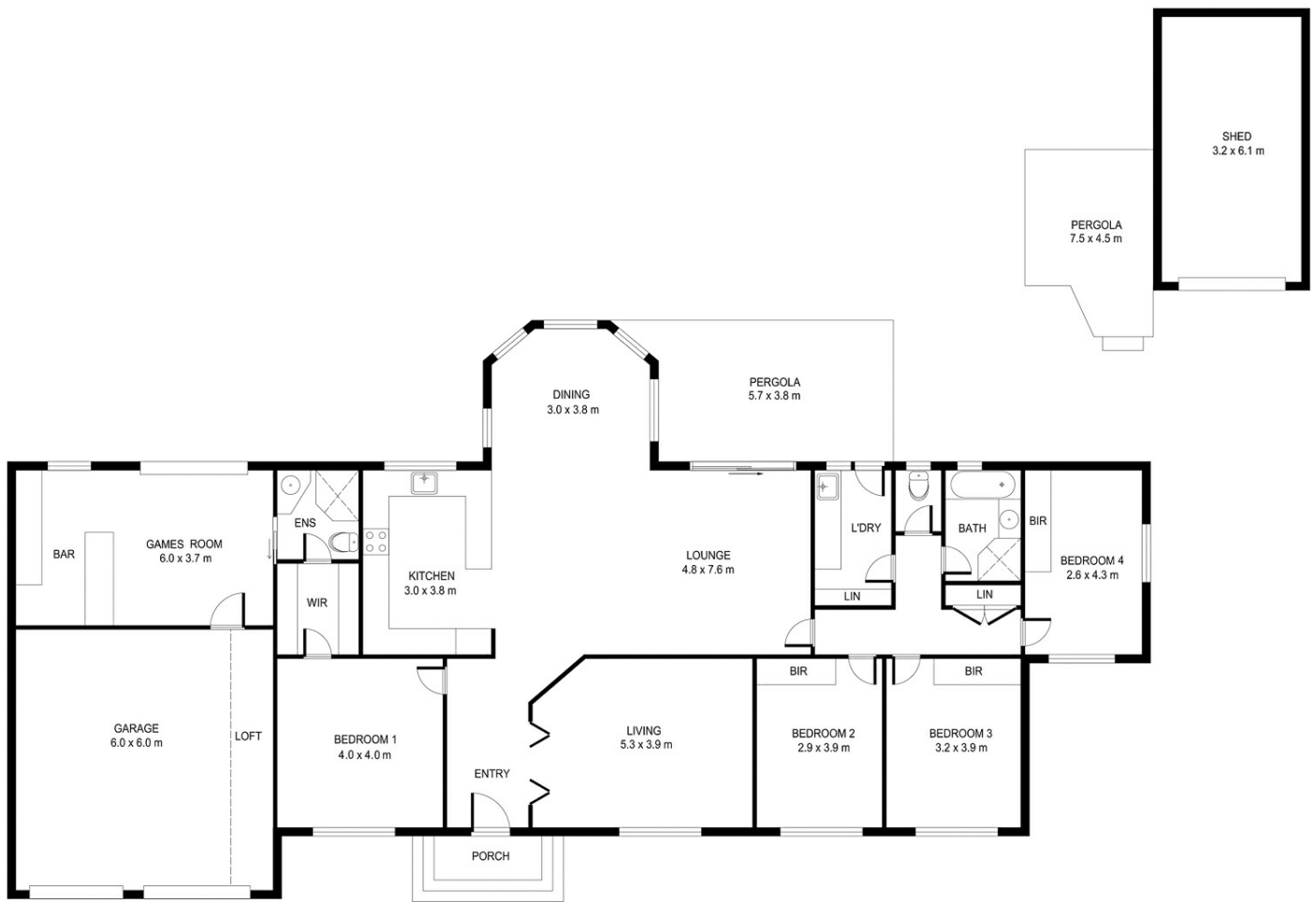

Disclaimer: Floor Plan measurements are approximate and are for illustrative purposes only. While we do not doubt the floor plans accuracy we make no guarantee, warranty or representation as to the accuracy and completeness of the floor plan

Disclaimer: Please note this floor plan is for marketing purposes and is to be used as a guide only. All dimensions are estimates only and may not be exact measurements.