



SOLD

INVESTORS OR FIRST HOME BUYERS.....

Situated in a court location on a large 782m2 block (approx.) is this neat as a pin 3 bedroom home that's sure to please. From the moment you step inside this light, bright and airy property, you will feel right at home.

All three bedrooms have built in robes and are a generous size, and are serviced by a centrally located bathroom. The large kitchen makes entertaining a breeze with a servery to the outdoor area, plenty of cupboard space, a 900mm freestanding S/S oven, built in dishwasher and breakfast bar.

The 2 separate living areas will provide plenty of space for the family. The family room steps seamlessly outside to the large concrete entertaining area.

This property has rear access to the back yard with room for additional cars, boats, or caravans and a bonus large back yard for the kids and pets to run around in.

If you're an investor, the property also lends itself to the possibility of building a second dwelling at the rear (STCA) given its size, whilst earning approx. \$390 to \$410 per week in rental income.

Close to all amenities including school and University, this home will be sure to attract a lot of interest and will be snapped up fast.

3 BED | 1 BATH | 0 CAR

PRICE:
\$389,750

OPEN FOR INSPECTION:
N/A



Jeff Dalzotto
0411601046

jeffd@atrealty.com.au

atrealtypropertysalesgippsland.com.au



FLOOR PLAN

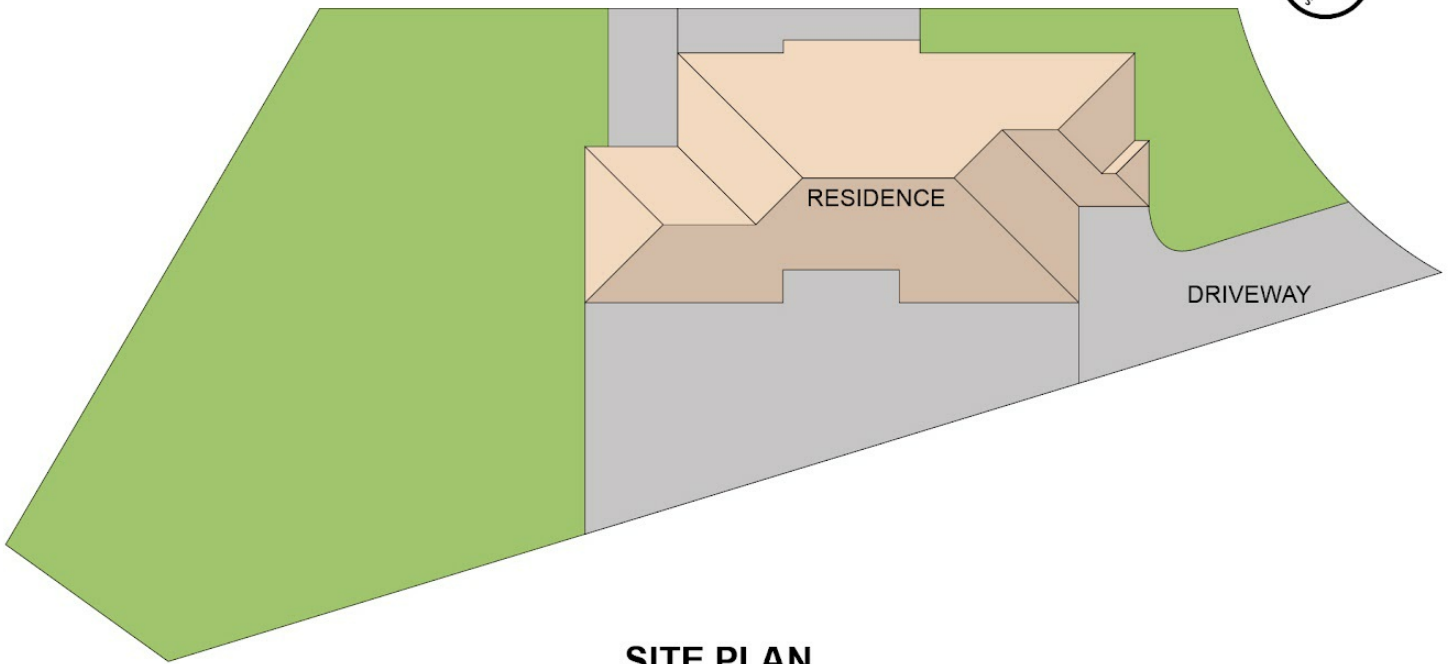

SITE PLAN

3 DALPURA COURT, CHURCHILL

Disclaimer: Floorplan is for illustration only, prospective purchasers are advised to make their own enquiries.



Disclaimer: Please note this floor plan is for marketing purposes and is to be used as a guide only. All dimensions are estimates only and may not be exact measurements.