



FOR SALE

EXECUTIVE LIVING ON THE WATER

This spectacular master-built two storey waterfront 4 bedroom home is built on an 806 sqm block located in one of the most sought after canal locations on the Island and boasts stunning wide water views. The home which was built in 1998 offers a study, flexi-room, open plan kitchen/family and separate lounge/dining area. There are 3 bathrooms and separate toilet with two upstairs bedrooms en-suite with walk-in robes. The master bedroom which is located upstairs has a large veranda overlooking the water.

The home is an entertainer's dream and has also been designed for dual living with a separate kitchenette and living area on the top floor so would be ideal for those with grown up children or extended families.

Fabulous under cover outdoor entertaining area and a 10 metre in-ground pool overlooking the water with breathtaking long water views. For your boat, there is large 10 x 4 metre pontoon fully equipped with power, water and winch with direct access to Pumicestone passage. There is a double garage and a single garage which is also suitable to house a boat.

Look at these extra features:

- Portico entrance
- Security gates to front entrance
- 3.5 kw solar panels
- Security system
- Private outdoor living
- Outdoor shower
- Laundry with hand basin
- Masses of storage

Don't miss out on this spectacular home, give Geoff (your local agent) a call on 0414 230 130 now to arrange your private inspection.

4 BED | 3 BATH | 6 CAR

PRICE:
\$1,095,000

OPEN FOR INSPECTION:
N/A



Geoff and Rose Tutt
0414230130
geoff@atrealty.com.au
www.atrealty.com.au

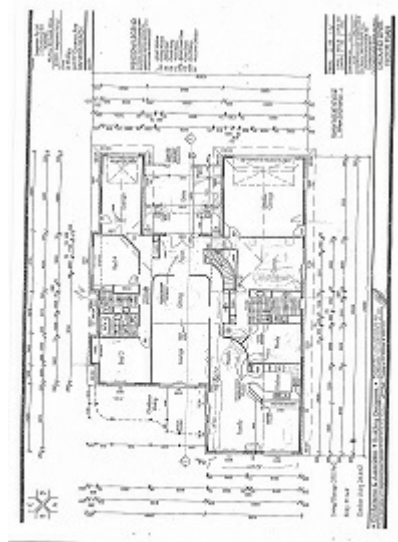

Disclaimer: Please note this floor plan is for marketing purposes and is to be used as a guide only. All dimensions are estimates only and may not be exact measurements.