



FOR SALE

ENJOY BEAUTIFUL SURROUNDINGS CLOSE TO THE BEACH

For sale by Openn Negotiation (flexible conditions online auction). The Openn Negotiation is under way and the property can sell at any time. Contact agent immediately to become qualified and avoid disappointment. Open to all buyers, including finance, subject to seller approval.

This spacious 3 bedroom property is the perfect coastal escape with a fully fenced, fully useable yard in a quiet pocket of Venus bay boasting incredible panoramic views across rural farmland while being only a short walk to the beach.

The home has been recently renovated and includes built in robes to all bedrooms, wood fires in each of the two living areas, floating floors, meals area and modern kitchen with plenty of natural light, and a huge covered deck area perfect to take in those amazing views.

The property also benefits from a raised carport perfect for boat or caravan storage and a large lockable garage / workshop.

If you've been craving a more simpler life, then you'll enjoy spending your weekends here in Venus Bay, or make it a full time move and spend time in the open air, enjoying the beautiful natural views surrounding the property. A quick walk across the road leads to a pristine private beach. For the most, Venus Bay is a quiet town with a mix of permanent and holiday homes in the area. Quality family time can be spent here, quiet streets and community feeling while still being close to a range of shops in both Venus Bay and Tarwin Lower. You can't help but feel relaxed and with nature when here. The natural wildlife at your back door is stunning, with kangaroos, wombats, echidnas, and native birds to see daily.

3 BED | 2 BATH | 4 CAR

PRICE:
Just Listed

OPEN FOR INSPECTION:
N/A



Leo Edwards
0472523445
leo@atrealty.com.au
www.atrealty.com.au

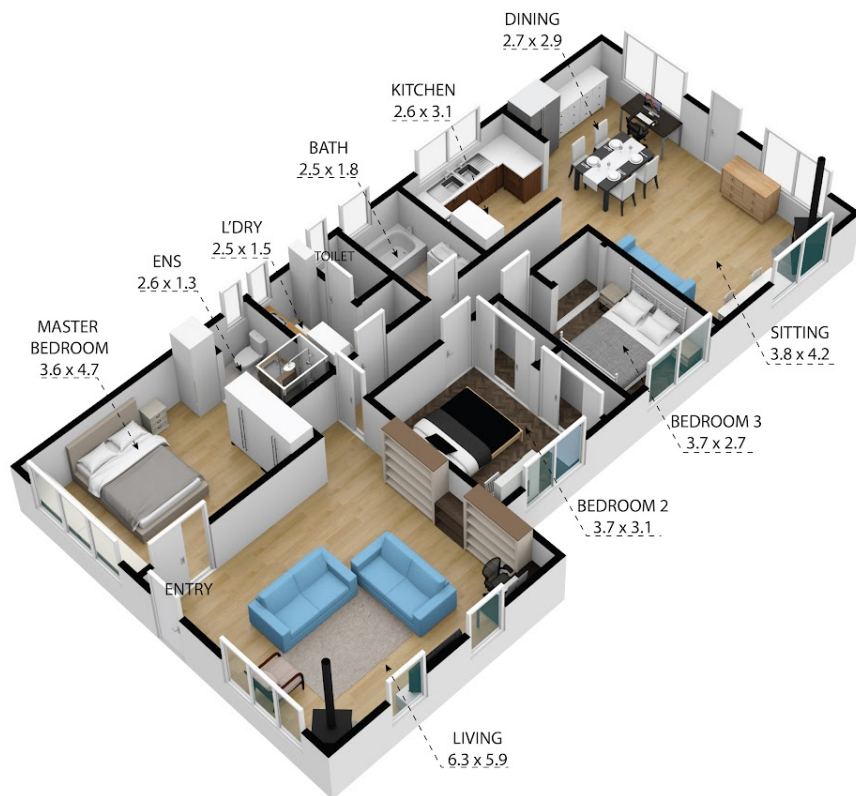

10 Anita Crescent, Venus Bay 3956

TOTAL APPROX. FLOOR AREA 128 SQ.M

Whilst every attempt has been made to ensure the accuracy of the floor plan contained here, measurements of doors, windows, rooms and any other items are approximate and no responsibility is taken for any error, omission, or misstatement. This plan is for illustrative purposes only and should be used as such by any prospective purchaser.

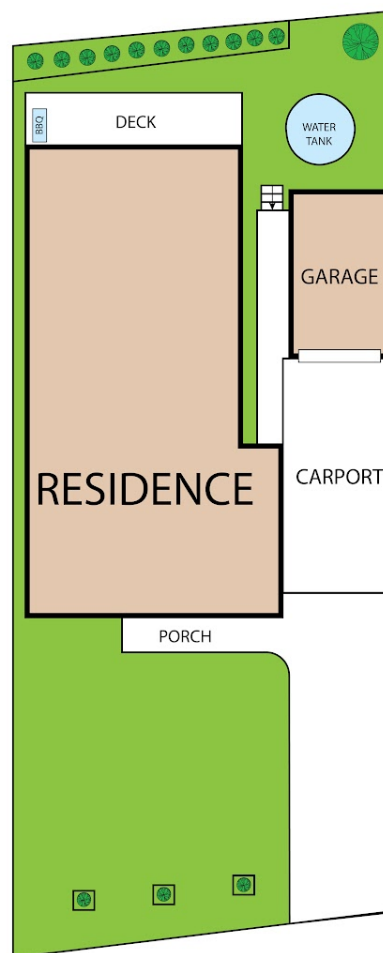

INVERLOCH
REALTY

@realty

Disclaimer: Please note this floor plan is for marketing purposes and is to be used as a guide only. All dimensions are estimates only and may not be exact measurements.