



SOLD

PRIVATE AND PEACEFUL

Contact your local Agent Tricia 0457 314 206

Situated at the end of a quiet street on a large block of 1100m2 in a stunning part of the world at Onkaparinga Hills.

Enter the home through the separate entrance. There is a massive lounge at the front of the home that could be utilized for a multitude of circumstances, lounge, media room, 4th bedroom, games room or office. Boasting 3 bedrooms, the master bedroom with walk-in robe has direct access to the larger than normal 2 way bathroom. Bedrooms 2 and 3 have built in robes for good storage. A Centrally located kitchen is the heart of the home adjacent to the family room and dining area with views to the rear garden. A second bathroom and internal access to the garage is a bonus.

Head outside into a fantastic large undercover outdoor entertaining area with blinds and low maintenance garden backing on to hill face zoning for peace and privacy. At the back of the yard you will find raised garden beds, established fruit trees with plenty of space for the kids to play. A Second carport with roller door and high ceiling for the extra cars or toys and a shed/ work shop.

Property features:

- Master suite with 2 way bathroom.
- 2 living areas
- Centrally located kitchen.
- Large block of 1100 m2app
- Large outdoor undercover entertaining.
- Gas heating.
- Evaporative air-conditioning 2 years young
- Large shed/ work shop.
- Fruit & vegetable garden.

The Picturesque suburb of Onkaparinga Hills with most properties being owner occupied. Close by you will find plenty of parks, for the family to enjoy, schools and only a short drive to The Southern Expressway, Colonnades Shopping Centre.

All floor plans, photos and text are for illustration purposes only and are not intended to be part of any contract. All measurements are approximate and details intended to be relied upon should be independently verified.

RLA 271071 RLA 269823

3 BED | 2 BATH | 2 CAR

PRICE:
\$595,000

OPEN FOR INSPECTION:
N/A



Tricia Kernahan
0457314206
tricia@atrealty.com.au
ffkrealstate.com.au
RLA: 269823

Approximate Internal Area - 187 SQM

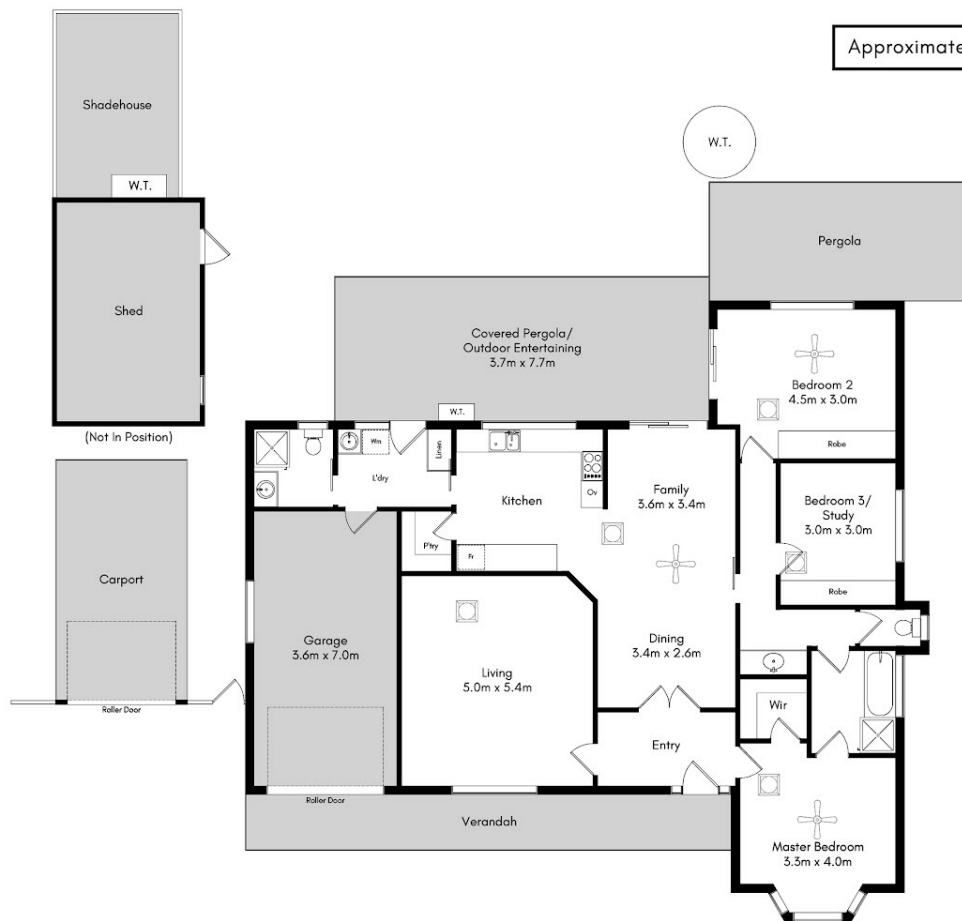

24 Richmond Grove Onkaparinga Hills

DISCLAIMER

This drawing is for illustration purposes only. The information contained is NOT intended to be part of any contract. All measurements are approximate and details intended to be relied upon should be independently verified. While every effort has been made to verify the correct details in this drawing, neither the agent, vendor or illustrator accept responsibility for any errors, omissions, or wrongful inclusions.

Disclaimer: Please note this floor plan is for marketing purposes and is to be used as a guide only. All dimensions are estimates only and may not be exact measurements.