



SOLD

STUNNING HOME WITH HIGH END FINISHES

Perfectly located amongst other executive homes, playgrounds, and an abundance of open parklands is this stunning ex display home in sort after North Harbour estate! situated on a 494m2 block with high end finishes and loads of yard space this home will suit a growing family or retiree looking for a home that is truly a step above!

From the moment you step inside you'll be blow away by the luxurious touches this home has! Boasting massive rooms and a sophisticated designs allowing areas flow effortlessly through the whole home, creating a warm homely feeling with a touch of exclusivity!

Features include

- 3 Large bedrooms with Built in robes
- study or potential 4th bedroom with built in robes
- Huge master bedroom with walk in robes and oversized ensuite!
- MASSIVE media room with built in bar area and raised platform for cinema couches
- Amazing kitchen with 40mm stone benchtops, mirrored splash back and butler's pantry
- 9ft ceilings with zoned ducted air-conditioning
- LED downlights throughout and smoke alarm compliant
- Epoxy flooring to the garage with new timber look roller door to be installed
- Security system throughout with camera
- Larger 494m2 corner block
- Premier CMA built home
- Minutes to Burpengary East shops, day-care, cafes, and doctors
- Minutes to highway access north and south bound
- Minutes to Proposed new Marina and new Shopping complex!
- 30 minutes to Brisbane Airport
- 45 minutes to Brisbane CBD
- 35 minutes to Caloundra beaches

A premier property like this doesn't come on the market long, never lived in and in fantastic condition this home is a rare find!! Call Paige today before you miss out!

3 BED | 2 BATH | 2 CAR

PRICE:
\$850,000

OPEN FOR INSPECTION:
N/A



Paige Crendon
0413402110
Crendonpropertygroup@gmail.com
www.atrealty.com.au

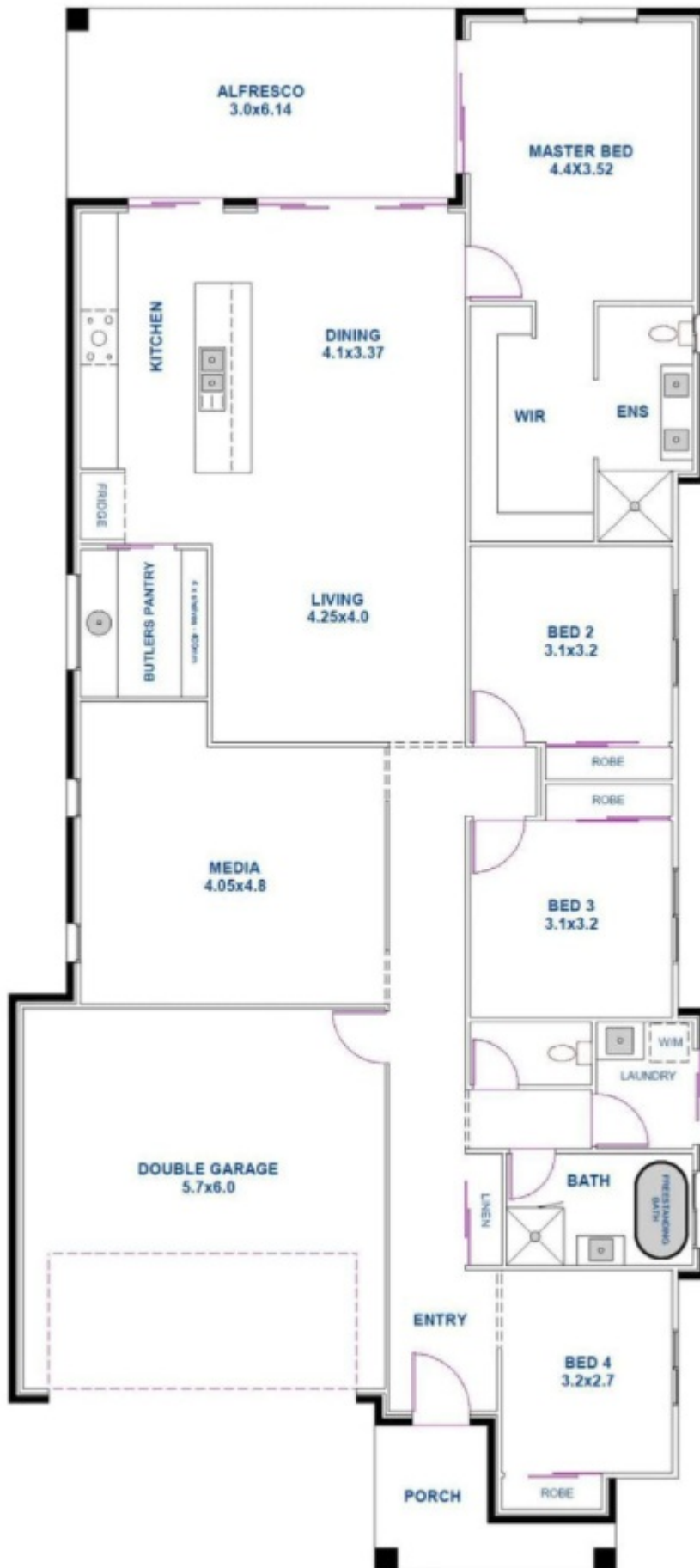

Disclaimer: Please note this floor plan is for marketing purposes and is to be used as a guide only. All dimensions are estimates only and may not be exact measurements.