

SOLD

LUXURIOUS APARTMENT IN THE HEART OF MELBOURNE!

****ONLINE AUCTION - BIDDING BY REGISTRATION ONLY WITH GRAYS ONLINE****

AUCTION OPENS SATURDAY 26th MARCH AT 1.00PM AND CLOSSES TUESDAY 29th MARCH AT 6.00PM

PLEASE CONTACT DAVID FALCONE 0413 116 717 TO REGISTER OR REGISTER VIA THE LINK <https://www.grays.com/lot/0001-7037276>

Conservatory Melbourne is an architectural masterpiece, it is one of the newest and most stunning and iconic buildings in the CBD.

Over 42 levels, it is designed to create a feeling of community and offers an incredible city living experience like no other.

Offering elegant and high end finishes throughout this near new apartment comprises:

- 2 spacious bedrooms with mirror built-in-robos
- Beautifully appointed kitchen with stone benchtops
- Open plan dining and living area
- Stunning bathroom
- European laundry

Residents will indulge in world class facilities, including a swimming pool, sundeck, gymnasium, sauna, steam room, entertainment deck, golf simulator and a private cinema.

Crowning the tower on level 42 is the residents observation skydeck with heated spas and breathtaking views.

Set among endless shopping, cafes, restaurants, bars, and entertainment, this apartment enjoys every convenience at your front door, with Melbourne Central, Emporium, trams, Carlton Gardens, Queen Vic Market and universities, all within easy reach.

2 BED | 1 BATH | 0 CAR

PRICE:
\$420,000

OPEN FOR INSPECTION:
N/A



David Falcone
0413116717
davidfalcone@atrealty.com.au
www.atrealty.com.au

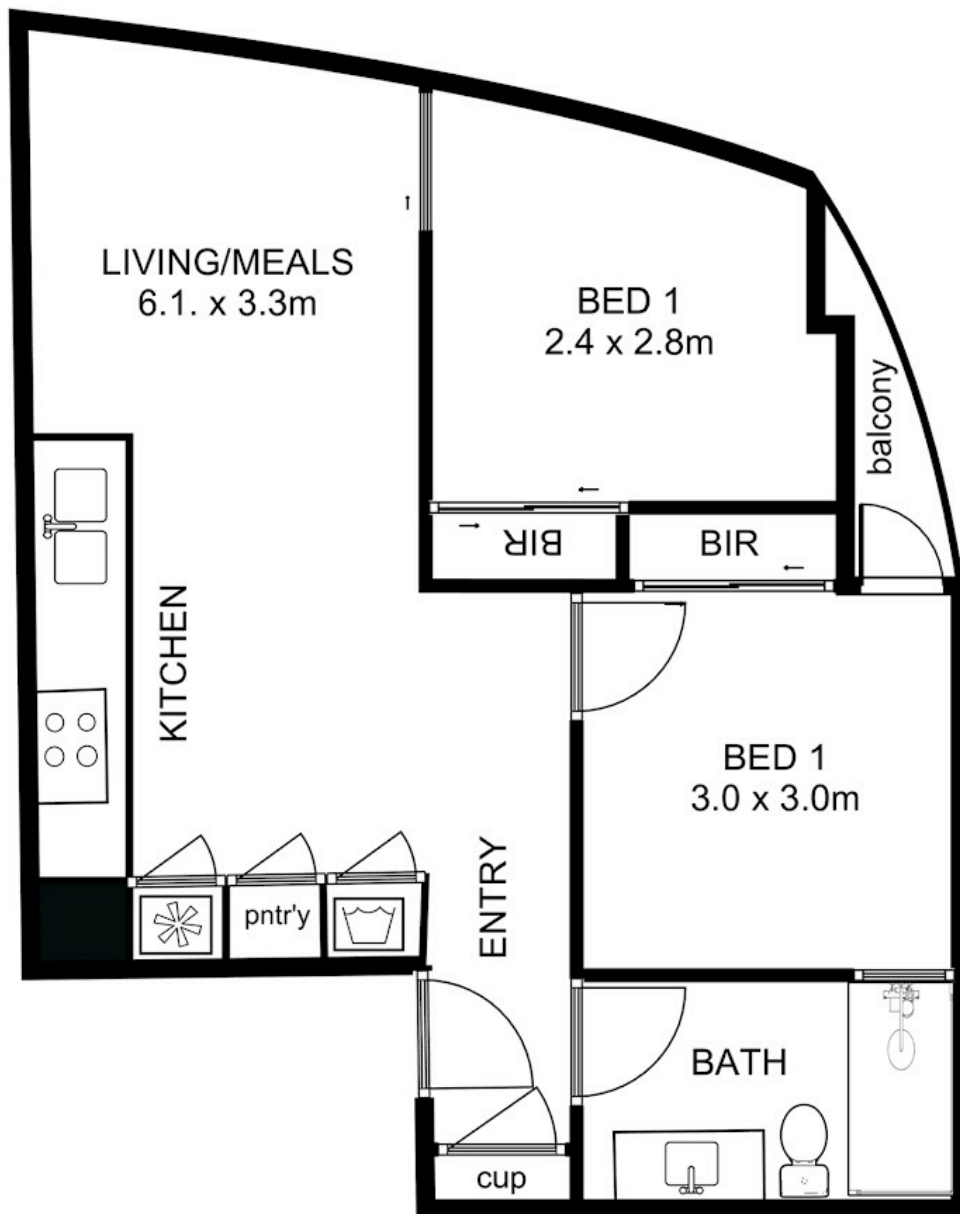

Disclaimer: Please note this floor plan is for marketing purposes and is to be used as a guide only. All dimensions are estimates only and may not be exact measurements.

David Falcone

Unit 612/9-23 Mackenzie St, Melbourne

davidfalcone@atrealty.com.au

While every attempt has been made to ensure the accuracy of the floor plan contained here, measurements of doors, windows, rooms and any other details are approximate and no responsibility is taken for any error, omission, or mis-statement. This plan is for illustrative purposes only and should be used as such by any prospective purchaser. The services, systems and appliances shown have not been tested and no guarantee as to their operability or efficiency can be given.

