



**SOLD**

## THIS FAMILY HOME WILL TAKE YOUR BREATH AWAY!

This Massive family home presented in immaculate condition on large block of 607sqm has a huge 315 sqm of total floor area and comes with heaps of features. Built in 2012 by Summit Homes, the smart design offers plenty of space and privacy for everyone, if your parents or older kids are living with you, this home is perfect for large and growing families.

Greeted with Gorgeous front porch, be wowed as you walk through the double door entrance and elegant hallway with high quality bamboo flooring and recessed ceiling with quality LED lighting.

The study is ideally located at the front of the house and is perfect for running your business from home, or could be used as a fifth bedroom, whilst the theatre room is large and spacious and is versatile in its use.

Featuring A very large open plan living dining area with ceiling fans and views of the outdoors. Ducted evaporative air conditioning throughout and heigh 32 course ceilings, timber floors and LED lights.

Modern stunning kitchen with plenty of bench tops space and breakfast bar, heaps of storage with soft closing cupboards and draws inside triple doors chef's Pantry, double draw Fisher & Paykel dishwasher, 900m Ariston oven and 6 burners stove top.

Serving Hatch from kitchen window into A perfectly finished outside entertaining area with outdoor kitchen under a huge Alfresco, a pizza oven, built-in seatings, decking area, planter boxes, and artificial grass.

Vey spacious and stylish laundry/scullery with linen staorage, tiled walls and access to outside.

All Bedrooms 2,3,4, are situated in a separate wing with a door separating them from the rest of the house, in addition to a very large storage room that could be a study with built-in shelves, a modern family bathroom and a powder room with separate toilet, plus linen storage. Bedroom 2 is King sized and Bedroom 3&4 are Queens, with double sliding BIRs, plantation shutters and lush carpets.

The Master bedroom is ideally located at the back for privacy, with fantastic views of the backyard and access to alfresco area through large sliding glass doors. His and Hers WIRs and

5 BED | 2 BATH | 2 CAR

PRICE:  
\$620,000

OPEN FOR INSPECTION:  
N/A



**Nadine Rofail**  
**0449011461**

nadine.rofail@atrealty.com.au  
[www.atrealty.com.au](http://www.atrealty.com.au)

Approximate Areas	
Living Area:	226.74m <sup>2</sup>
Porch:	5.88m <sup>2</sup>
Alfresco:	43.71m <sup>2</sup>
Garage:	38.76m <sup>2</sup>
Approx. Total:	315.09m <sup>2</sup>

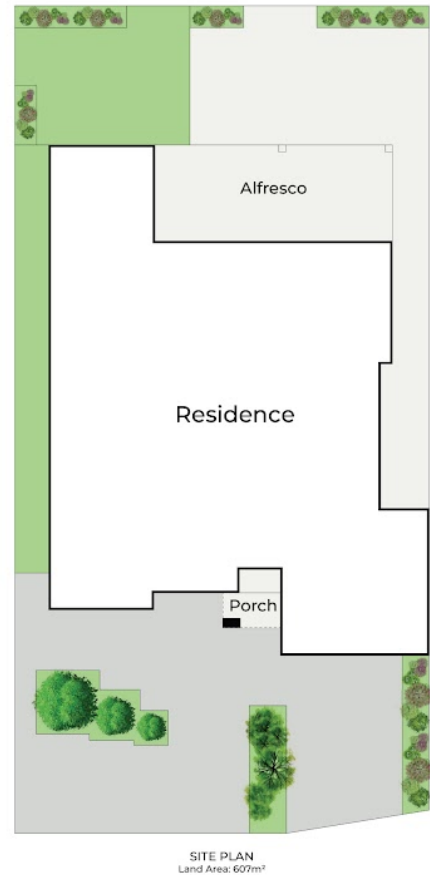

## 29 Alandale Bent Banksia Grove

Not to scale • All measurements are approximate • Drawn for presentation purposes only • [bookings@press-play.tv](mailto:bookings@press-play.tv)

Disclaimer: Please note this floor plan is for marketing purposes and is to be used as a guide only. All dimensions are estimates only and may not be exact measurements.