



SOLD

SINGLE LEVEL LIVING IN A PEACEFUL LOCATION

Embracing a peaceful easy-care lifestyle, on 696sqm of level land, this large family home beautifully maintained and presented, provides low maintenance living at its best. The family will love the versatile separate living spaces to retreat and relax. Having been a happy family home, the kids have grown up and it's time for the original owners to downsize.

- Ideal retreat for families of all ages or downsizers.
- Functional light-filled interiors, with neutral finishes throughout
- The sleek, modern kitchen will delight the family chef, offering ample storage and drawer space, gas cooktop, dishwasher and large pantry
- The generous sized family room flows from the kitchen and includes casual dining and living, opening through glass doors to a large covered alfresco deck and spa
- A second separate large versatile living and dining space over looks front garden and lawns
- Four spacious bedrooms all with built-in robes, the large master bedroom includes an ensuite and opens to the undercover deck.
- The family bathroom includes separate bath and shower plus separate WC
- Timber look floors, separate laundry, solar panels, watering system in front garden
- Child and pet safe level fenced rear lawn
- Double lock-up garage one side with rear access plus off-street parking for 2 cars. - For the caravan or boat owner, a designated off-street parking bay
- Large reserve with children's playground within a minute's walk
- Within level easy walking distance to the local shopping centre, school and public transport

4 BED | 2 BATH | 2 CAR

PRICE:
\$2,150,000

OPEN FOR INSPECTION:
N/A



Karen Turner
0424755448

karen@turnercullenproperty.com.au
turnercullenproperty.com.au

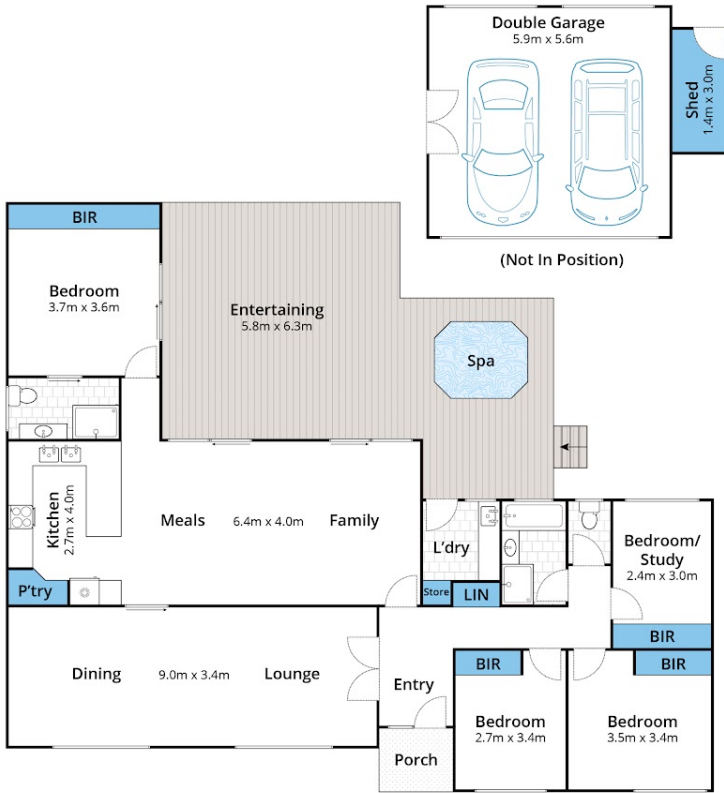

Ground Floor

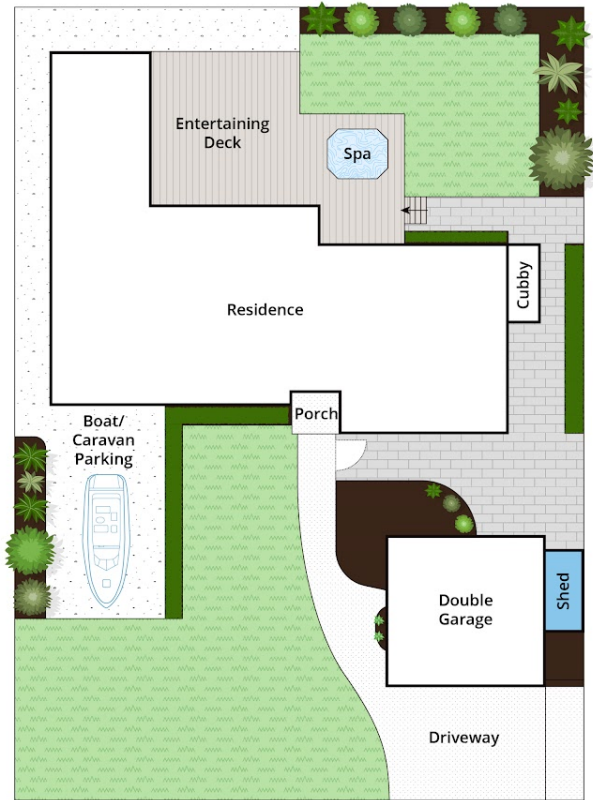

Site Plan

Whilst bwrn.com.au has made every attempt to ensure the accuracy of the floor plan contained here, measurements are approximate and no responsibility is taken for any error, omission, or mis-statement. This plan is for illustrative purposes only.

12 Angorra Road, Terrey Hills

Disclaimer: Please note this floor plan is for marketing purposes and is to be used as a guide only. All dimensions are estimates only and may not be exact measurements.