

**SOLD**

## BEAUTIFULLY PRESENTED MODERN TOWNHOUSE!

This two-bedroom modern town-home is certain to impress those who are seeking either their first home, downsizing or investment.

The home comprises of high ceilings, spacious master bedroom with wardrobe, another bedroom with built-in wardrobes serviced by spacious central bathroom. Modern kitchen overlooking meals & family area with stone bench top equipped with stainless steel appliances. Split system heating & cooling to make sure you feel comfortable all year around.

Other features include:- down lights throughout, quality window furnishings, plenty of storage, modern pull out low maintenance backyard and remote controlled garage.

Situated in the popular "The Grove Estate" with all the amenities close by, Tarneit medical centre, child care, parklands, Tarneit west shopping centre, riverdale village shopping centre, public transport & Tarneit train station!

Currently leased until July 2022 for \$1,434.00 per month.

Call Joseph Hanna on 0423 966 320 to arrange your inspection today!

**2 BED | 1 BATH | 1 CAR**

**PRICE:**  
**\$415,000**

**OPEN FOR INSPECTION:**  
**N/A**



**Joseph Hanna**  
**0423966320**  
joseph@atrealty.com.au  
[www.atrealty.com.au](http://www.atrealty.com.au)

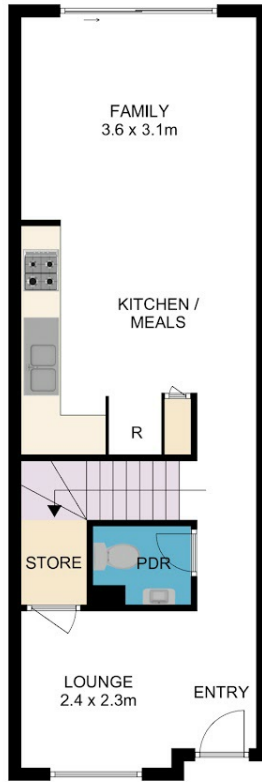
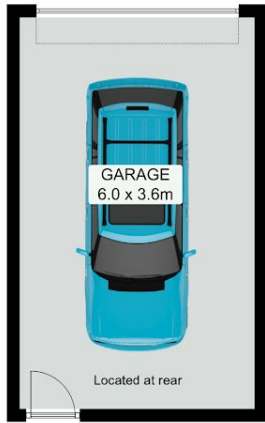

Ground Floor

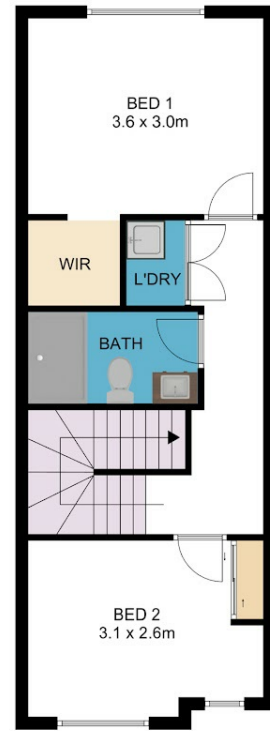

First Floor

**86 Connaught Road, Tarneit**



Whilst every attempt has been made to ensure the accuracy of the floor plan contained here, measurements of doors, windows, rooms and any other items are approximate and no responsibility is taken for any error, omission, or mis-statement. This plan is for illustrative purposes only and should be used as such by any prospective purchaser. The services, systems and appliances shown have not been tested and no guarantee as to their operability or efficiency can be given.



Disclaimer: Please note this floor plan is for marketing purposes and is to be used as a guide only. All dimensions are estimates only and may not be exact measurements.