

936 CENTRE ROAD, BENTLEIGH EAST, VIC, 3165



**SOLD**

**SOLD SOLD SOLD BY VIET HA \$1,050,000**

Cherished Family Charm with Appealing Future Options

Offers Close: Tuesday 5th April by 6:00pm (unless sold prior)

Land size 584 m2 Approx.

VIET HA Selling Expert Property Group is pleased to present this lovely house, which will appeal to both first-time buyers, investors or own business. This is your chance to own an impeccable, turn-key house in Bentleigh East. Every imaginable inclusion has been considered to guarantee that this home gives an easy and comfortable lifestyle

On 584 m2 Approx. of land a picture of pride in beautiful, the generous dimensions certainly present a firm foundation for you to explore either a multi-unit development, luxury new home build or contemporary renovation (STCA). The home itself is superb! Prestigiously positioned in Bentleigh East. It is in a premium position and you are bound to fall in love with it! It's the ideal time to pounce on this superb piece of land, and all the potential it holds to boost your property portfolio.

Like a breath of fresh air, is large enough for the biggest of families, while having the flexibility for future development (STCA). Inside you have an open living with dining. Set to impress your friends, the alfresco deck is ideal for entertaining with family and friends and overlooks a smartly landscaped backyard where children can play. This is a great unit that offers a huge amount of potential in a fast-growing suburb

Move in or lease out temporarily whilst considering future plans, with comfortable 3-bedroom, 1-bathroom spaces offering; an L-shaped lounge/dining area with gas heating, spacious kitchen, good-sized back yard & storage shed.

Property features include:

- Timber floorboards
- Chic designer floor to ceiling tiled bathrooms
- Ground floor 2.5m high ceiling
- Chic designer floor to ceiling tiled bathrooms

**3 BED | 1 BATH | 3 CAR**

PRICE:  
**\$1,050,000**

OPEN FOR INSPECTION:  
N/A



**Viet Ha**  
**0406246384**  
viet@vietha.com.au  
vietha.com.au

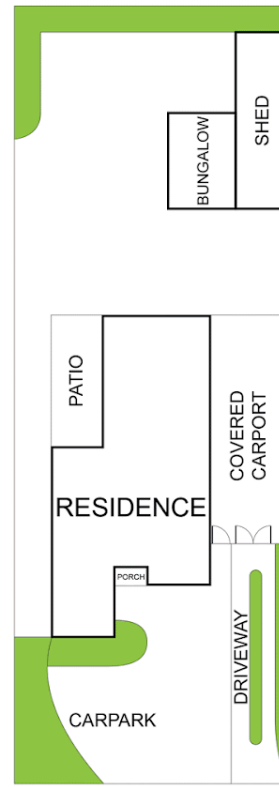
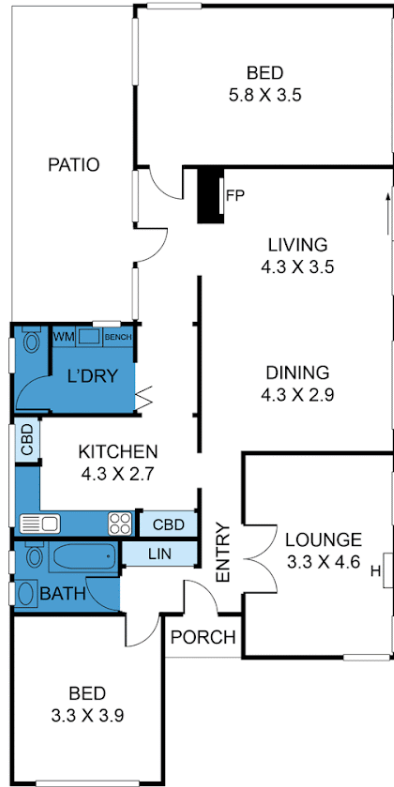

Springvale

## 936 Centre Road, Bentleigh East

Disclaimer: This floor plan is for illustration purposes only and no warranty is given to its accuracy. Purchasers are advised to carry out their investigations. produced by [www.realpixiephotography.com.au](http://www.realpixiephotography.com.au)



Disclaimer: Please note this floor plan is for marketing purposes and is to be used as a guide only. All dimensions are estimates only and may not be exact measurements.

Viet Ha  
 0406246384  
 viet@vietha.com.au  
 vietha.com.au

