



FOR SALE

PERFECT INVERLOCH LOCATION - QUALITY BUILD

For sale by Openn Negotiation (Online auction with flexible terms) Contact the agent ASAP to register and qualify to avoid missing out.

Why not enjoy all the benefits of low maintenance coastal living in this outstanding four bedroom home built by Beach House Constructions. Woodland Heath Drive has always been a much sought after Inverloch location, being only minutes from the beach and town centre it is easy to understand why. This impressive Inverloch home has much to offer the astute buyer with a North facing deck and lots of double glazed windows, it is flooded with natural light.

On the ground level is a large kitchen/dining/living area with high ceilings, and sliding doors opening out onto the sun deck giving an immediate feeling of space and light. The impressive kitchen has stone bench tops, and custom cabinetry throughout and storage galore. Uniquely, the extremely spacious master bedroom is also located on the ground floor, complete with walk in robe and a beautifully tiled ensuite bathroom. Upstairs provides another living area and three more double bedrooms all with built in robes and a family bathroom perfect for the extended family visits you are sure to have if you are lucky enough to call 98 Woodland Heath Drive home.

The property is beautifully finished with hardwood flooring, floor to ceiling tiling and custom vanities. A full compliment of custom blinds coupled with remote exterior shutters that grace the double glazed windows. A year round water supply is provided by three 5000L water tanks with filters and mains back up.

There's a lot to love here and early inspection is highly recommended.

4 BED | 2 BATH | 2 CAR

PRICE:
Just Listed

OPEN FOR INSPECTION:
N/A



Leo Edwards
0472523445
leo@atrealty.com.au
www.atrealty.com.au

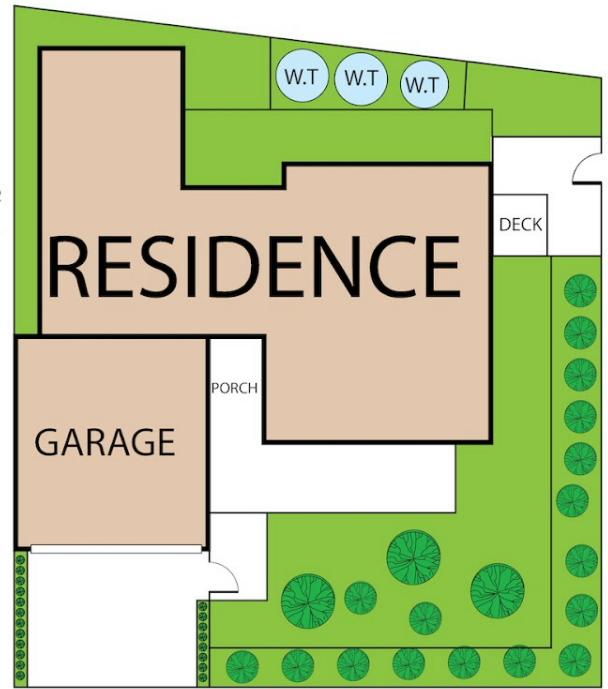

98 Woodland Heath Drive, Inverloch 3996

TOTAL APPROX. FLOOR AREA 194 SQ.M

Whilst every attempt has been made to ensure the accuracy of the floor plan contained here, measurements of doors, windows, rooms and any other items are approximate and no responsibility is taken for any error, omission, or misstatement. This plan is for illustrative purposes only and should be used as such by any prospective purchaser.

INVERLOCH
REALTY
@realty

Disclaimer: Please note this floor plan is for marketing purposes and is to be used as a guide only. All dimensions are estimates only and may not be exact measurements.