



SOLD

SOLD! SUPERB FAMILY HOME WITH DECK AND POOL!

SOLD!

Ladies and gentlemen, we are excited to present this fantastic lifestyle and investment opportunity!

Situated on a large and level 701m2 block in sought-after Capalaba is this quality high-set family home!

Nestled in a quiet & elevated location, this home is only a short stroll or quick drive to all local amenities.

The home features spacious lounge and dining areas, beautiful timber floors, and a stone-bench kitchen.

The upstairs living areas are air-conditioned, and the home has attractive plantation shutters throughout.

There are 3 bedrooms upstairs + an additional rumpus area down, and scope for full dual-living if desired.

Outside features a large, private deck, the perfect space to entertain, or enjoy fresh breezes and a coffee.

Downstairs also includes the double garage, the laundry and a "cat-friendly" outdoor area below the deck.

The manicured back yard area features the sparkling in-ground swimming pool as well as a storage shed.

The presentation of the yards and gardens is immaculate, and there's ample space for a carport out front.

3 BED | 1 BATH | 2 CAR

PRICE:
\$822,500

OPEN FOR INSPECTION:
N/A



Ben Tafolo
0419260719
tafolo@atrealty.com.au
tafolorealty.com.au

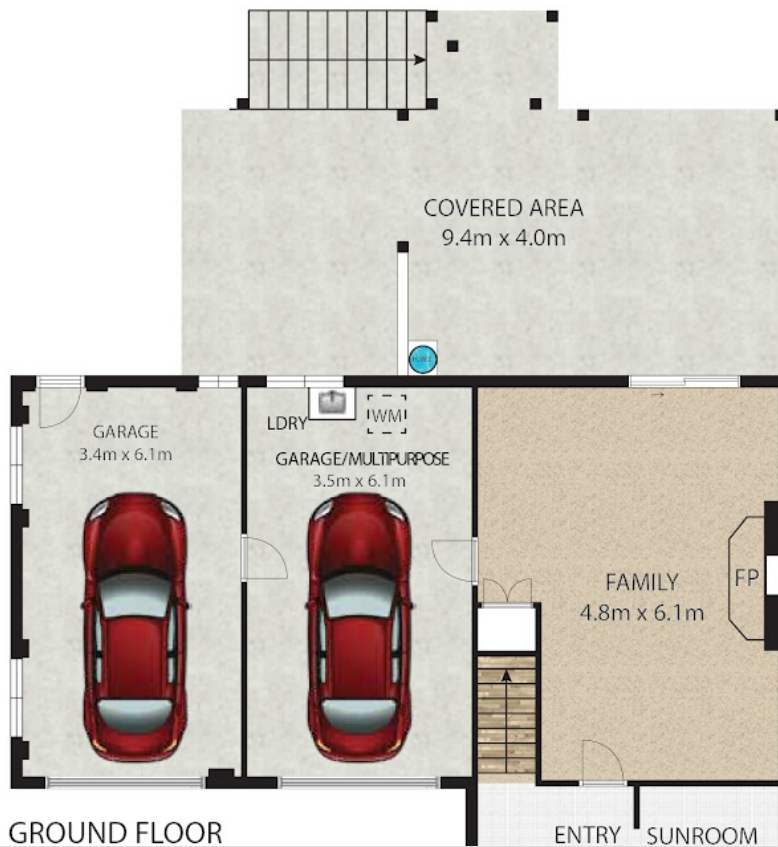

Disclaimer: Please note this floor plan is for marketing purposes and is to be used as a guide only. All dimensions are estimates only and may not be exact measurements.

97 Killarney Crescent, Capalaba 4157
TOTAL APPROX. FLOOR AREA 157 SQ.M

Ben Tafolo has made every effort to ensure the accuracy of the floor plan contained here, measurements of doors, windows, rooms and any other items are approximate and no responsibility is taken for any error, omission, or misstatement. This floor plan is for illustrative purposes only and should be used as such by any prospective purchaser.

tafolo@atrealty.com.au
tafolorealty.com.au