



# Sold

## ARE YOU DREAMING OF A TREE CHANGE CLOSE TO TOWN AMENITIES?

3 BED | 1 BATH | 2 CAR

10 Raspberry Lane, Curra, QLD, 4570

Originally purchased by the current owner's grandfather in 1912, this extraordinary 42.55 hectare (105 acres) property is a mere 17-minute drive to Gympie.

Defined by environmental wonder entailing varying and enveloping green and bucolic vistas from multiple vantage points, a property of incomparable natural beauty and an unrivaled ability to support an idyllic lifestyle is often sought but rarely found.

A cute, renovated three-bedroom cottage is elevated on a cleared expanse of rolling lawn backdropped by remote bushland. The house has recently been repainted, a new roof fitted and new aluminium windows and security installed.

Spend blissful evenings on the large front deck where the only noise is that of nocturnal wildlife, or start the day, coffee in hand, and revel in the rural serenity. Internally, the air-conditioned, tiled living room, family room and eat-in kitchen flow one to the other, culminating in a rear undercover outdoor entertaining area and patio.

Warming those cold winter nights is a wood-burning, potbelly fireplace in the kitchen. Other features include an electric stove and a water filter connected

PRICE:  
\$900,000

OPEN FOR INSPECTION:  
N/A



**Greg Pratt**  
**0413 624 308**  
greg@coastaledgerealestate.com.au

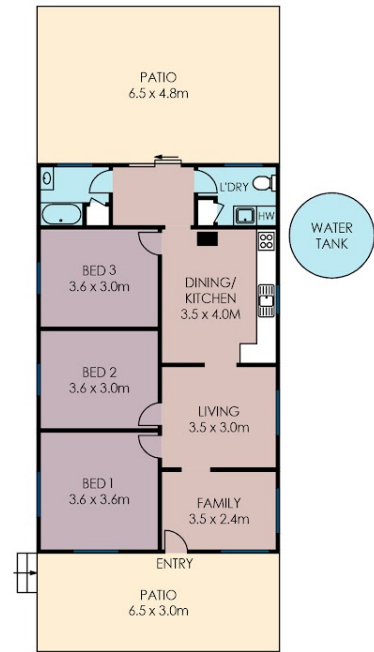
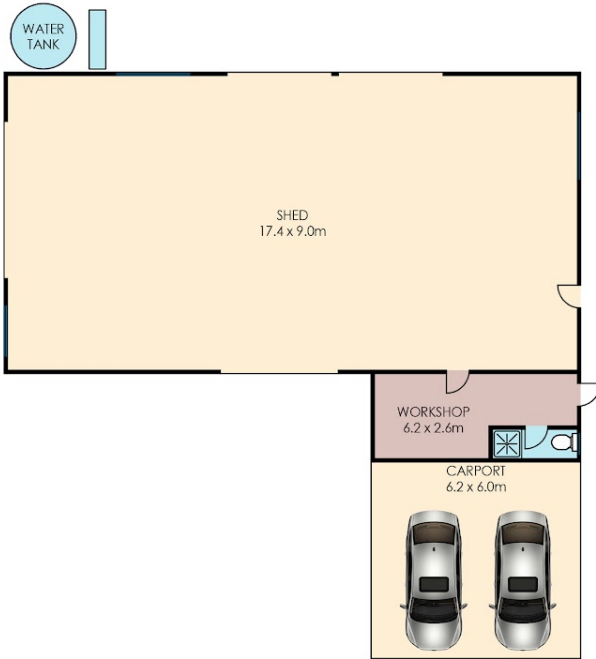

ARTIST IMPRESSION ONLY: While every attempt has been made to ensure the accuracy of this floor plan's areas and measurements of doors, windows, rooms and all other items are approximate and no responsibility is taken for any error, omission, or misstatement. This plan is for illustrative purposes only and should only be used as such by any prospective purchaser. [www.fratterphoto.com](http://www.fratterphoto.com)

### 10 Raspberry Lane, CURRA

**HOUSE**  
 INTERNAL : 82m<sup>2</sup>  
 EXTERNAL : 52m<sup>2</sup>  
 TOTAL : 134m<sup>2</sup>

**SHED**  
 INTERNAL : 139m<sup>2</sup>  
 EXTERNAL : 36m<sup>2</sup>  
 TOTAL : 175m<sup>2</sup>

