

**SOLD**

## INVESTORS TAKE NOTE "LOCATION LOCATION" "UNDER CONTRACT"

"Rental appraisal \$390.00 to \$420.00 per week"

This family home is on the market for the first time in 36 years. It's conveniently located, close to schools, public transport, and shops.

Add this family home to your shopping list! It's a fantastic opportunity to secure a sought-after highset home at entry-level, it is rare to find and won't last long.

Upper-level consists of an open plan layout that incorporates the living, dining, and renovated kitchen areas. This creates a great sense of space and allows for plenty of natural light in the home. With 3 good size bedrooms, (main with B/Ins, ceiling fans and box A/C. Renovated bathroom with walk-in shower.

Downstairs currently have a double lock-up garage, workshop, and bar that leads out to a private entertainment area out the back overlooking your low-maintenance backyard.

More benefits to this family home!

3 good size bedrooms

Lounge dining combined

Renovated kitchen

Renovated bathroom with walk-in shower

Workshop with bar

Covered entertainment area

2 car garage with toilet and laundry

Singles carport (plus extra car space) access to the backyard,

Fenced 607m2 Block with garden sheds and water tank

Walking distance to schools, local shops, and public transport.

Please call Mark Perera for further information on 0417199875

Disclaimer: The information provided has been obtained in good faith and is to be used as a guide only. @realty nor the acting agent/s provide any guarantees, undertakings or warnings as to the accuracy, completeness or up-to-date nature of the information provided by the Vendor or other Persons. We urge all interested parties to undertake their own due diligence independent in determining whether or not this information is in fact accurate. The website may have filtered the property into a price bracket for website functionality purposes

3 BED | 1 BATH | 3 CAR

PRICE:  
\$370,000

OPEN FOR INSPECTION:  
N/A



**Mark Perera**  
**0417199875**

markperera@atrealty.com.au

[www.atrealty.com.au](http://www.atrealty.com.au)

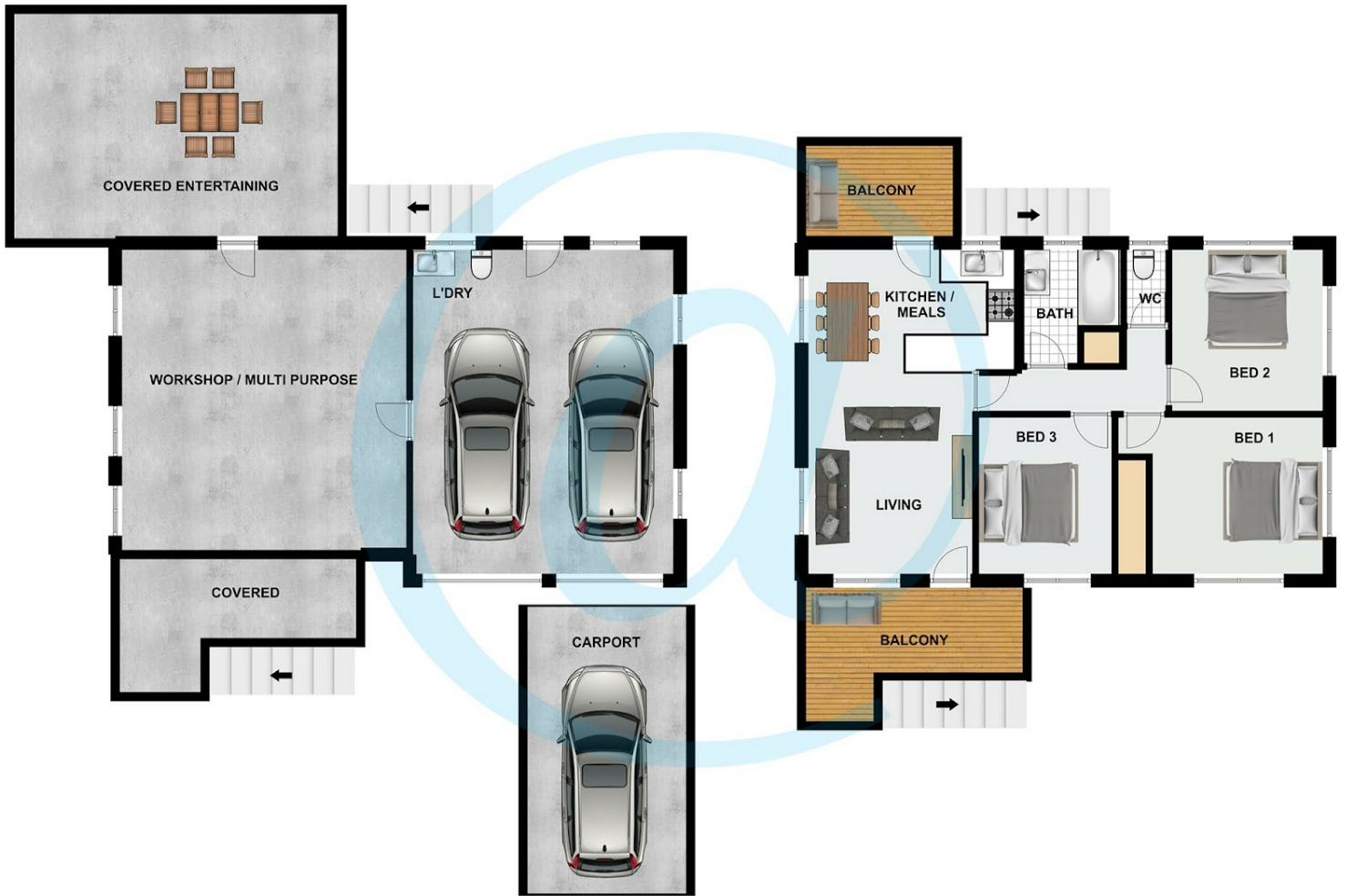

Disclaimer: Please note this floor plan is for marketing purposes and is to be used as a guide only. All dimensions are estimates only and may not be exact measurements.