



## FOR SALE

### GREAT INVESTMENT / GREAT LOCATION - SHOW QUALITY - LUXURY LIVING IN GROUP OF 7

Whether you want to move in or add this treasure to your investment portfolio, you will find this location is conveniently situated between Adelaide CBD and our beautiful beaches giving you the best of both worlds.

Built in 2000, this beautifully kept and much loved home has been with the same owner ever since and the current tenants have been there for 19 years. If it is an investment you want, the tenants are keen to stay. Tenant is a professional landscaper who takes enormous pride in the courtyard and flower boxes and the inside is spotless and cared for.

Highlights of the Home:

2 spacious bedrooms (plan was for 3, however changed to 2 to have more living area). Can be made into 3.

Fully insulated walls & ceilings (this is a huge benefit)

Spacious 2 way bathroom with shower and bath (tiled up to ceiling)

Open plan living/dining area

Reverse cycle air conditioning

Spacious kitchen with island bench

Gas cooktop with electric oven

Separate laundry leading to 2nd toilet

Garage parking with internal access

Private rear courtyard

Ceiling fans to bedrooms

Vertical blinds to windows

Plumbing and electrical updated by professionals

Downlights throughout

RLA 269823

2 BED | 1 BATH | 1 CAR

PRICE:

\$550,000 - \$565,000

OPEN FOR INSPECTION:

N/A



**Trevor Lambert**

**0412396306**

trevor@atrealty.com.au

[www.atrealty.com.au](http://www.atrealty.com.au)

RLA: 269823

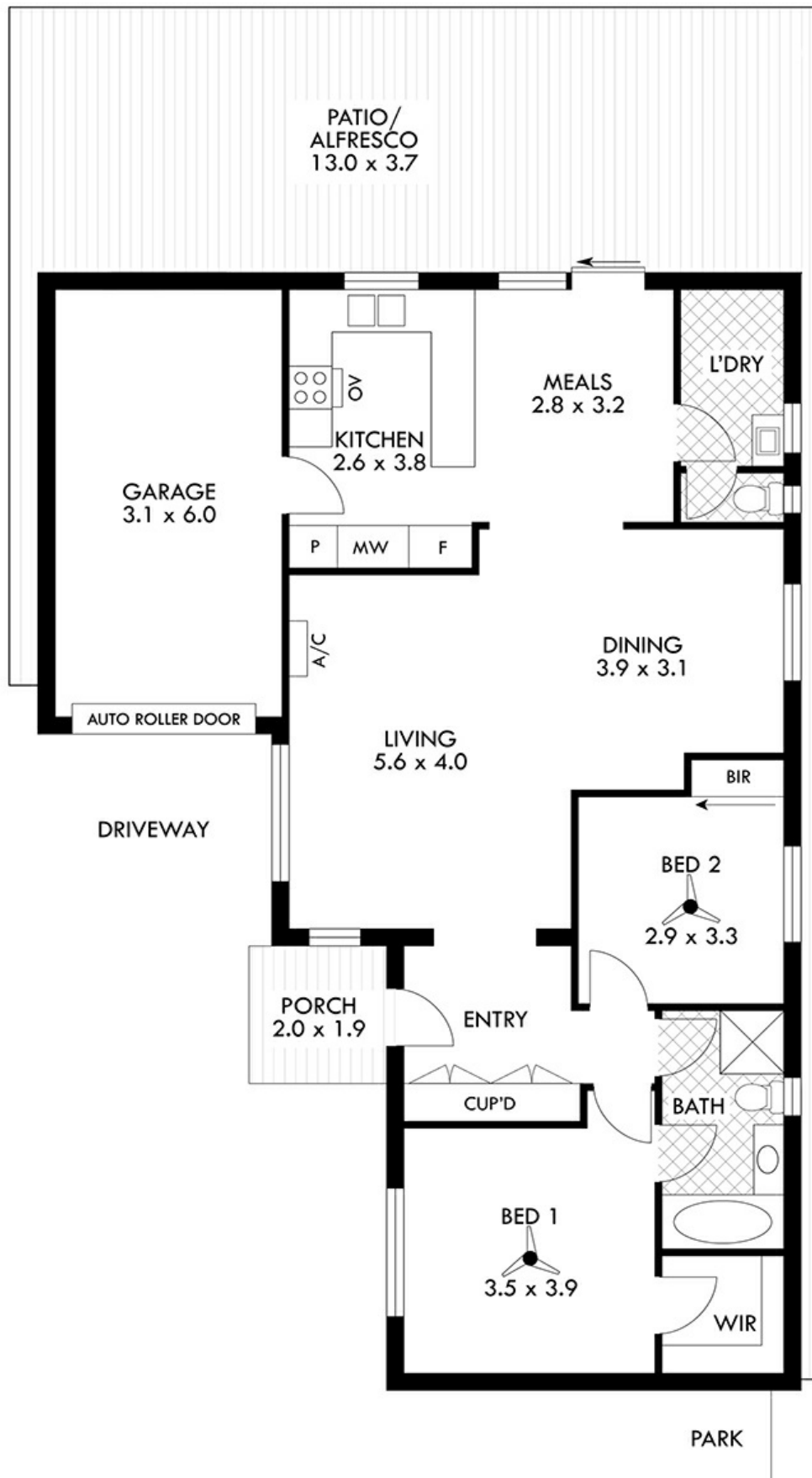

Disclaimer: Please note this floor plan is for marketing purposes and is to be used as a guide only. All dimensions are estimates only and may not be exact measurements.

TOTAL AREA - 183 sqm approx

approximate and details intended to be relied upon should be independently verified.

7/37 Mooringe Avenue, Plympton

Trevor Lambert

0412396306

trevor@atrealty.com.au

[www.atrealty.com.au](http://www.atrealty.com.au)

@realty